

IMI TA

TA-Slider 160 BACnet TA-Slider 160 Modbus

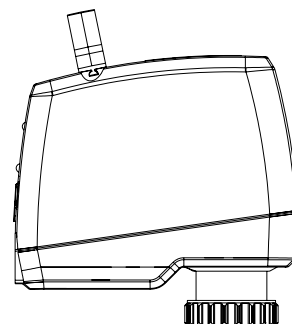

0°C - +50°C

32°F - +122°F

(5-95%RH, non-condensing)



0°C - +120°C

32°F - +248°F



-20°C - +70°C

-4°F - +158°F

(5-95%RH, non-condensing)

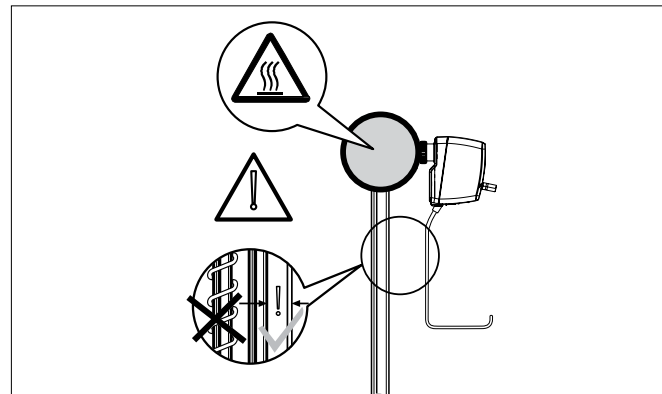
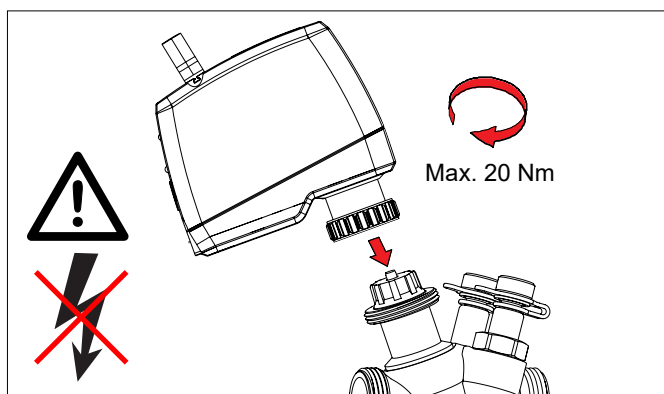
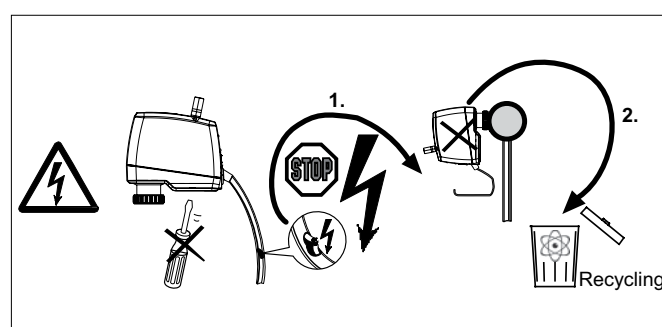
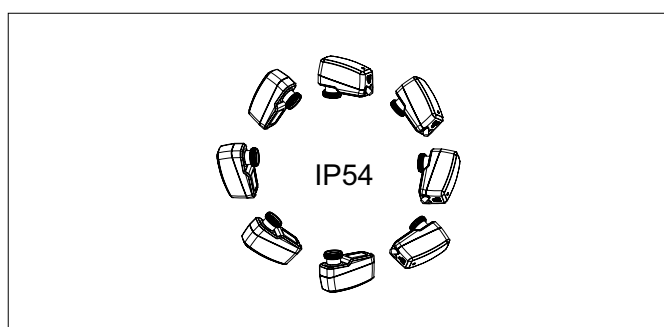
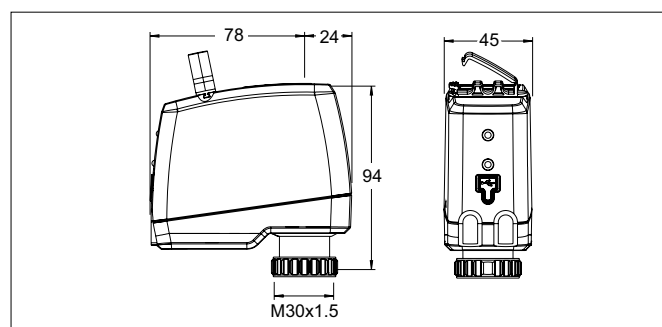

TA-Slider 160 BACnet/Modbus

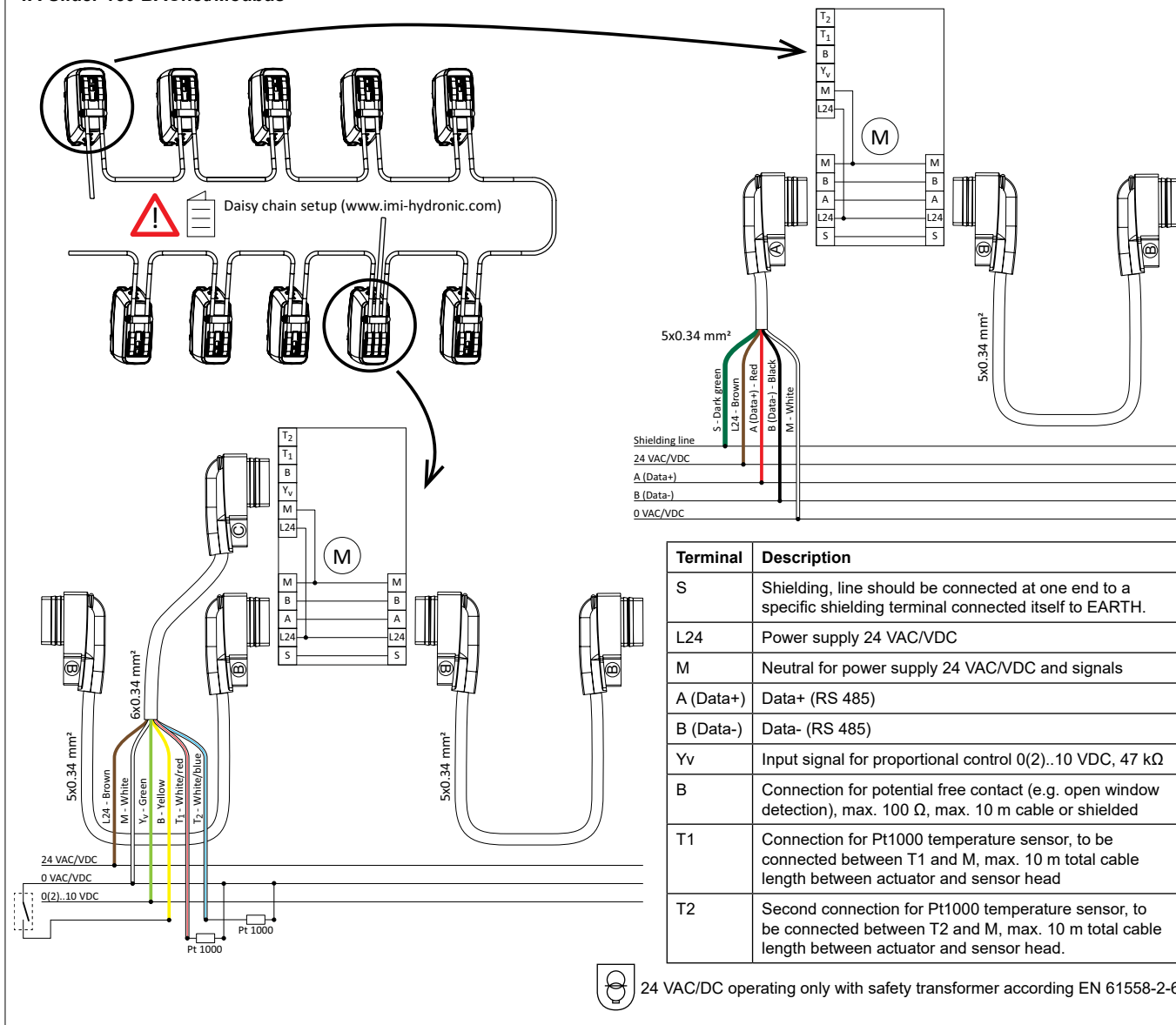

Quick start

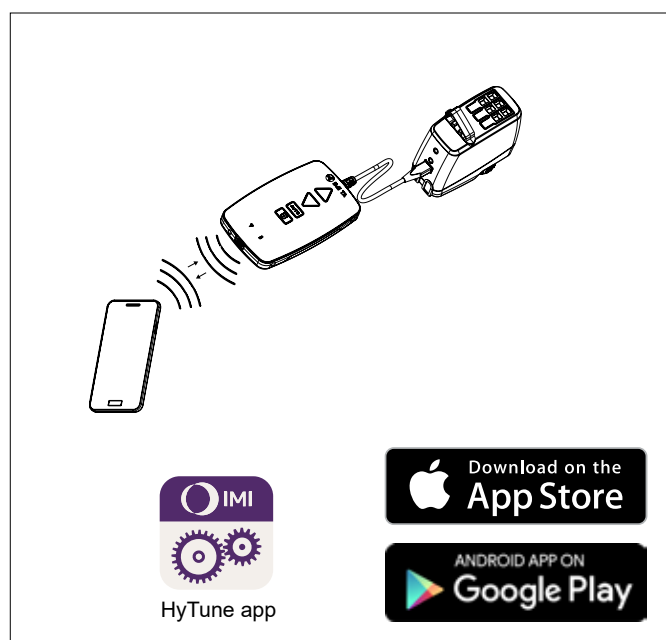

LED

LED	Symbol	Meaning
BLUE/RED		Change of network configuration or board starting
		Message received
		Ready - Waiting for messages
		Error
		Power supply
VIOLET		Proportional control
		Potential free contact
		Open window detection
		Temperature sensor
		Temperature sensor

Bus LED	Meaning
Red	Change of network configuration or board starting
Orange	Message received
Green	Ready - Waiting for messages