

IMI TA

TA-Slider 160 BACnet CO TA-Slider 160 Modbus CO

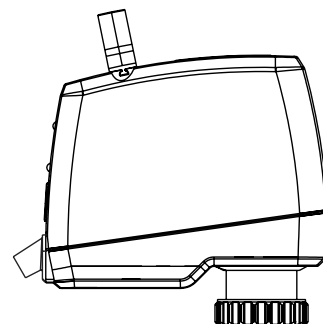

0°C - +50°C

32°F - +122°F

(5-95%RH, non-condensing)



0°C - +120°C

32°F - +248°F



-20°C - +70°C

-4°F - +158°F

(5-95%RH, non-condensing)

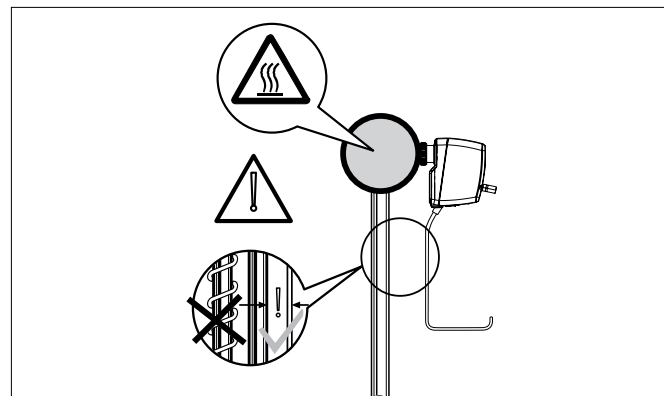
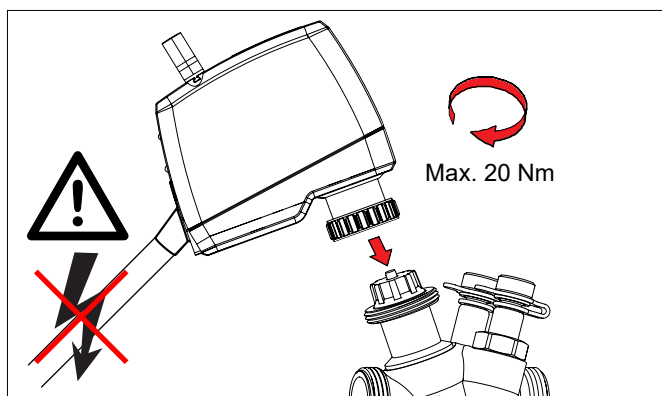
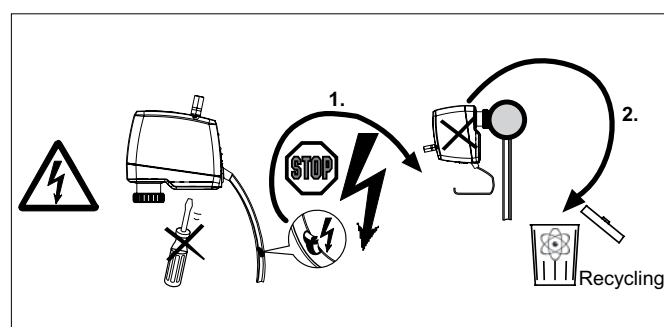
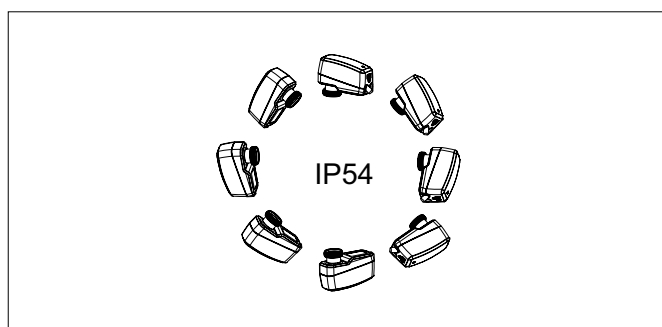
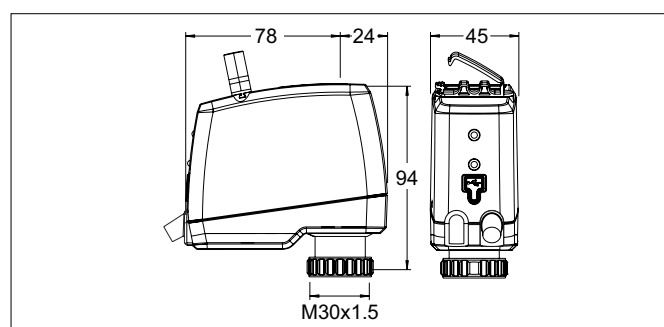

TA-Slider 160 BACnet CO/Modbus CO

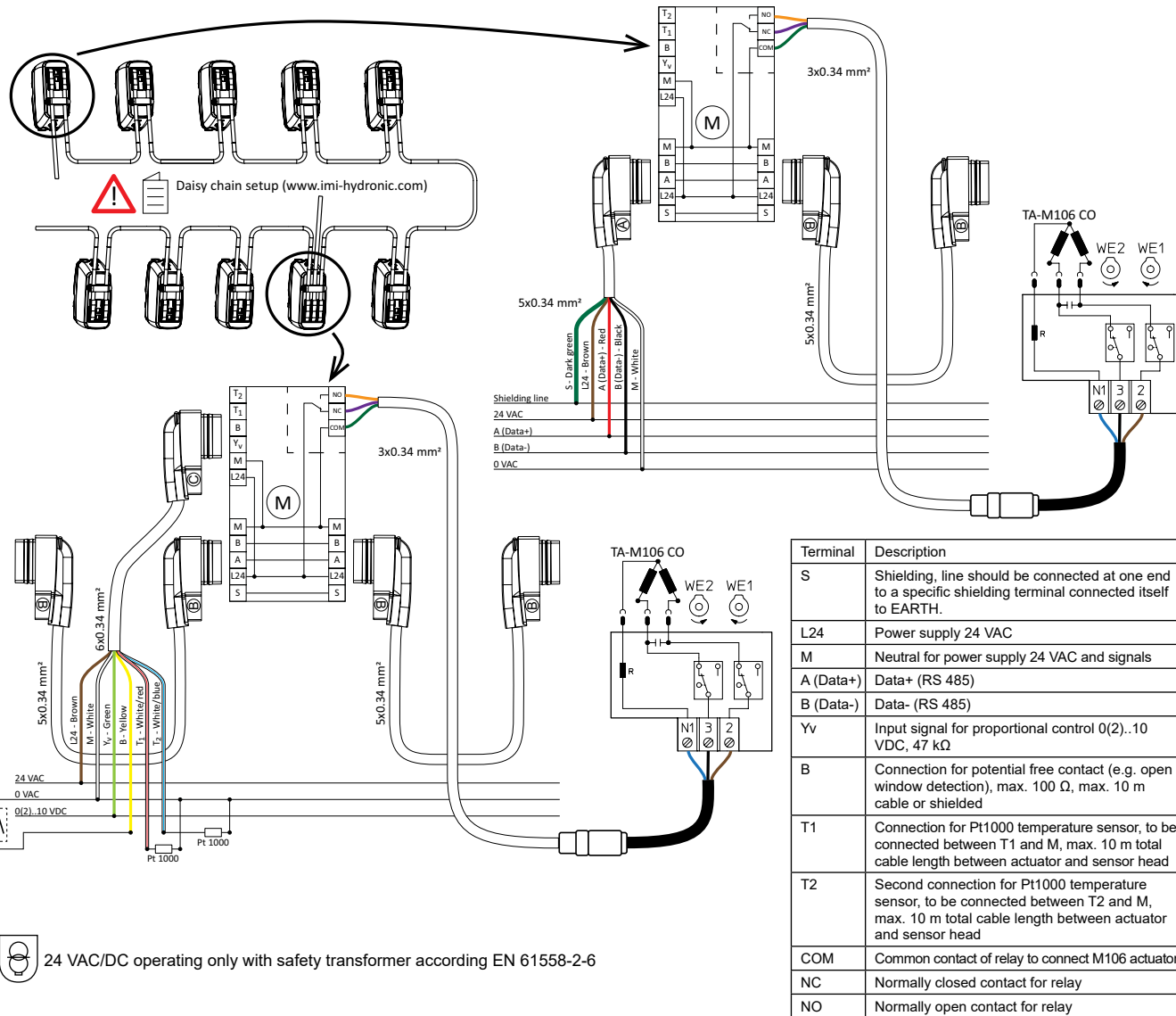

Quick start

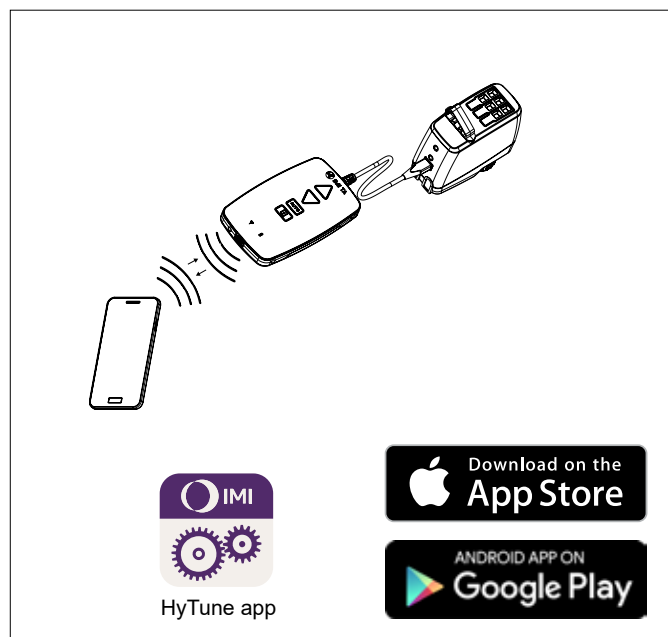

LED

