

311 255-01
11.2024



IMI TA

TA-Modulator

DN 40-50

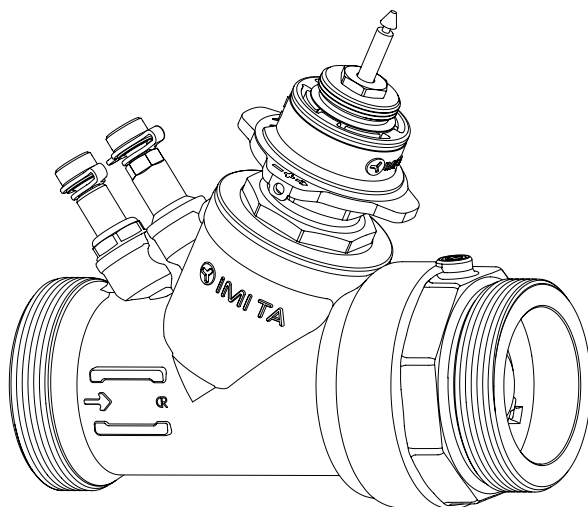

-20°C – +120°C (-4°F – +248°F)

PN 16 (230 psi)

ΔpV_{\max} : 400 kPa = 4 bar (58 psi)

ΔpV_{\min} : 30 kPa = 0,30 bar (4.35 psi)

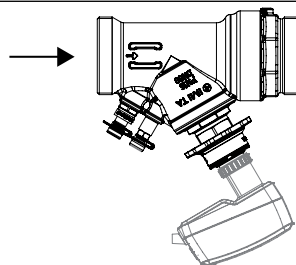

Pos	q_{\max}			
	DN 40 [l/h]	1 1/2" [US gpm]	DN 50 [l/h]	2" [US gpm]
0.8	1000	4.40	2150	9.46
0.9	1240	5.46	2640	11.62
1.0	1530	6.73	3220	14.17
1.1	1840	8.10	3790	16.68
1.2	2200	9.68	4430	19.49
1.3	2570	11.31	5150	22.7
1.4	3020	13.29	5990	26.4
1.5	3450	15.18	6870	30.2
1.6	3960	17.42	7800	34.3
1.7	4550	20.0	8790	38.7
1.8	5200	22.9	9740	42.9
1.9	5800	25.5	10600	46.7
2.0	6500	28.6	11200	49.3

$q_{\max} =$

- l/h (US gpm) at each pre-setting and fully open valve plug.
- l/h bei der jeweiligen Voreinstellung und voll geöffnetem Regelkegel.
- l/h pour chaque pré-réglage, la cône de la vanne étant complètement ouverte.
- l/h van elke voorinstelstand en volledig geopende afsluiterkegel.
- l/h para cada preajuste, estando el obturador en la posición totalmente abierta.
- l/h em cada posição de pré-ajuste e o disco da válvula totalmente aberto.
- l/h con ogni pre-impostazioni e con la valvola completamente aperta.
- л/ч для каждой преднастройки и полностью открытом клапане.
- l/h az egyes előbeállításkor és teljesen nyitott szeleptányérnál.
- l/h dla każdej nastawy i w pełni otwartego trzpienia zaworu.

TA-Slider 500

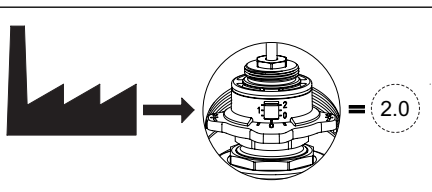
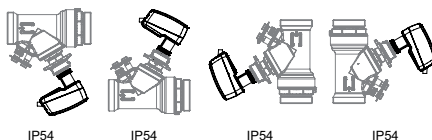

- l/h pro každý stupeň přednastavení při zcela otevřeném regulačním kuželce.
- l/hod pri danom prednastavení a plne otvorenej regulačnej kúželke.
- l/h pri dani prednastavitvi in popolnoma odprtem vretenu ventila.
- l/h pentru fiecare presetare si vana complet deschisa.
- l/h pri svakom prednamještanju i potpuno otvorenom ventilu.
- l/h на свакој пред-подешеној позицији и потпуну отвореном вентилу.
- l/h reguleerosa täiesti avatud asendis vastavalt eelseadearvule.
- l/h katram iepriekšiestatījumam un pilnībā atvērtam vārstam.
- l/h prie kiekvienos nustatymo padėties esant pilnai atidarytam vožtuvui.
- l/h vid respektive förinställning och fullt öppen ventilkägla.
- l/h ved angitt forinnstilling og fullt åpen ventilkjegle.
- l/h kyseisellä esisäätöarvolla venttiilikara täysin auki.
- l/h ved respektiv forindstilling og fuldt åben ventileggle.

TA-Modulator + TA-Slider 500

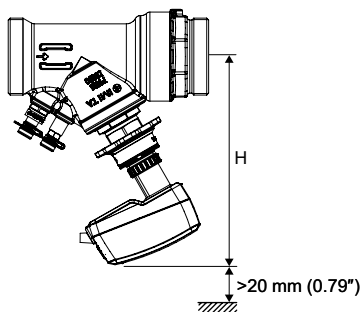

DN	H [mm]	
	TA-Slider 500	TA-Slider 500 Plus
40	203	212
50	206	215

Size	H [in]	
	TA-Slider 500	TA-Slider 500 Plus
1 1/2"	7.99	8.35
2"	8.11	8.46

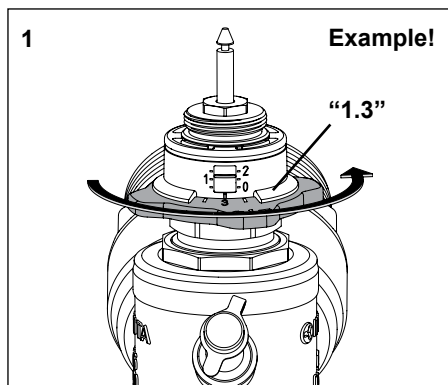
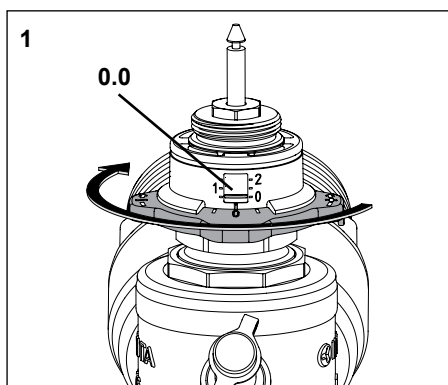
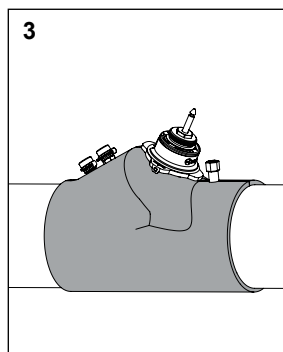
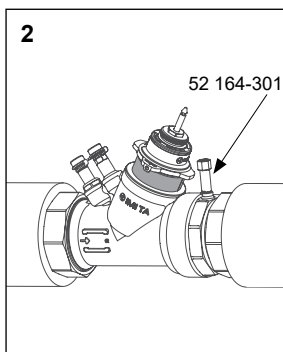
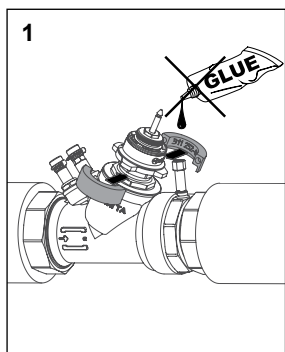

q

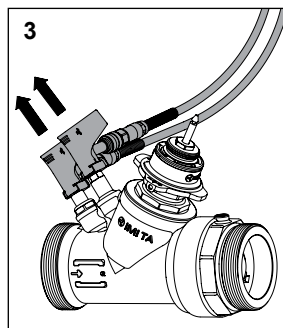
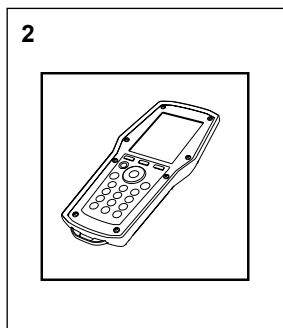
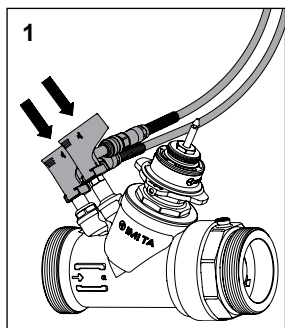



ΔH

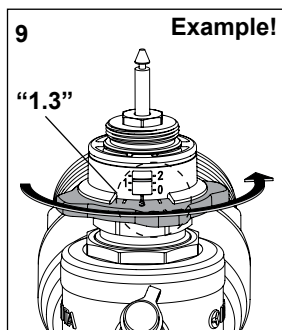
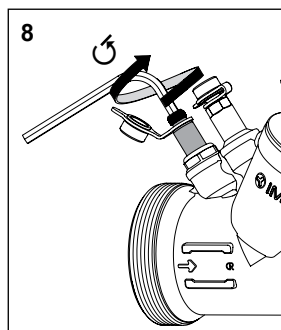
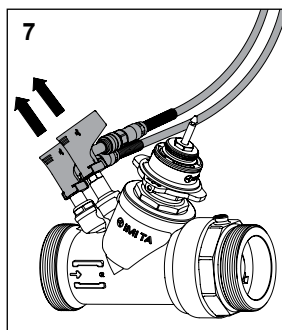
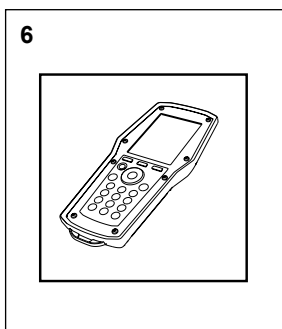
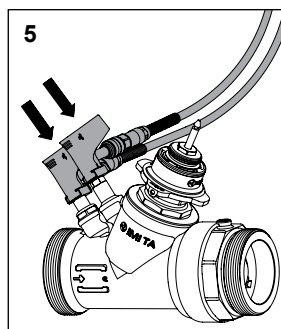
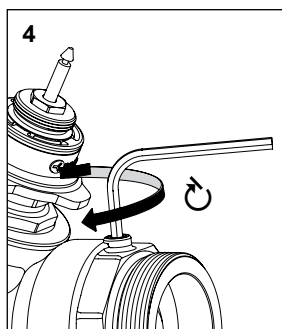
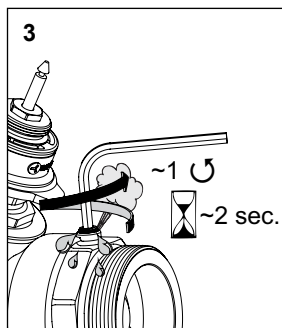
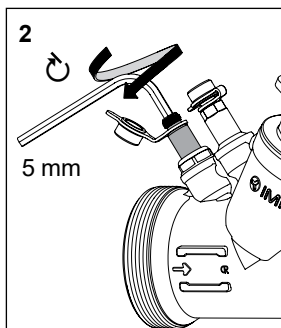
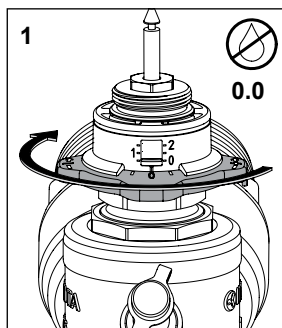

We reserve the right to introduce technical alterations without prior notice.



climatecontrol.imiplc.com