

TA-Mini-Fast-Fit

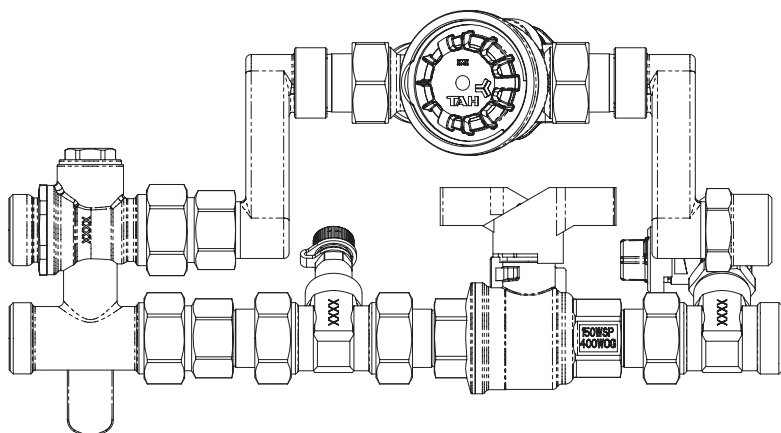

Flow range (q_{\max})

Modulating version (EQM characteristic)

DN 15 NF: 92 - 480 l/h

DN 15 HF: 200 - 975 l/h

On/off version (linear characteristic)

DN 15 ULF: 21.5 - 120 l/h

DN 15 LF: 44 - 245 l/h

DN 15 NF: 88 - 470 l/h

DN 15 HF: 210 - 1150 l/h

ULF = Ultra low flow

LF = Low flow

NF = Normal flow

HF = High flow

q_{\max} = l/h at each setting and fully open valve plug.

-10°C – +90°C

PN 16

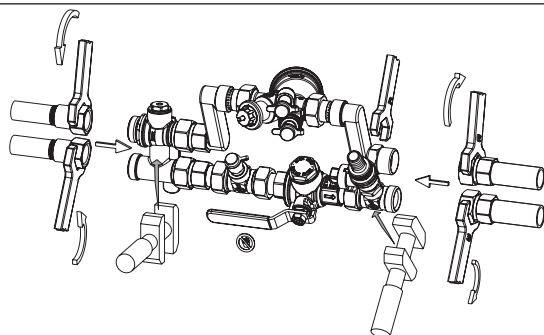
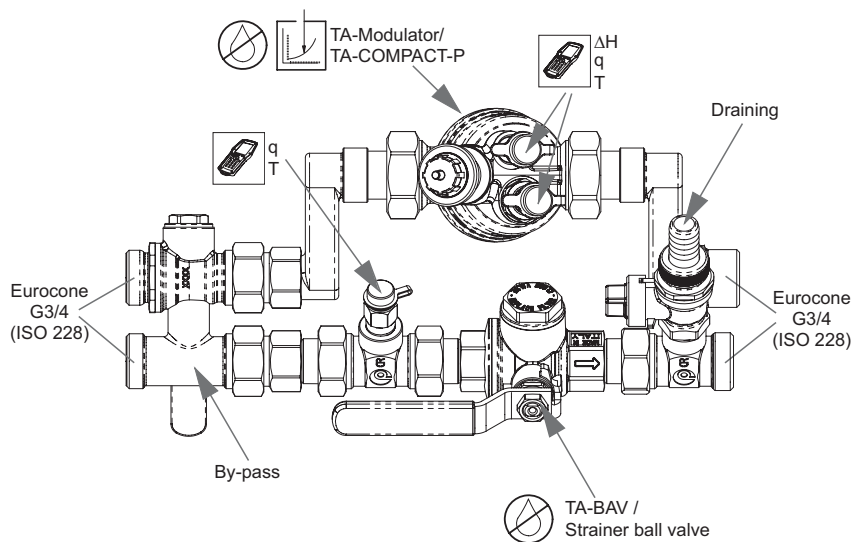

NOTE!

It is **not** allowed to hold the TA-Mini-Fast-Fit assembly, during installation, on other places then indicated by the wrenches in the illustration.

Max. torque ≤ 50 Nm

Maintenance – Strainer ball valve

To remove and clean the strainer;

1. Close the valve
2. Unscrew the lid
3. Remove the locking ring
4. Take the strainer out and clean (or change)
6. Insert the strainer
7. Remount the locking ring
8. Remount the lid
9. Reopen the valve

Normal operation

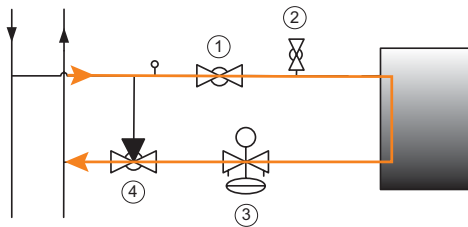

1. Open
2. Closed
3. Open
4. Open

Back flushing

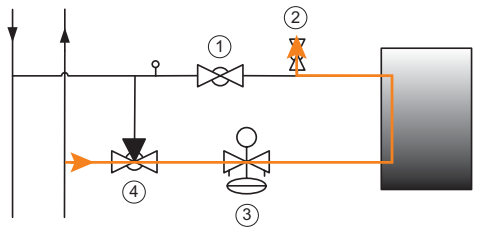

1. Closed
2. Open
3. Open
4. Open

Flushing the distribution system

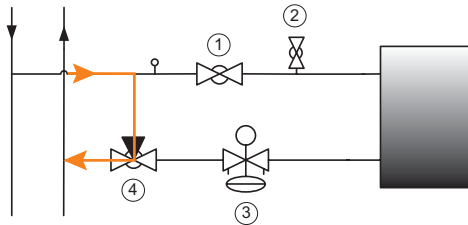

1. Closed
2. Closed
3. Open
4. Closed

Forward flushing

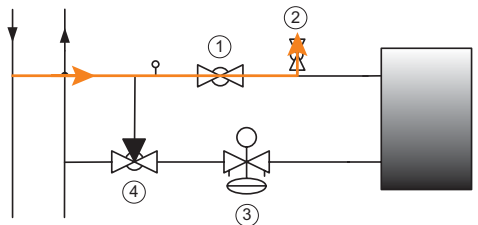

1. Open
2. Open
3. Closed
4. Open

**TA-Modulator + EMO TM
TA-COMPACT-P + EMO T**

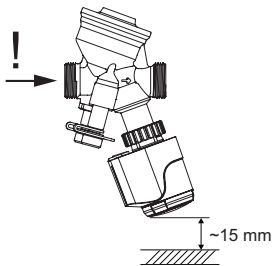

TA-Modulator + TA-Slider 160

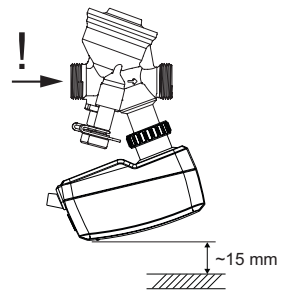

EMO TM / EMO T / TA-Slider 160

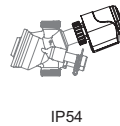
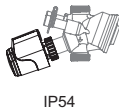

TA-Modulator / TA-COMPACT-P

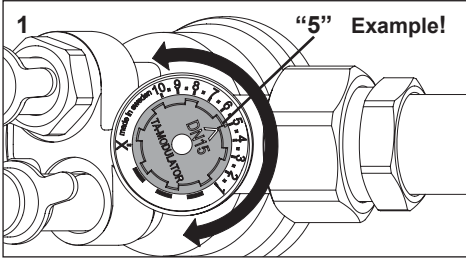
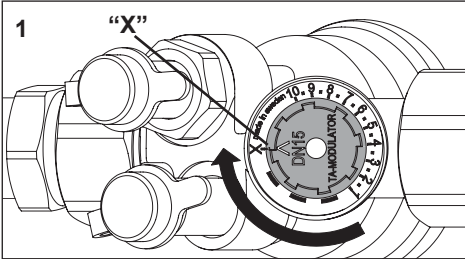
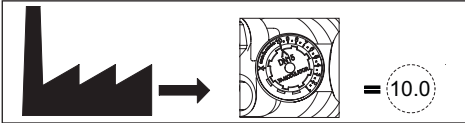

q

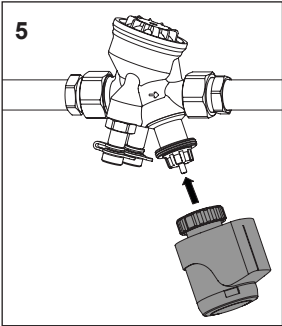
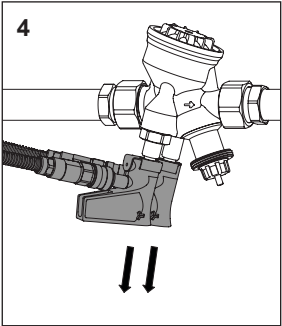
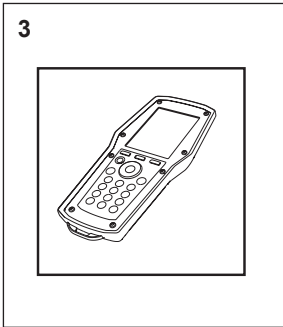
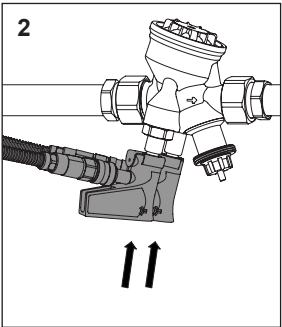
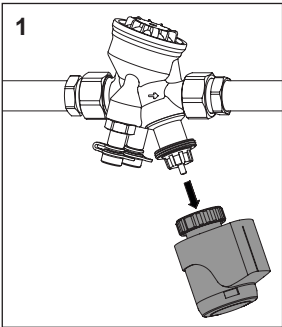



ΔH

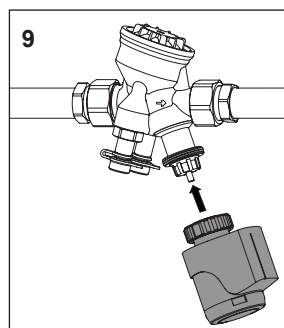
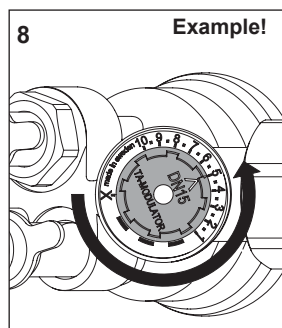
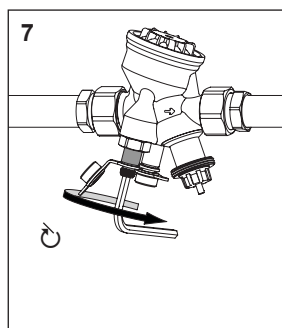
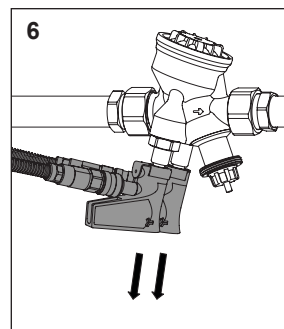
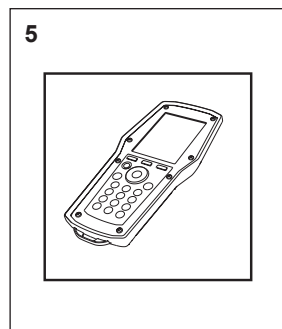
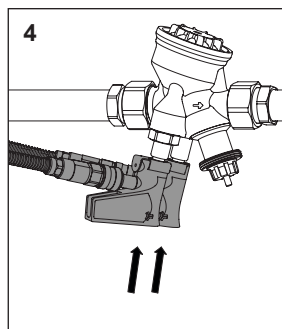
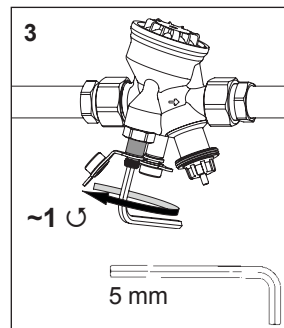
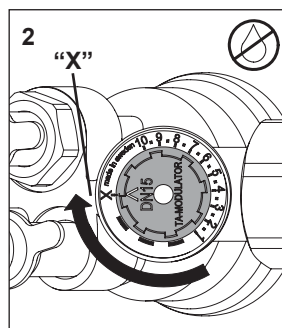
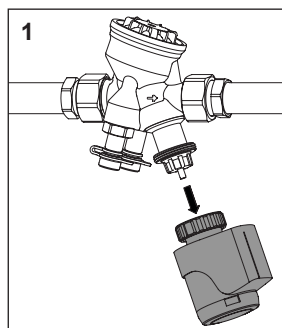

We reserve the right to introduce technical alterations without prior notice.



Hydronic Engineering

www.imi-hydronic.com