

4000136
11.2024

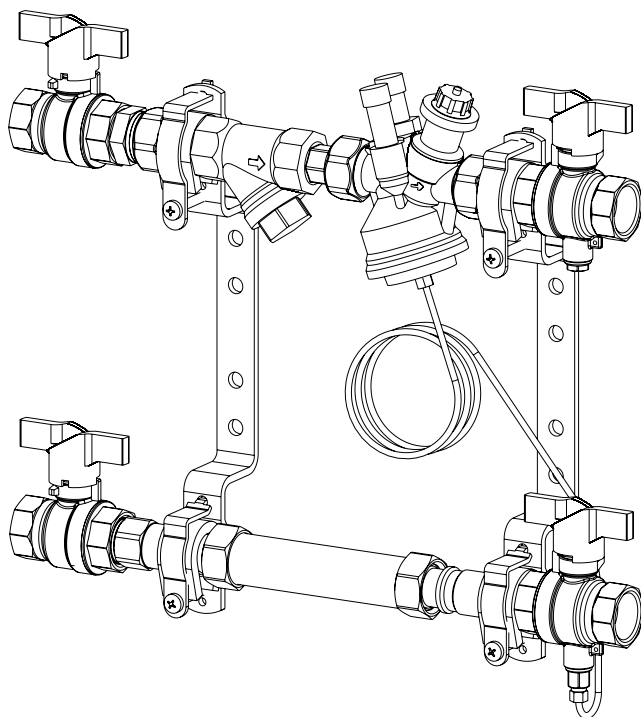

IMI TA

TA-CIC One



0°C – +90°C

PN 10

ΔH_{\max} : 400 kPa = 4 bar

ΔH_{\min} :
DN 20 LF: 19 kPa = 0,19 bar
DN 20 NF: 27 kPa = 0,27 bar

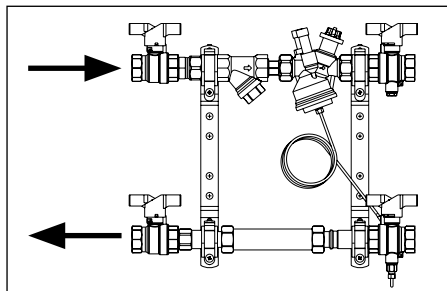

Pos	q_{\max} [l/h]					
	Δp_L [kPa]		Δp_L [kPa]		Δp_L [kPa]	
	LF	NF	LF	NF	LF	NF
1	76	196	59	162	42	100
2	129	308	98	255	67	153
3	166	423	127	349	84	208
4	209	532	158	438	103	260
5	251	634	189	520	122	307
6	288	724	216	594	138	347
7	324	813	243	666	153	386
8	353	890	265	727	166	419
9	379	975	284	791	177	452
10*	397	1038	298	840	185	477

q_{\max} =

FR l/h à chaque réglage et vanne complètement ouverte.

EN l/h at each setting and fully open valve plug.

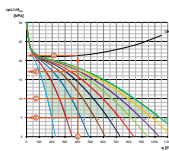

TA-CIC One
climatecontrol.imiplc.com

*)

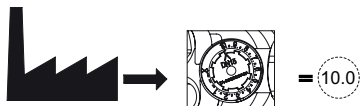

TA-COMPACT-DP + EMO T / EMO TM / TA-Slider 160



IP54



IP54



IP54



IP54

EMO T / EMO TM

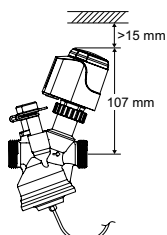

TA-Slider 160

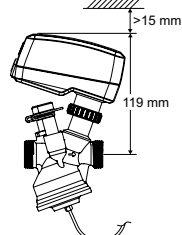



1

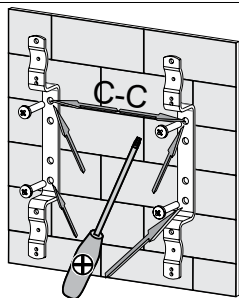

	DN 20 LF	DN 20 NF
C-C [mm]	~189	~197

2

DN 20 LF

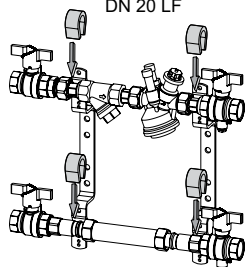

DN 20 NF

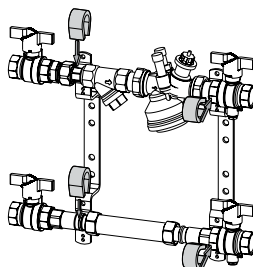

3

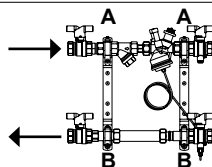
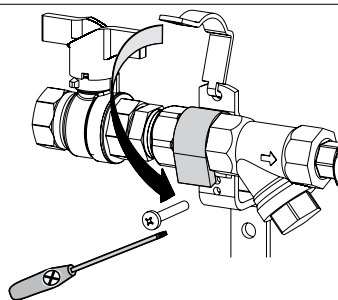

	A	B
DN 20 LF	1"	3/4"
DN 20 NF	1"	1"

4

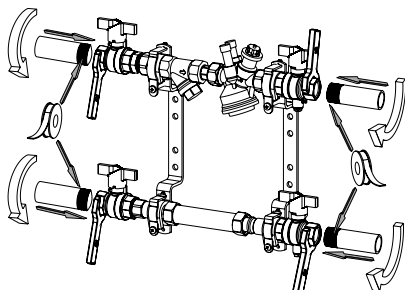

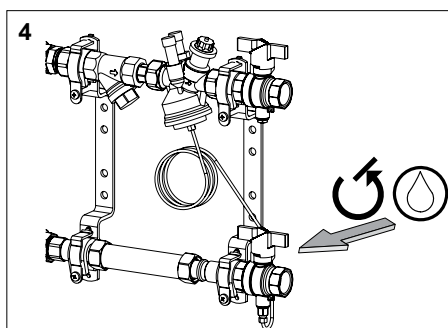
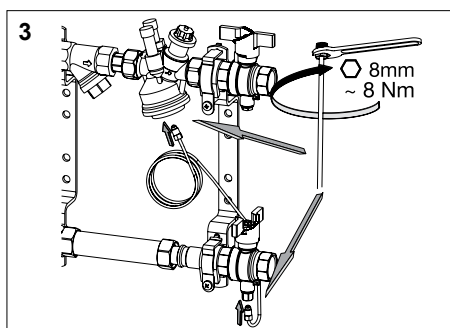
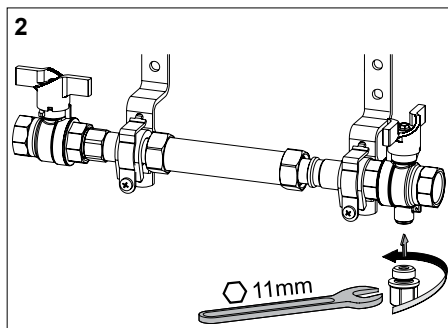
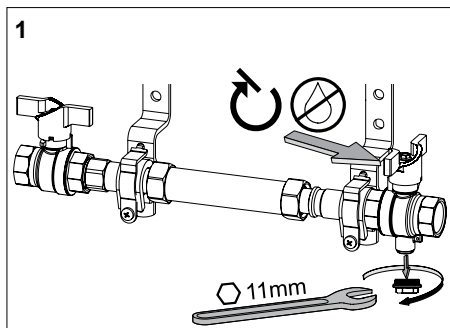

TA-COMPACT-DP

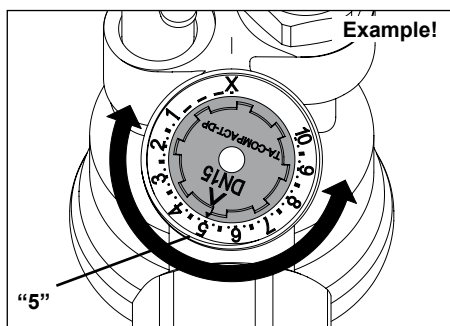



q, T

1

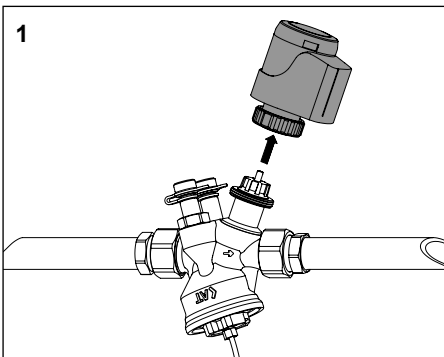

2

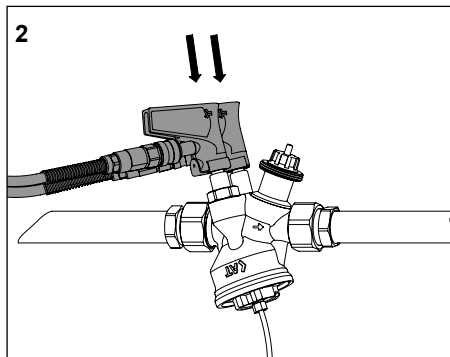

3



4

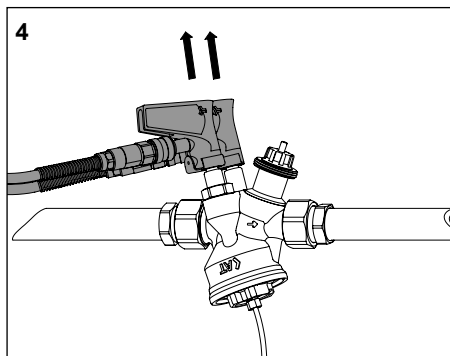

5

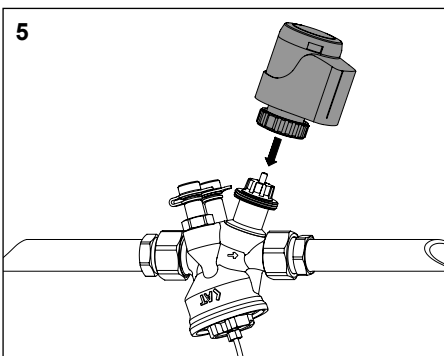



ΔH

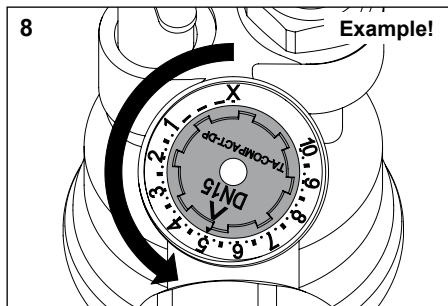
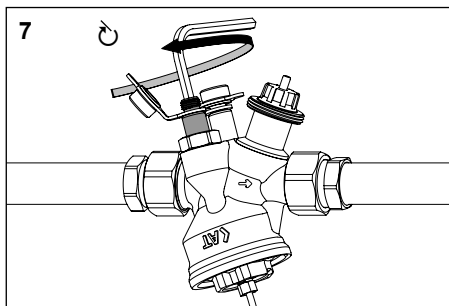
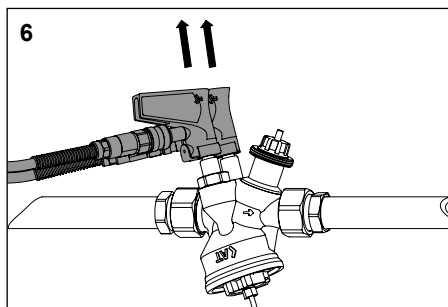
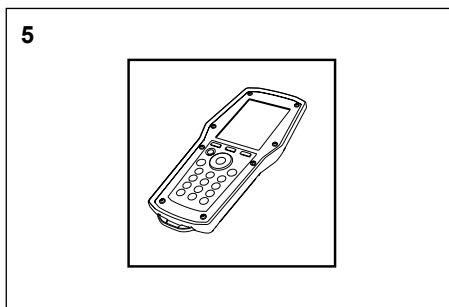
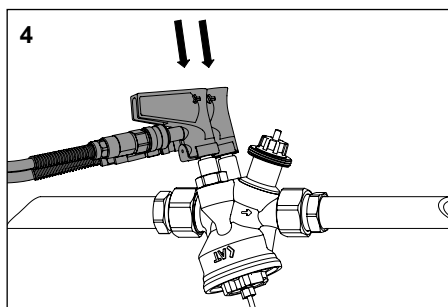
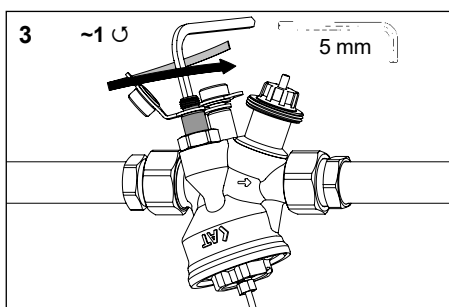
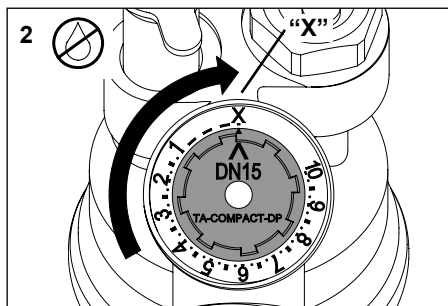
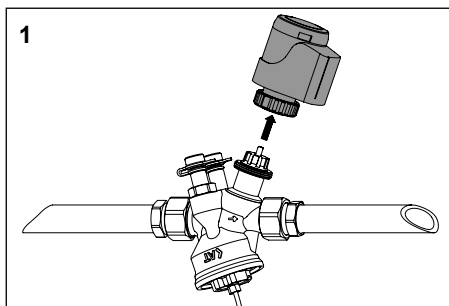

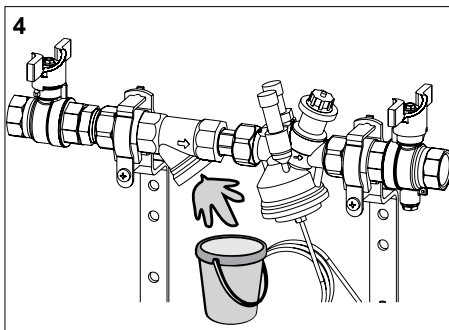
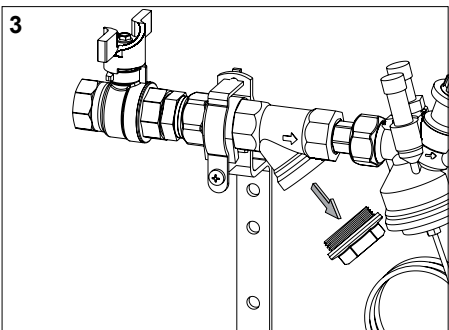
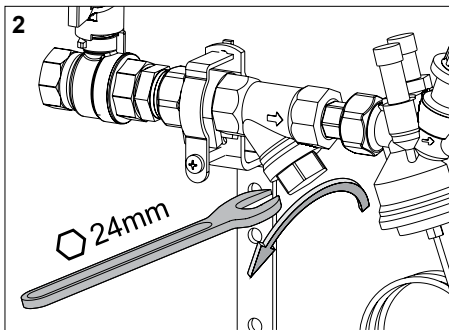
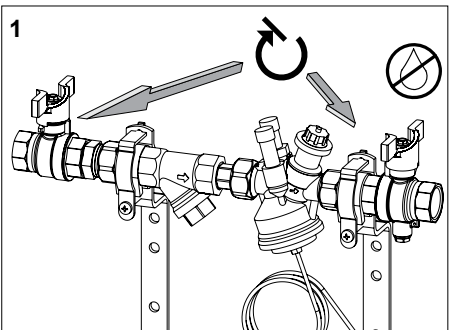
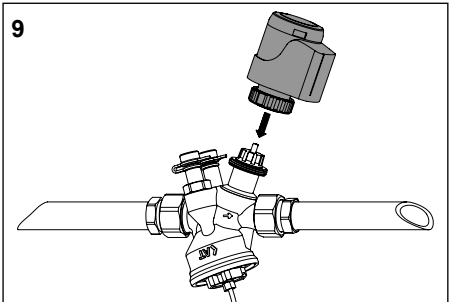

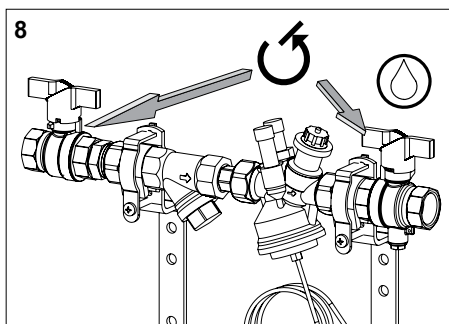
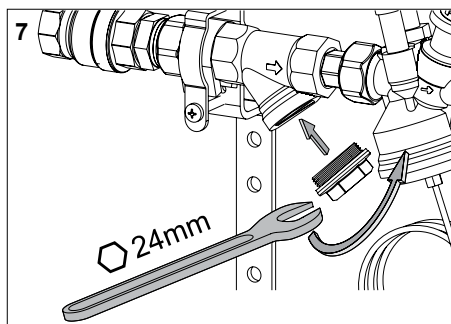
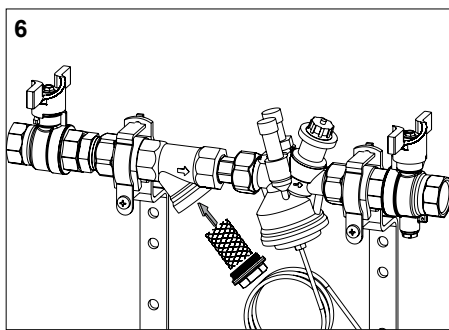
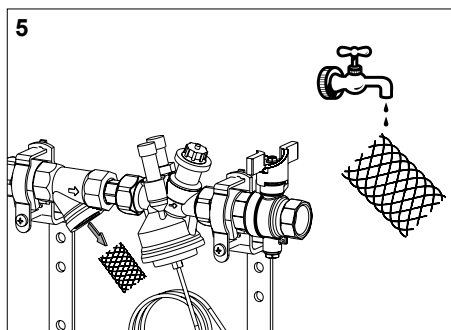

We reserve the right to introduce technical alterations without previous notice.

