

Insulation TA Fast-Fit 4

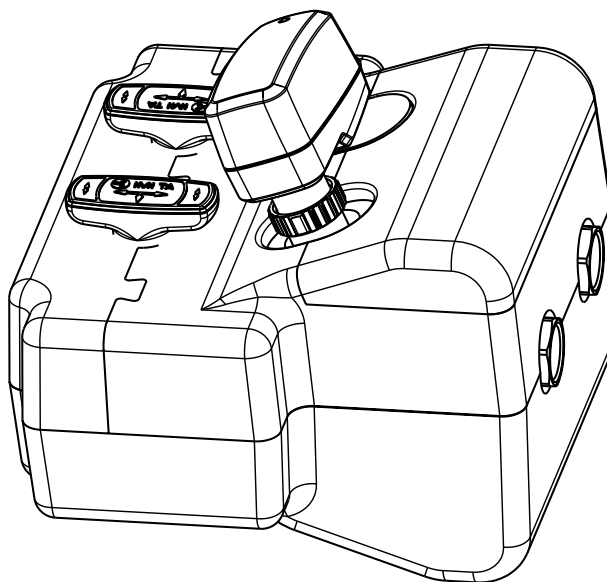

Insulation + spindle extension (kit)

DN 10, 15, 20 Art. No. 339010-50502

DN 25 Art. No. 339010-50602

Spindle extension

Art. No. 2002-30.700

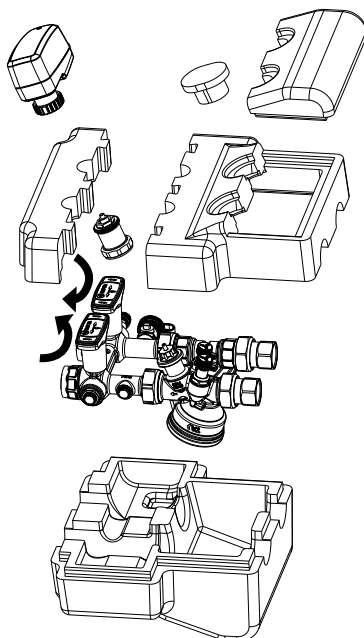
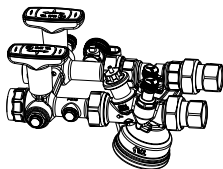
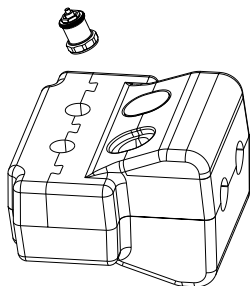

Calculate the space necessary for the insulating bonnet before assembling the pipe.

Cooling systems

In order to prevent condensation, it is particularly important that the connection between the insulating bonnet and the anticondensation insulation on the pipe is correctly made.

1. Fit the insulating bonnet to the valve.
2. Insulate the pipe using soft foam rubber anti-condensation insulation (e.g. Armaflex or Insul Tube foam rubber insulation).
3. Secure the anti-condensation insulation to the insulating bonnet with adhesive sealing paste.

If the insulating bonnet is removed, make sure that the insulation on the pipe is again bonded to it when it is replaced.

1

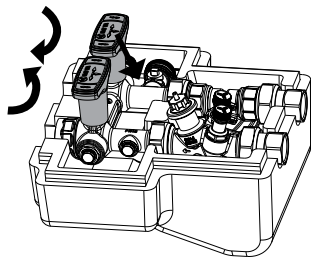

2

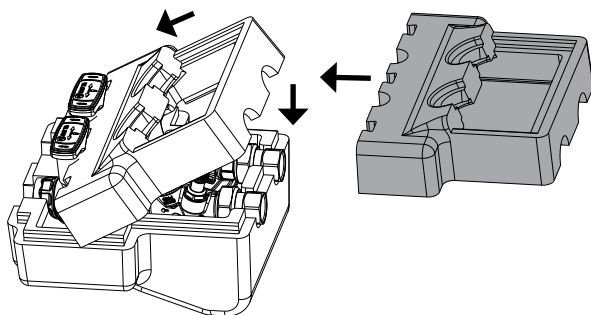

3

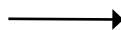
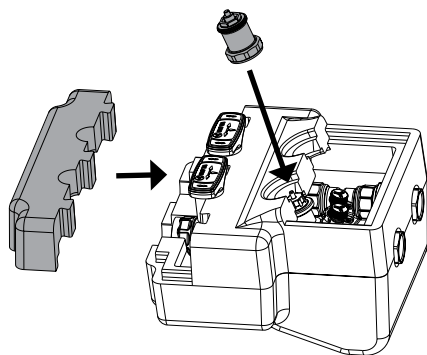

4

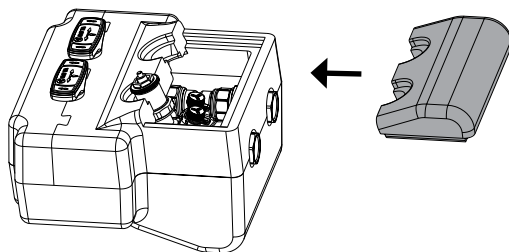

5

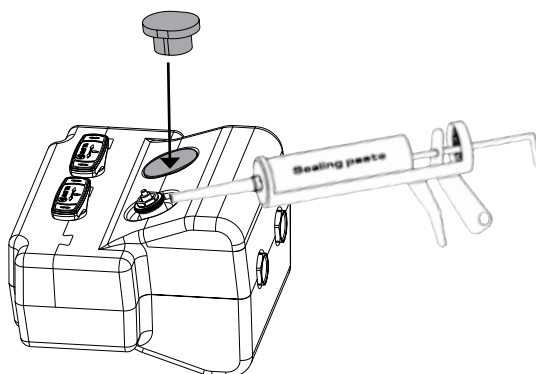

6

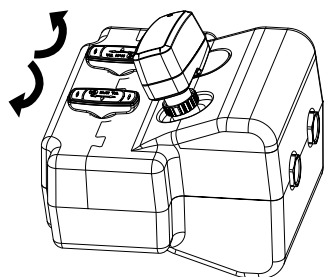

We reserve the right to introduce technical alterations without prior notice.