

311 489-11
11.2024



IMI TA

Dp sensor set for TA-Smart-Dp

Article No.
325020-10008
325020-10009

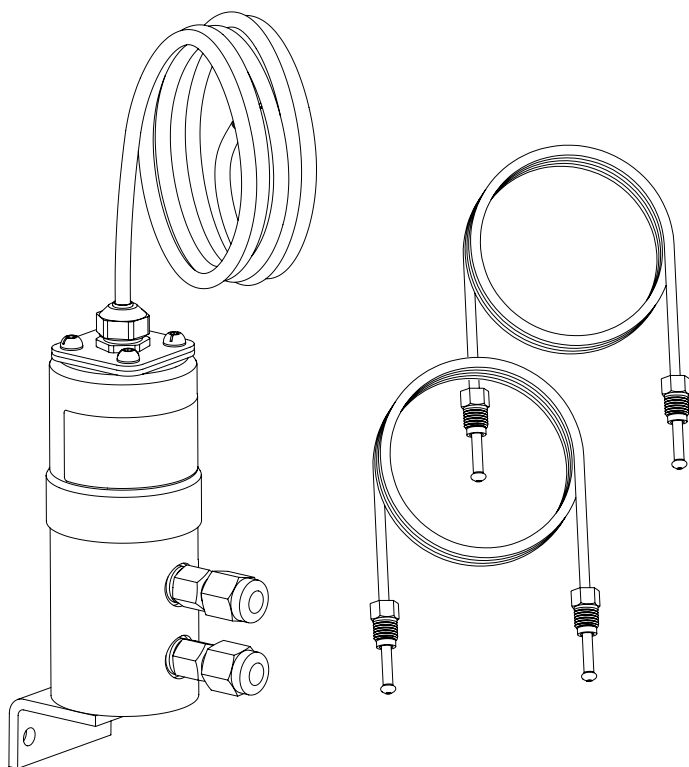



24 VAC/VDC operating only with safety isolating transformer according to EN 61558-2-6.
24 VAC/VDC-Betrieb nur mit Sicherheitstransformator nach EN 61558-2-6.
24 VAC/VDC fonctionnant uniquement avec transformateur de sécurité selon la norme EN 61558-2-6.
24 VAC/VDC funcionando sólo con transformador de seguridad de acuerdo con EN 61558-2-6.
24 VAC/VDC działa tylko z bezpiecznym transformatorem zgodnym z EN 61558-2-6.

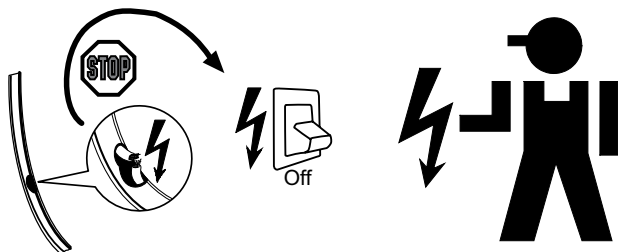

Service/Repair
Service/Reparatur
Entretien/Réparation
Servicio/Reparación
Serwis/Naprawa

→  IMI

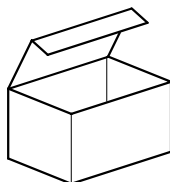

Art. No.

325020-10008 10-100 kPa (1.45-14.5 psi)
325020-10009 40-400 kPa (5.5-58 psi)

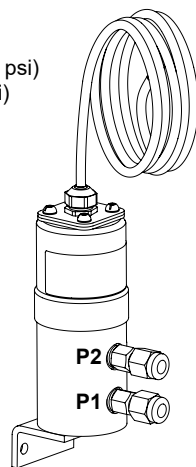
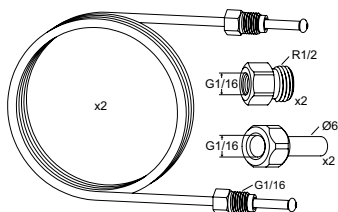

Technical specifications valid at an altitude of max. 2000 m.

Die technischen Spezifikationen sind nur bis zu einer maximalen Höhenlage von 2000 m über NN gültig.

Spécifications techniques valables pour une altitude maxi de 2000 m.

Las especificaciones técnicas son válidas solamente hasta una altitud máx. 2000 metros.

Specyfikacje techniczne obowiązujące na wysokości maks. 2000 metros.



-40°C - +80°C (-40°F - +176°F)

(5-95%RH, non-condensing/nicht kondensierend/sans condensation/
sin condensación/bez kondensacji)



-15°C - +80°C (5°F - +176°F)

(5-95%RH, non-condensing/nicht kondensierend/sans condensation/
sin condensación/bez kondensacji)

Δp : 10-100 kPa (1.45-14.5 psi)
40-400 kPa (5.5-58 psi)

Δp_{burst} : 500 kPa = 5 bar (72.5 psi)
1200 kPa = 12 bar (174 psi)

Power supply/Spannungsversorgung/Tension d'alimentation/
Tensión de alimentación/ Zasilanie: 18-33 VDC
24 VAC +15/-10 % (0-10 V)

IP65

- DN 50

Example 1

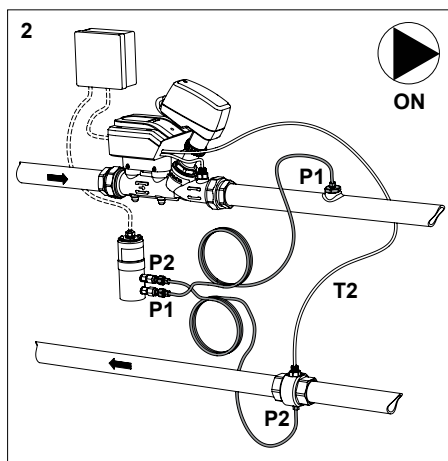
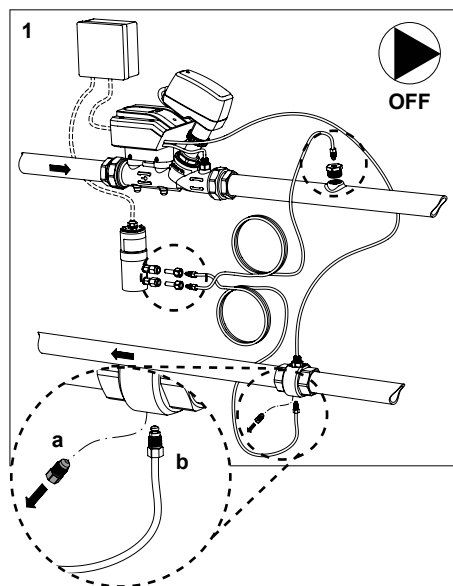

Example 2

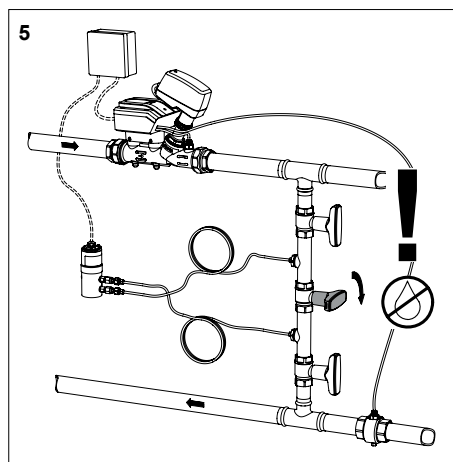
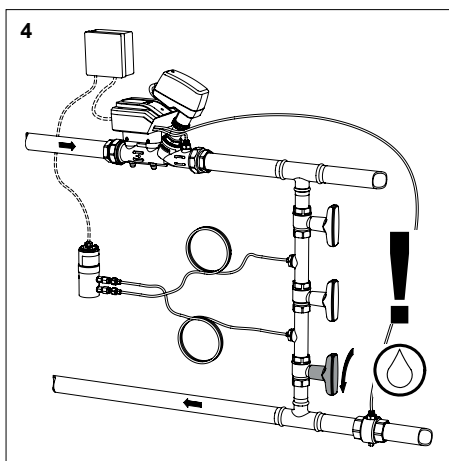
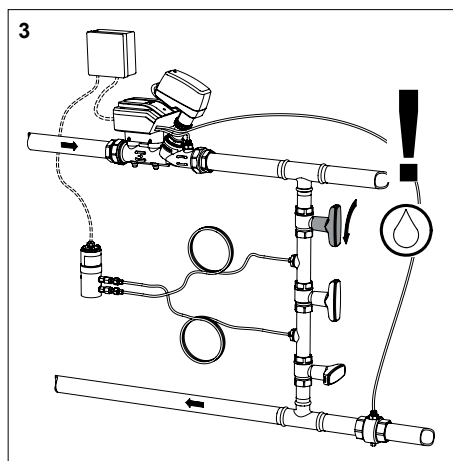
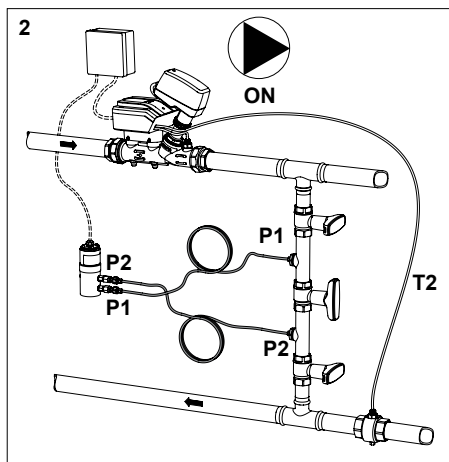
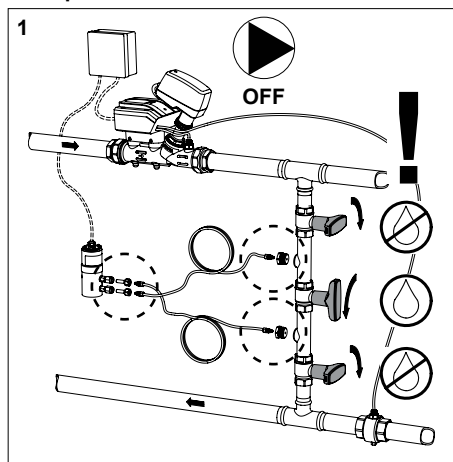

Example 1

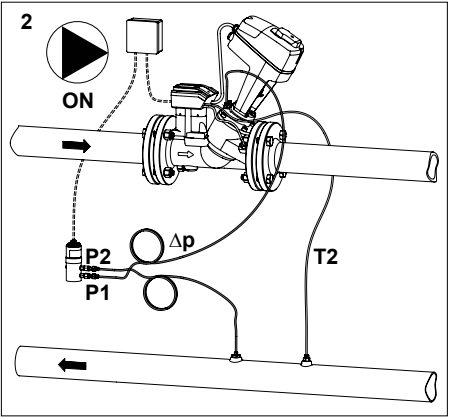
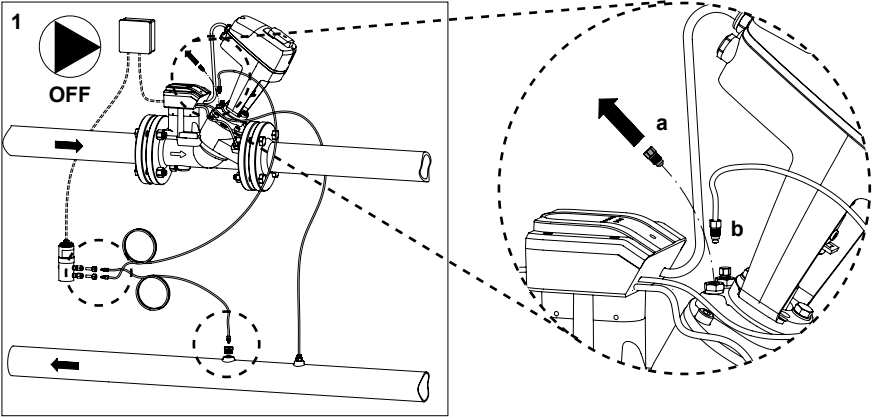

Example 2

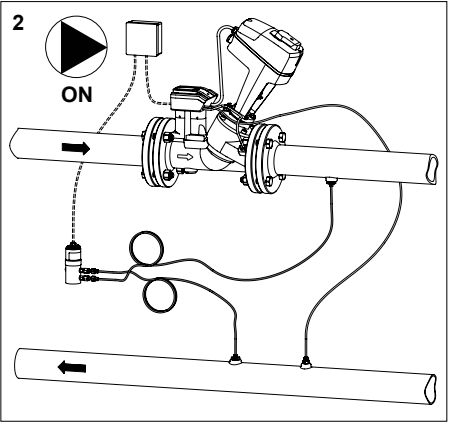
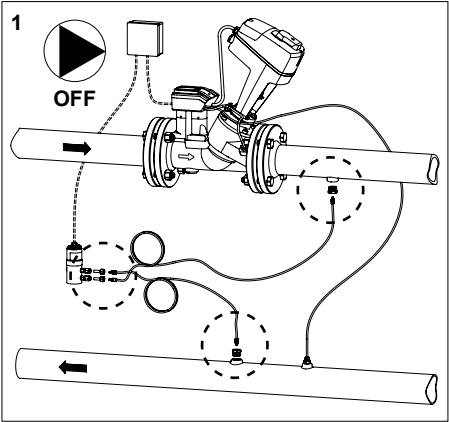

Example 3

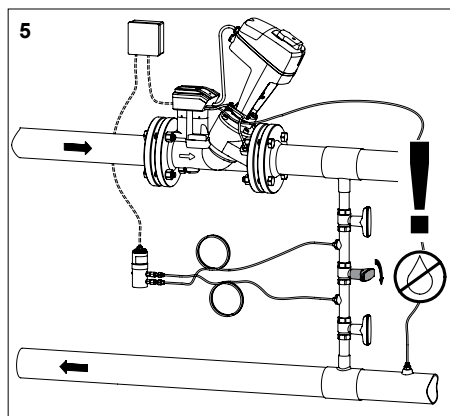
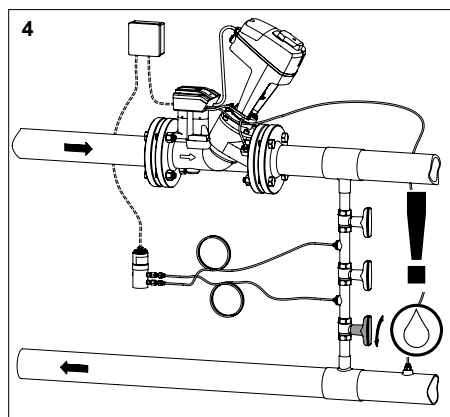
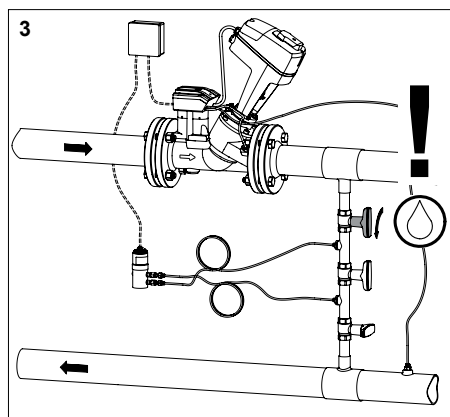
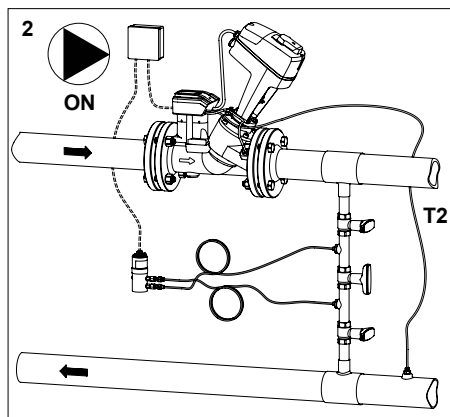
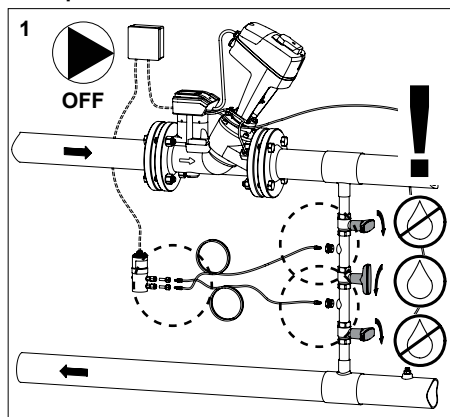

Wiring diagrams/Anschlusschema/Schéma de raccordement/ Esquema eléctrico/Schematy połączeń

Ethernet

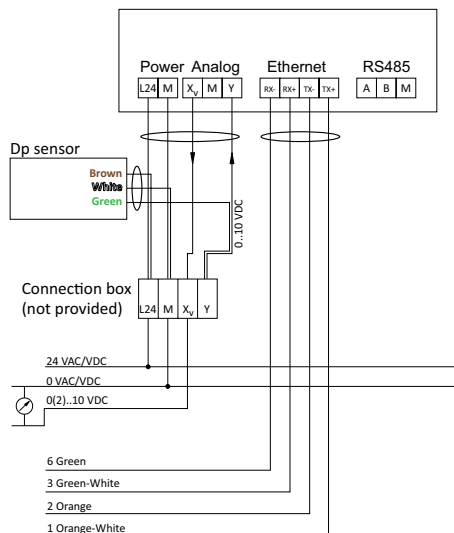

RS485

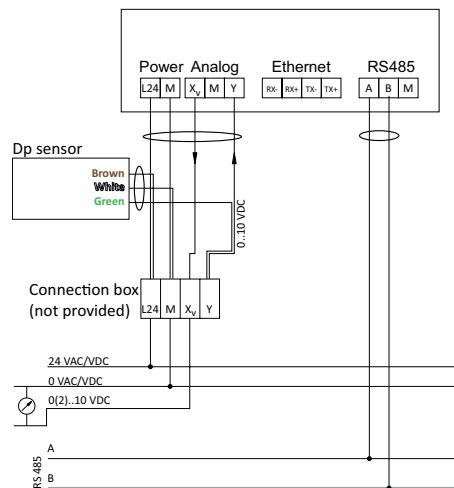

HyTune app

For setting of control parameters use HyTune app.

Die HyTune App dient zum einstellen der Regelparameter.

Pour le réglage des paramètres de régulation, utiliser l'application HyTune.

Use la app HyTune para la configuración de los parámetros de control.

Do ustawiania parametrów sterowania służy aplikacja HyTune.

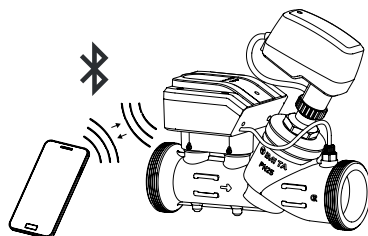

We reserve the right to introduce technical alterations without previous notice.