

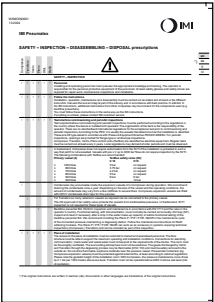

IMI Pneumatex

Vento Connect  
V 4 - 14  
install

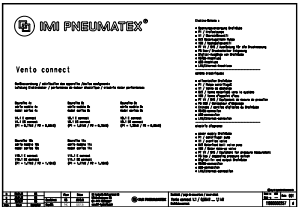

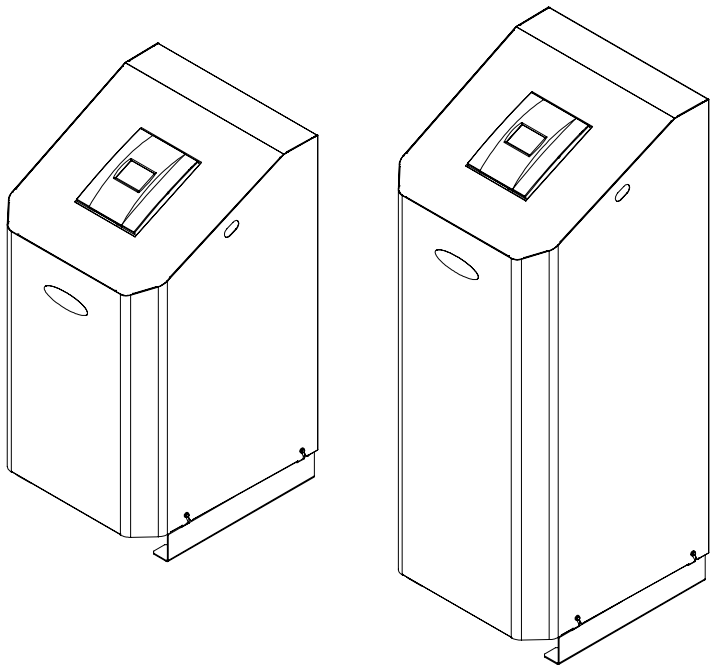
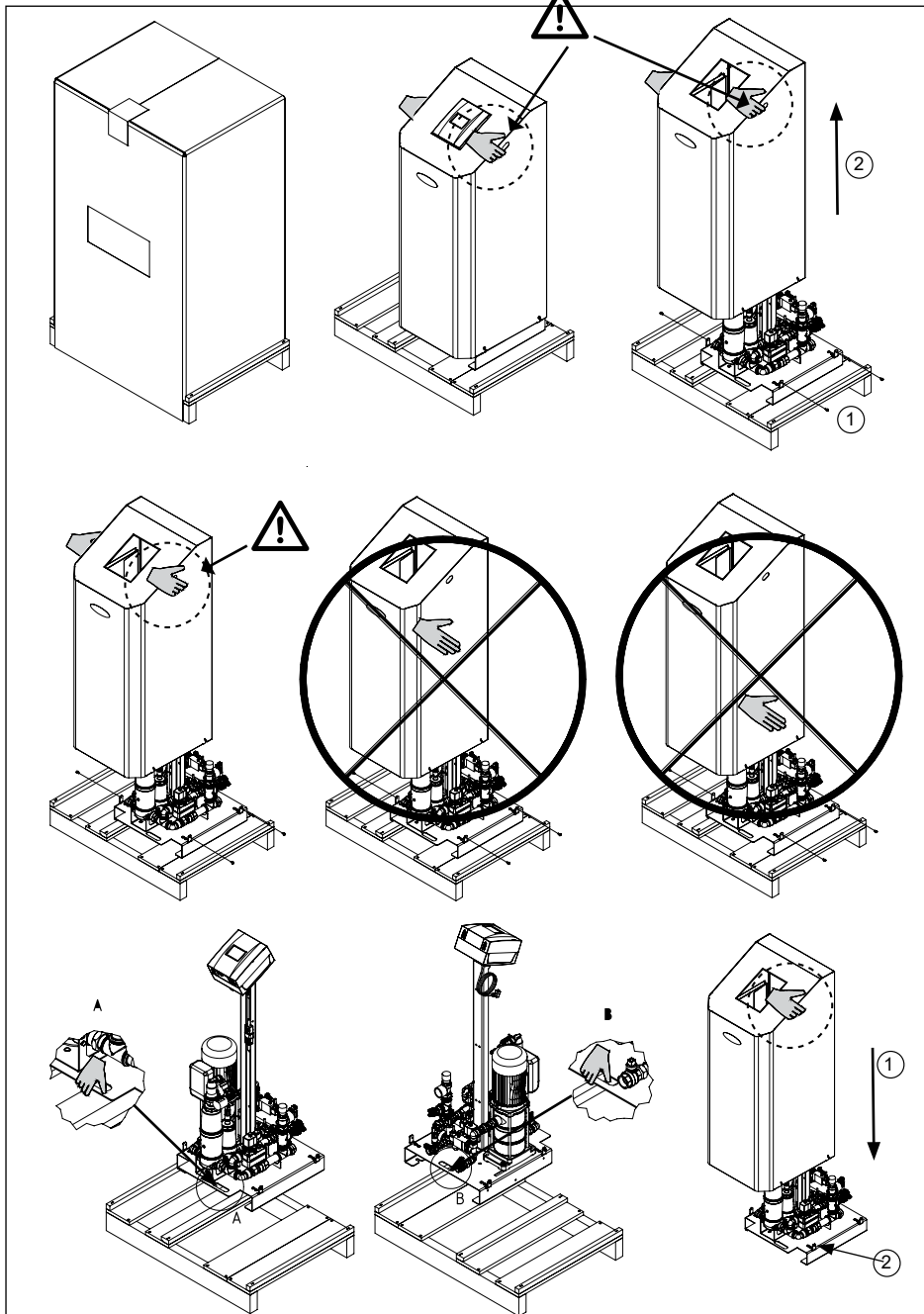

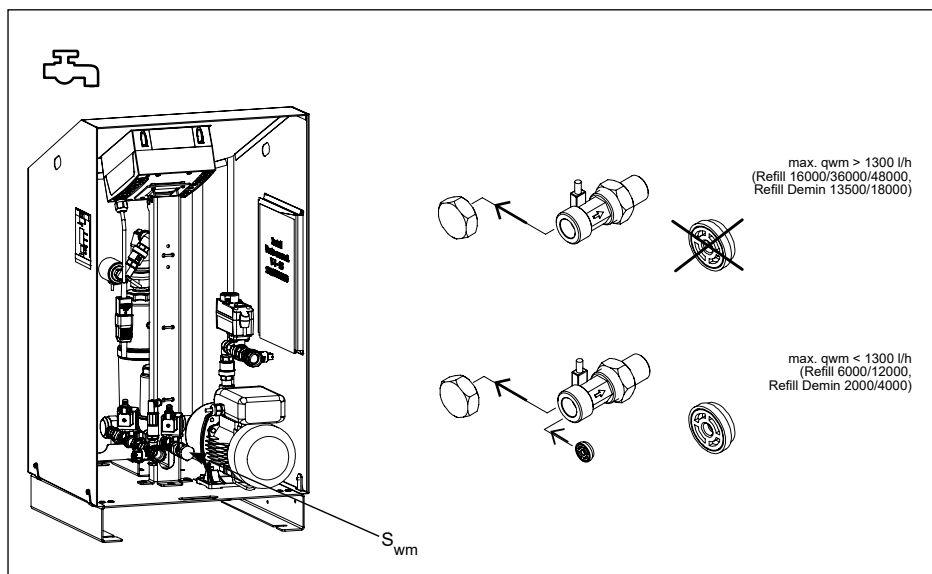
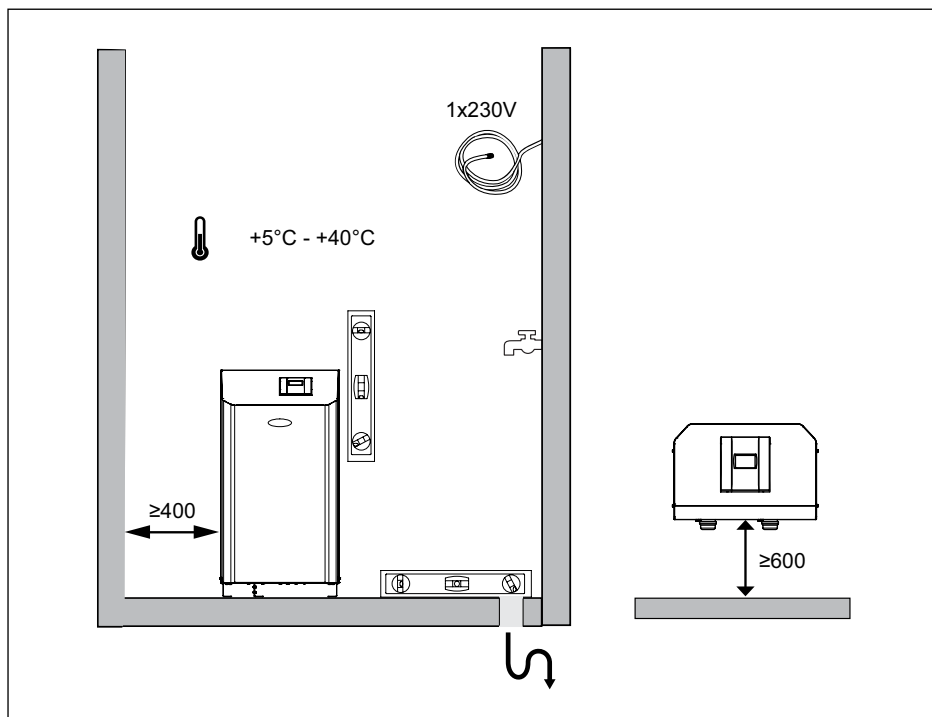

# Vento V.1

 Optional

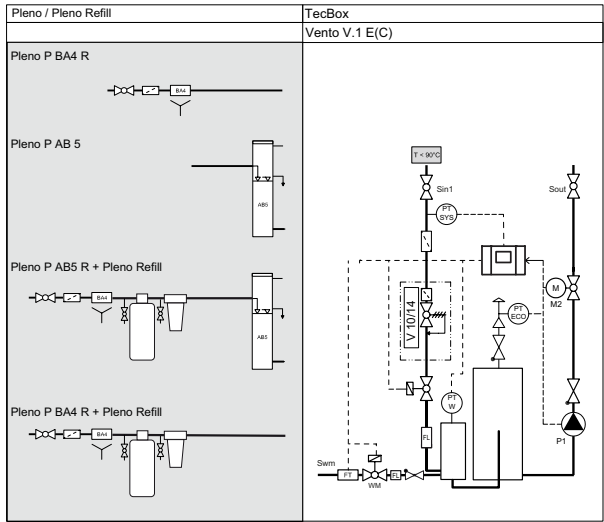

**V.4\_, V.6\_, V.8\_**

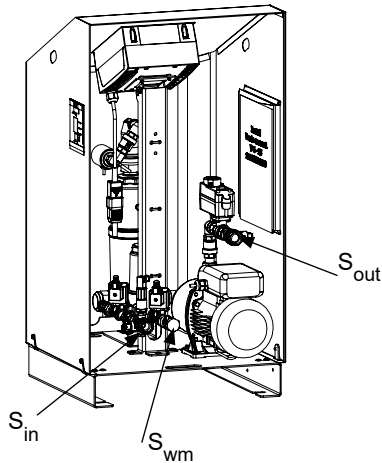

**V.10\_, V.14\_**

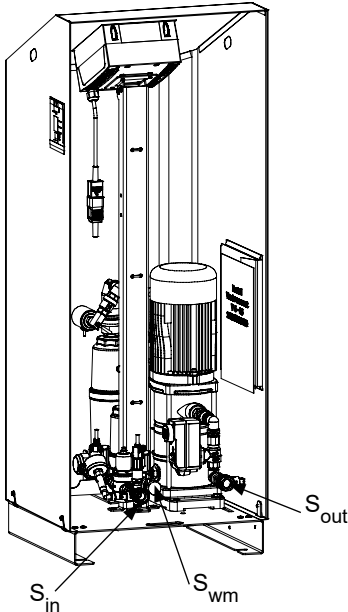

		V_4.1	V_6.1	V_8.1	V_10.1	V_14.1
dpu min	bar	1	1,5	2	3,5	5,5
dpu max	bar	2,5	3,5	4,5	6,5	10

		Sin1	Sout	Swm
Ts min	°C	0	0	0
Ts max	°C	90	90	65



$tr \leq 90^\circ\text{C}$

## Vento V.1 E + Pleno P BA4R

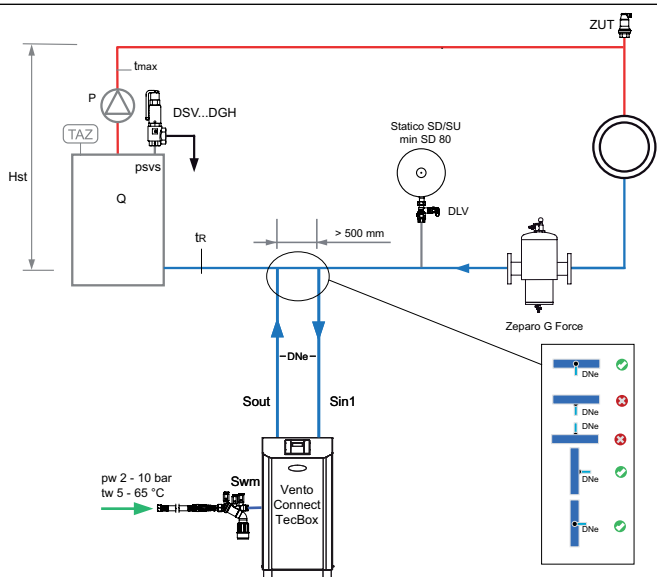

$tr > 0^\circ\text{C}$

## Vento V.1 EC + Pleno P AB5 R + Pleno Refill

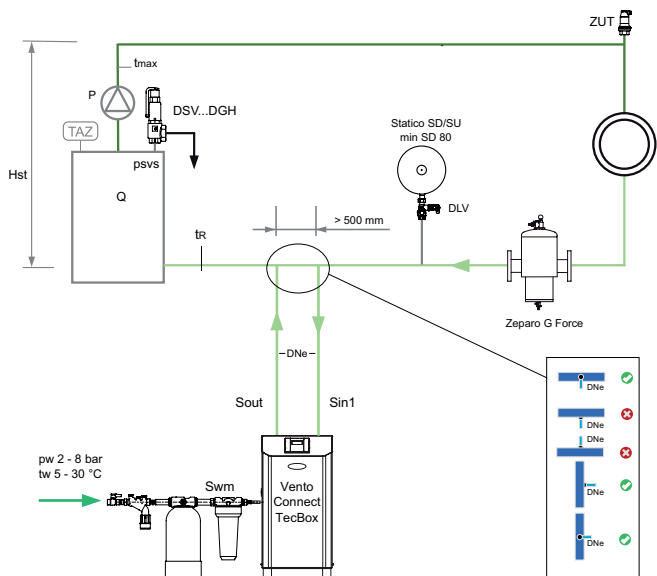

## DNe

		V_4.1	V_6.1	V_8.1	V_10.1	V_14.1
L max 10 m	DNe	25	25	25	25	25
L max 20 m	DNe	25	25	25	25	25
L max 30 m	DNe	32	32	32	32	32

230V/50 Hz  
10A / 3 x 1,0 mm<sup>2</sup>



#1-5

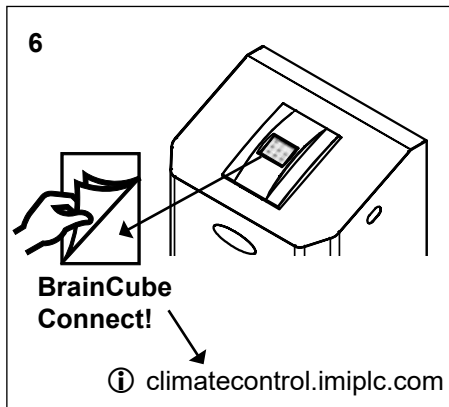
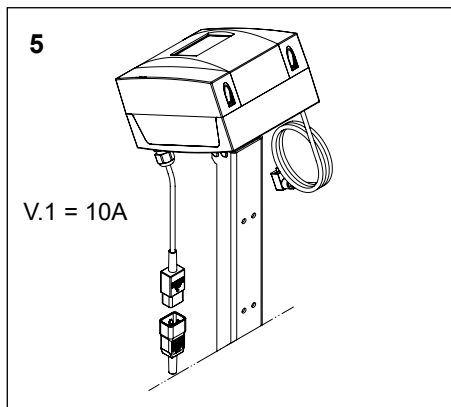
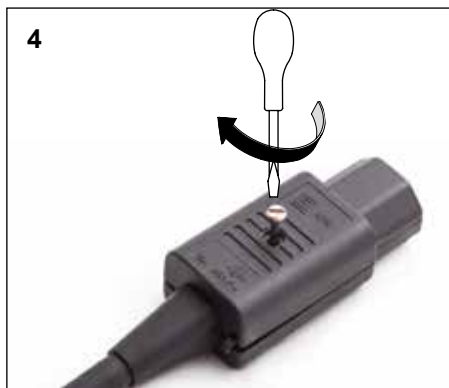
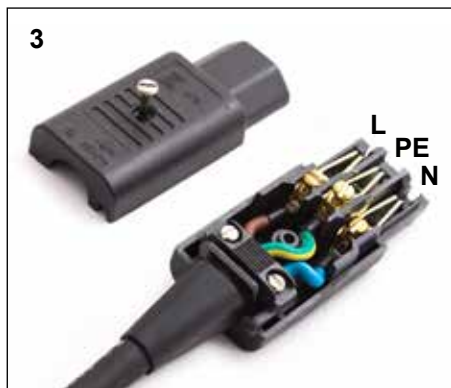
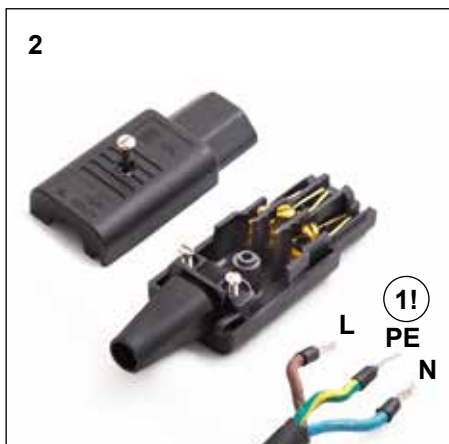
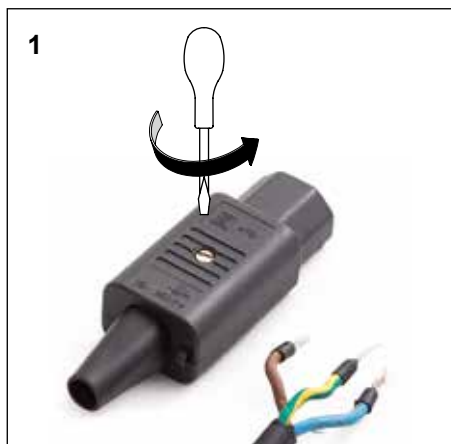



We reserve the right to introduce technical alterations without prior notice.



IMI Hydronic Engineering AG  
(Teil von Climate Control, einem Sektor von IMI plc)  
Mühlerainstrasse 26 • CH-4414 Füllinsdorf  
Tel. +41 (0)61 906 26 26

[climatecontrol.imiplc.com](http://climatecontrol.imiplc.com)