

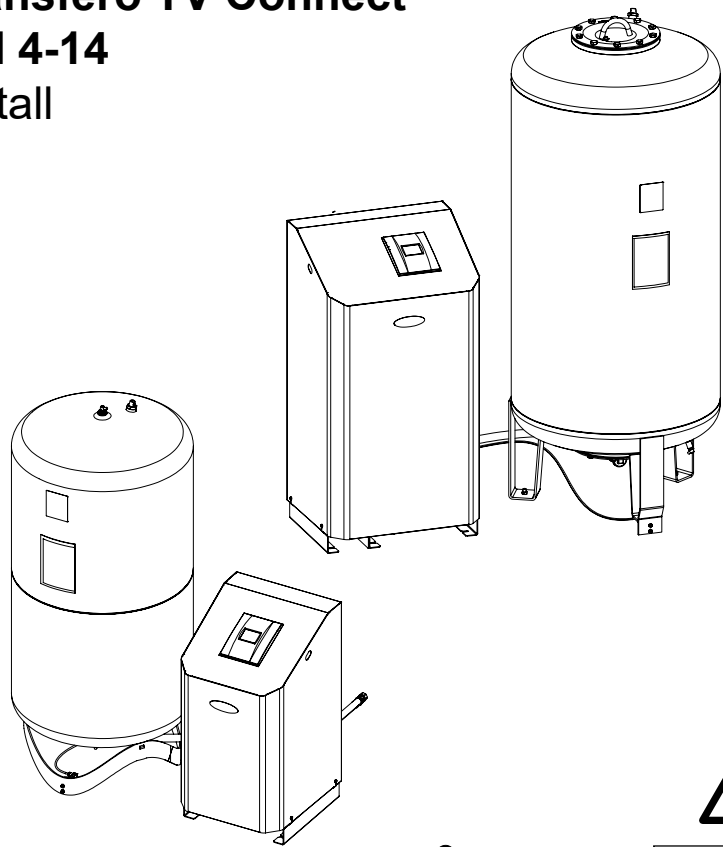

IMI Pneumatex

Transfero TV Connect  
TVI 4-14  
Install



IMI PNEUMATEX®	
Transfero connect (single pump units)	
Technical data (single pump units)	
Model	
TVI 4-14	
Capacity (l/h)	
4-14	
Power (kW)	
0.5-1.5	
Voltage (V)	
230V	
Frequency (Hz)	
50	
Connection (mm)	
1/2"	
Material	
Stainless steel	
Dimensions (mm)	
400x600x1200	
Weight (kg)	
150	
Installation	
Indoor	
Outdoor	
Indoor/outdoor	
Installation instructions	
IMI Pneumatex	

IMI Pneumatex	
SAFETY - INSPECTION - DISASSEMBLING - DISPOSAL - PREVENTION	
1. SAFETY	
2. INSPECTION	
3. DISASSEMBLING	
4. DISPOSAL	
5. PREVENTION	

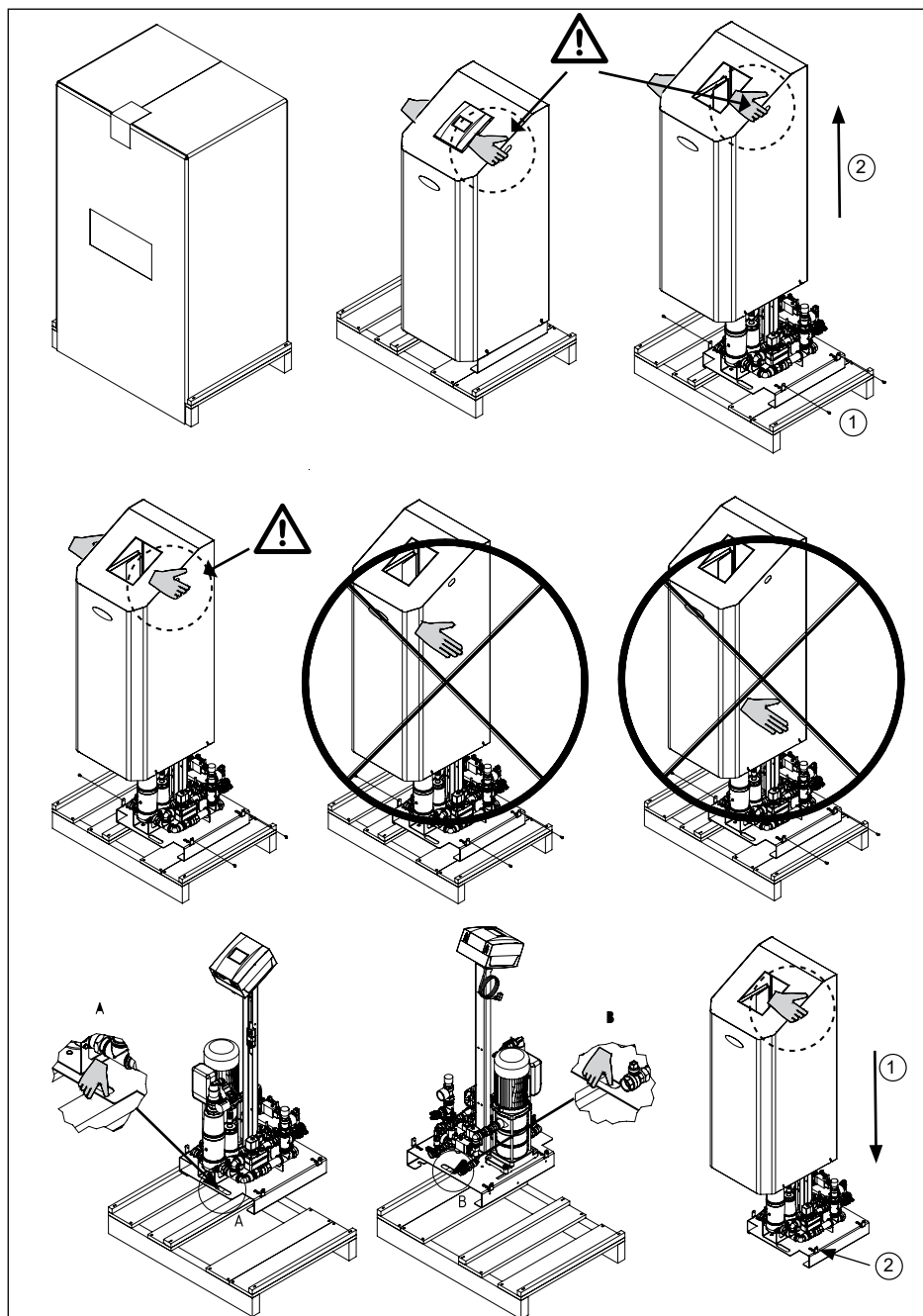
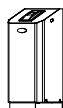



**TU** Art.Nr. 7463011



**TG** Art.Nr. 7463013

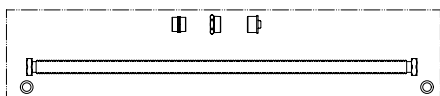

**TU-E** Art.Nr. 7463012

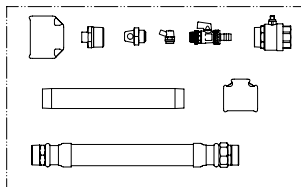

**TG-E** Art.Nr. 7463014

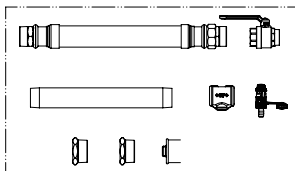

**Transfero TU/TUE**

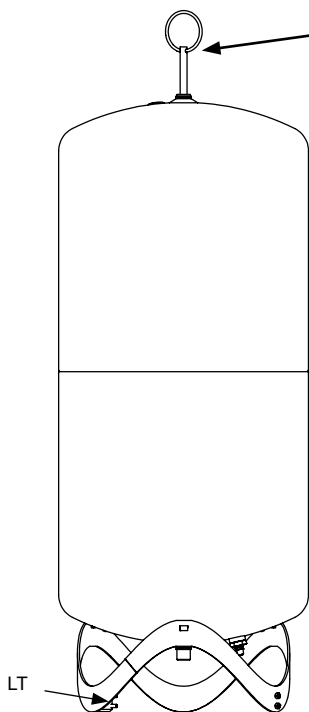

**Transfero TG/TGE**

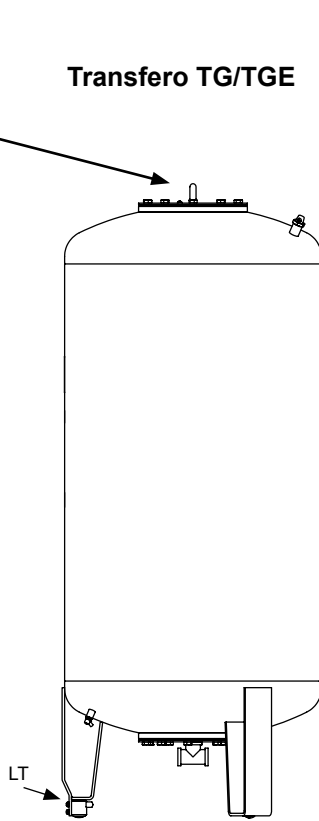



## Transfero TU

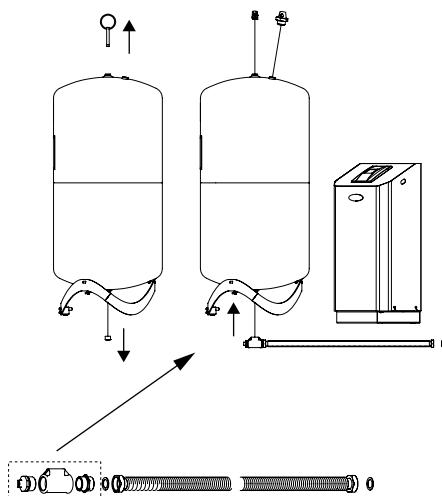

## Transfero TUE

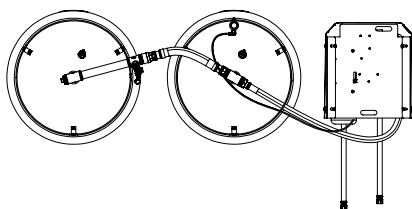
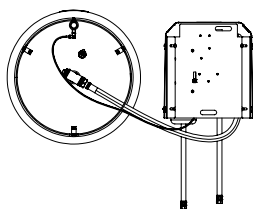
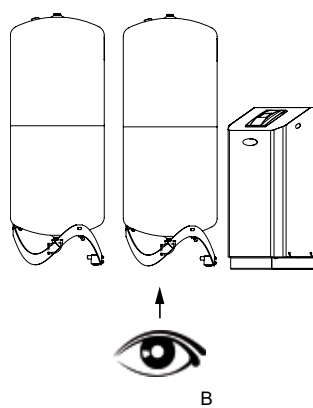
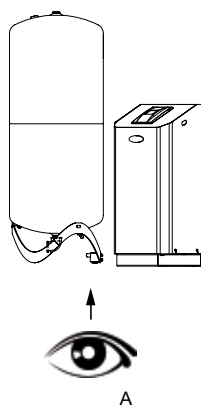
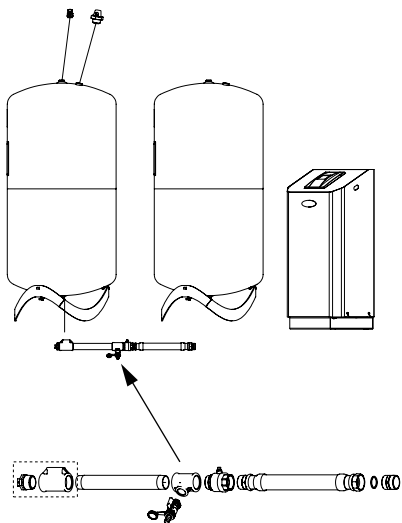

## Transféro TG

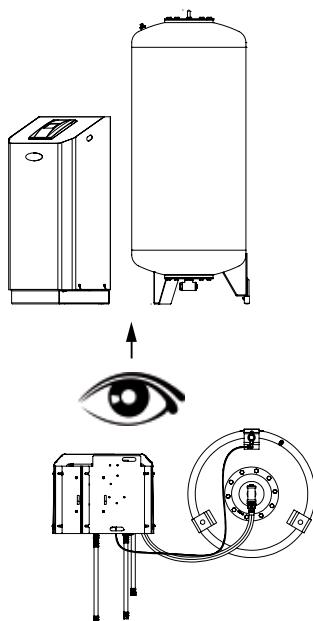
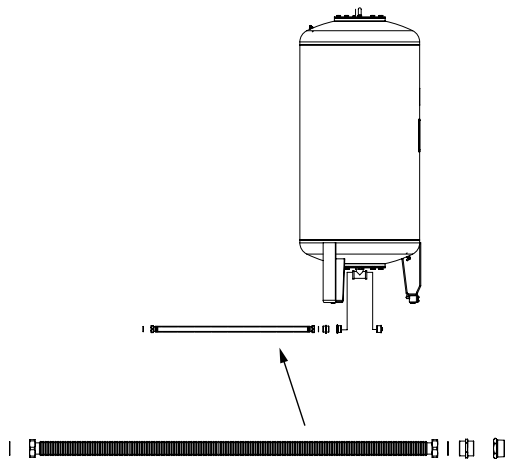

## Transfero TG

## Transfero TG-E

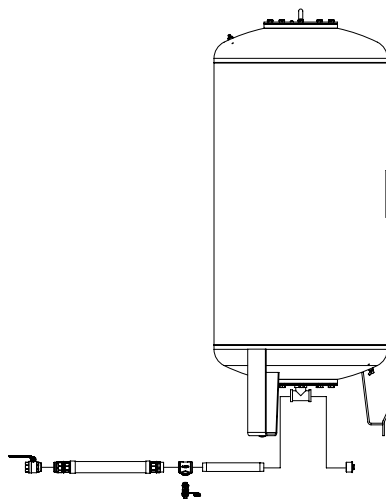
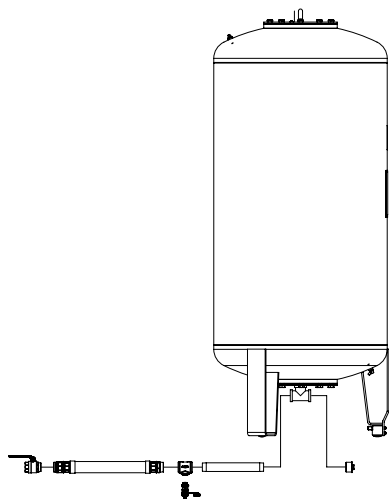

**TG-E Art. No. 7463014**

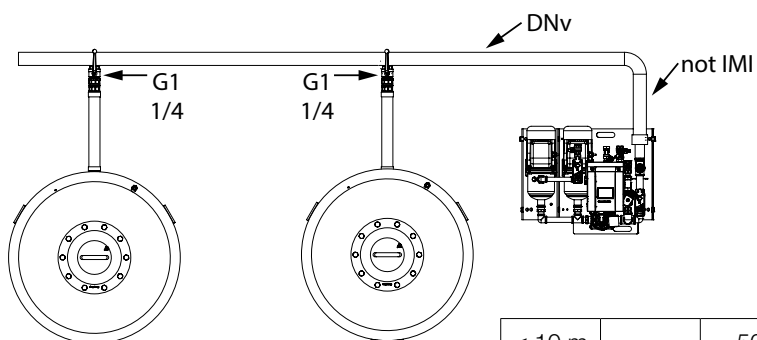
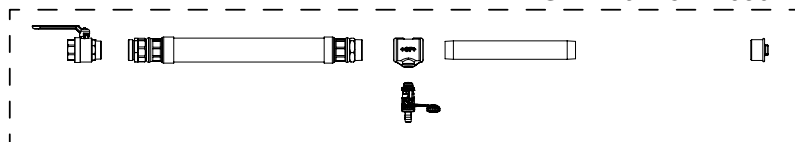

$\leq 10 \text{ m}$	$DNv \geq$	50
$\leq 30 \text{ m}$		65

# TV.1 E (C) (H)

Optional

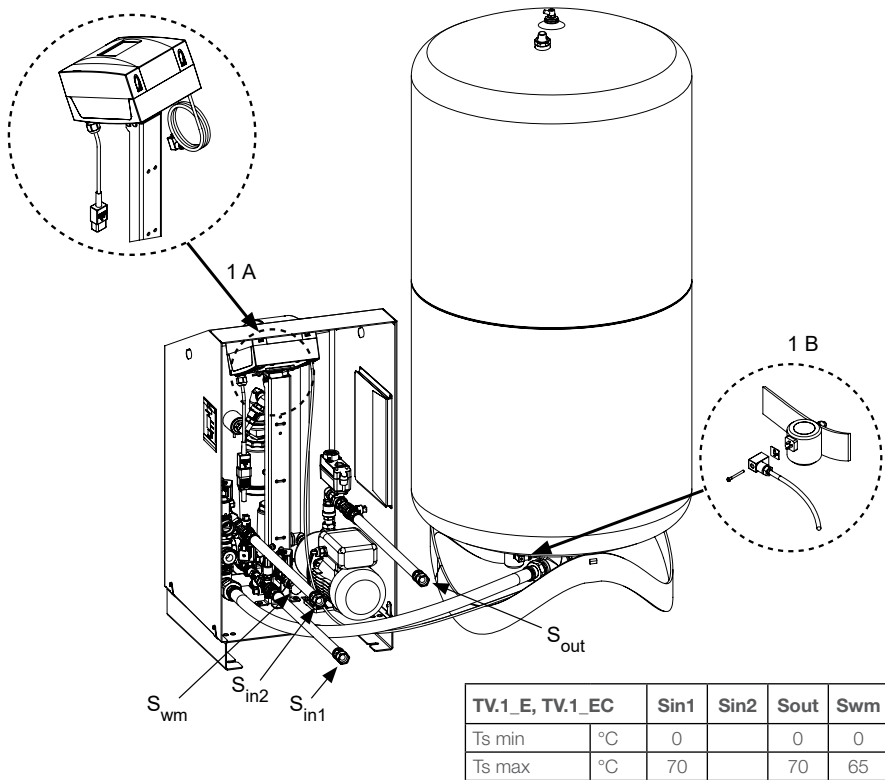
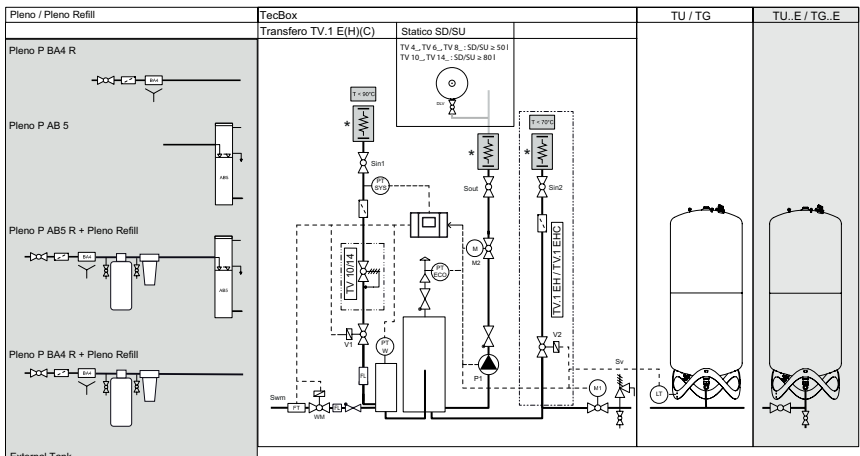

		TV_4	TV_6	TV_8	TV_10	TV_14
dpu min	bar	1	1,5	2	3,5	5,5
dpu max	bar	2,5	3,5	4,5	6,5	10

TV.1_E, TV.1_EC	Sin1	Sin2	Sout	Swm
Ts min	°C	0	0	0
Ts max	°C	70	70	65

TV.1_EH, TV.1_EHC		Sin1	Sin2	Sout	Swm
Ts min	°C	0	5	0	0
Ts max	°C	90	70	90	65



TV.2 E (C) (H)

Optional

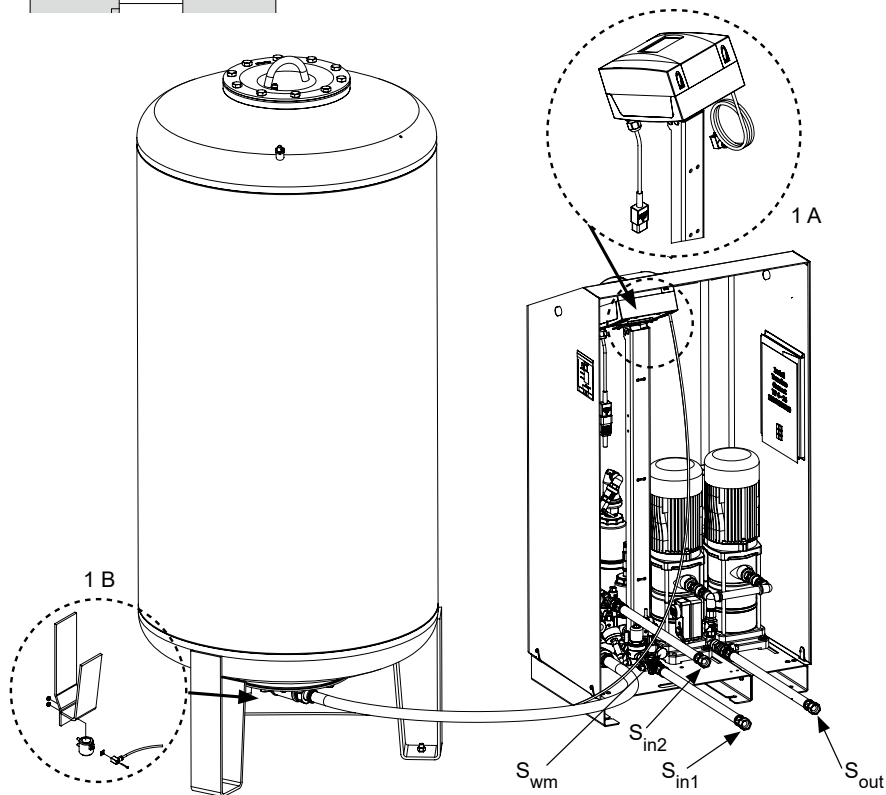
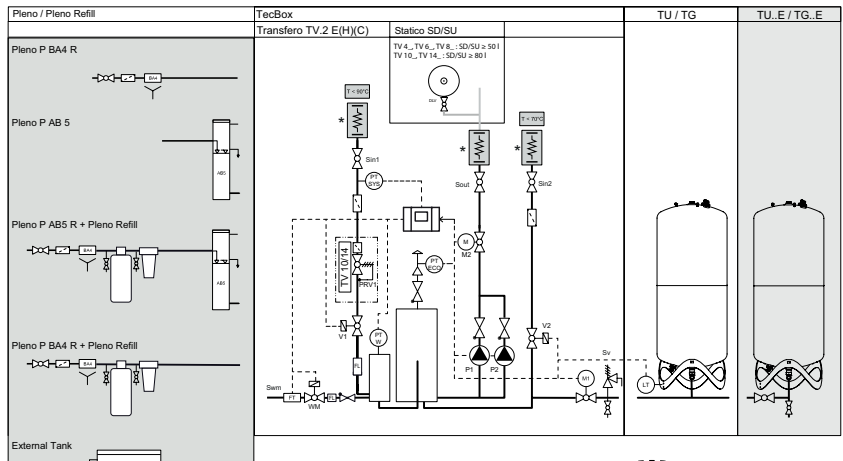

	TV_4	TV_6	TV_8	TV_10	TV_14
dpu min	1	1,5	2	3,5	5,5
dpu max	2,5	3,5	4,5	6,5	10

	TV.2_EH, TV.2_EHC	Sin1	Sin2	Sout	Swm
Ts min	°C	0	5	0	0
Ts max	°C	90	70	90	65



$tr \leq 70^\circ\text{C}$

## TV.1 E + Pleno BA4 R

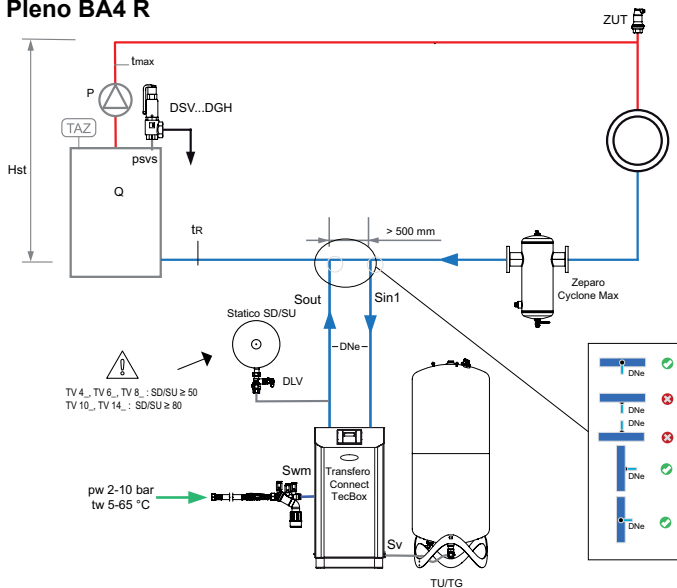

$tr \leq 70^\circ\text{C}$

## TV.1 E + Pleno AB5 R + Pleno Refill

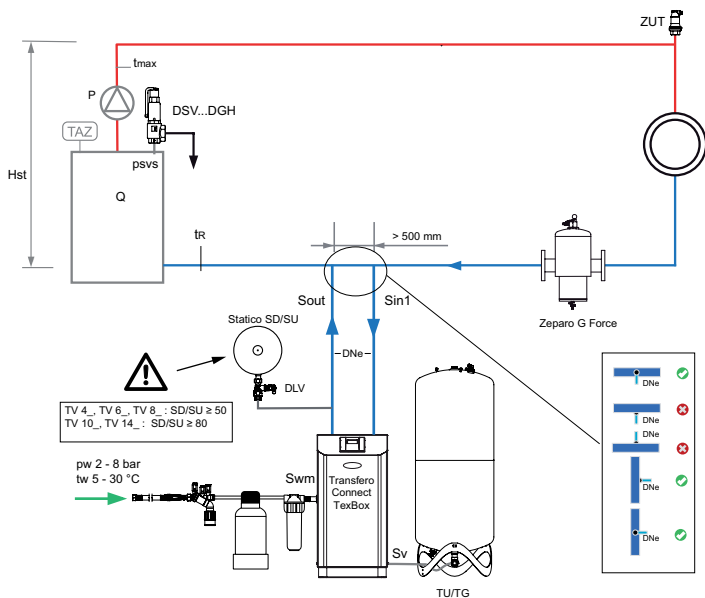

**70°C < tr ≤ 90°C**

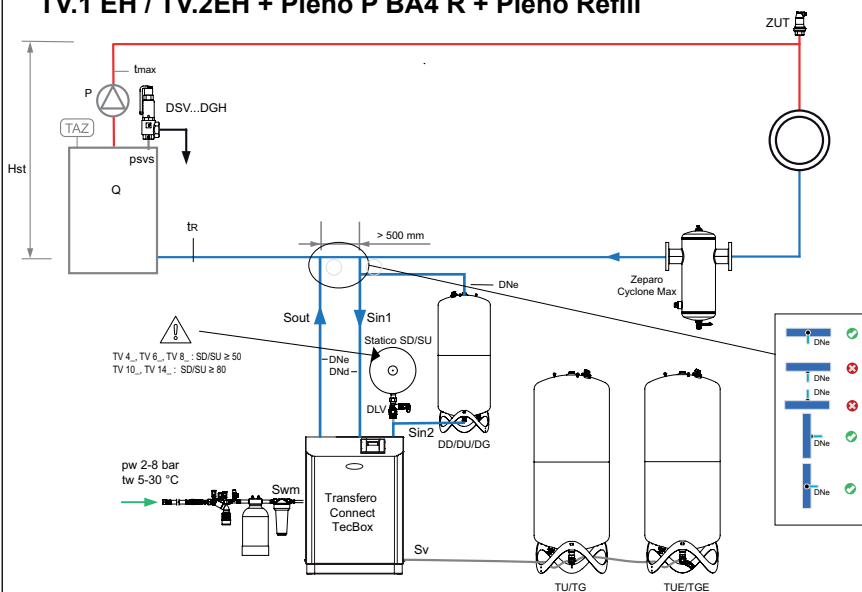
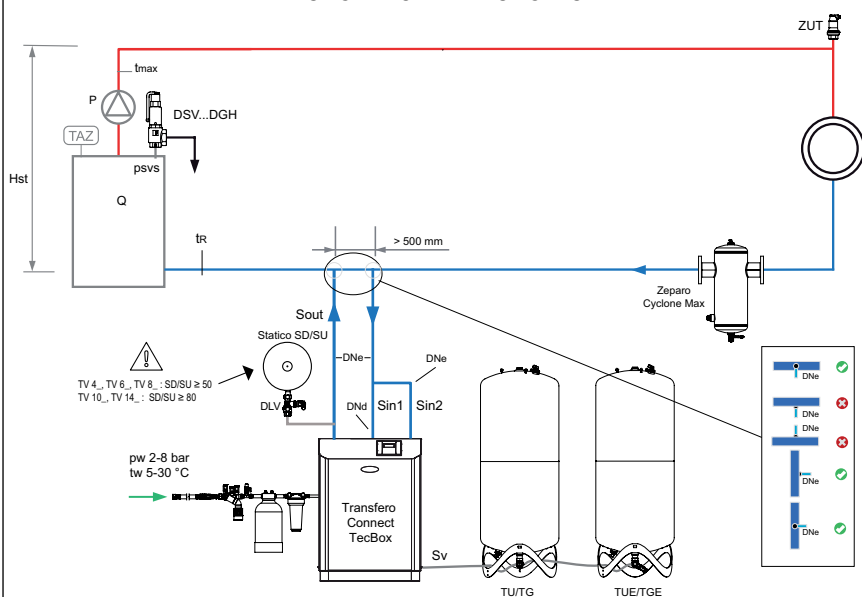
**TV.1 EH / TV.2EH + Pleno P BA4 R + Pleno Refill**| **tr** | **≤ 70°C** |
**TV.1 EH / TV.2EH + Pleno AB5 R + Pleno Refill**



$5^{\circ}\text{C} \leq tr \leq 70^{\circ}\text{C}$

## TV.1 EC + Pleno BA4 R + Pleno Refill

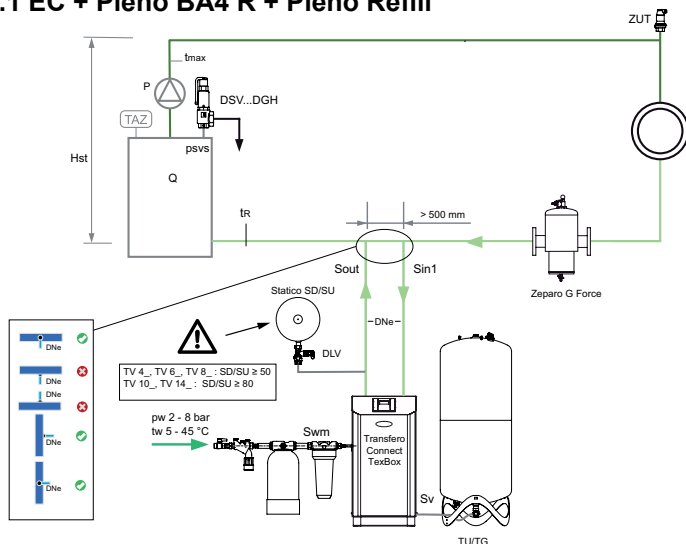

$0^{\circ}\text{C} \leq tr \leq 5^{\circ}\text{C}$

## TV.2 EHC + Pleno BA4 R

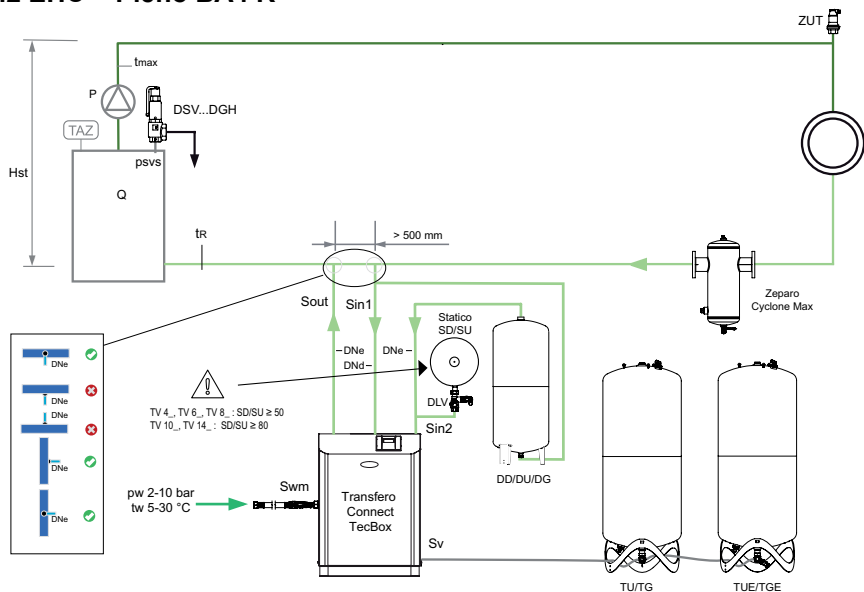



DNe

		TV_4.1	TV_4.1 H	TV_4.2 H	TV_6.1	TV_6.1 H	TV_6.2 H	TV_8.1	TV_8.1 H	TV_8.2 H	TV_10.1	TV_10.1 H	TV_10.2 H	TV_14.1	TV_14.1 H	TV_14.2 H
Length up to approx. 5 m	DNe	25	32	32	25	32	50   40	25	32	50   40	25	40   32	50   40	25	32	50   40
	Hst   m	all	all	all	all	all	< 18   ≥ 18	all	all	< 27   ≥ 27	all	< 29   ≥ 29	< 44   ≥ 44	all	all	< 61   ≥ 61
	DNd	25	25	25	25	25	25	25	25	25	25	25	25	25	25	25
Length up to approx. 10 m	DNe	25	32	50   40	25	40   32	50   40	25	40   32	50   40	25	40   32	50   40	25	32	50   40
	Hst   m	all	all	< 13   ≥ 13	all	< 23   ≥ 23	< 25   ≥ 25	all	< 24   ≥ 24	< 34   ≥ 34	all	< 40   ≥ 40	< 52   ≥ 52	all	all	< 80   ≥ 80
	DNd	25	25	25	25	25	25	25	25	25	25	25	25	25	25	25
Length up to approx. 30 m	DNe	32	40	50	32	50   40	65   50	32	50   40	65   50	32	50   40	65   50	32	40   32	65   50
	Hst   m	all	all	all	all	< 26   ≥ 26	< 22   ≥ 22	all	< 28   ≥ 28	< 30   ≥ 30	all	< 45   ≥ 45	< 48   ≥ 48	all	< 80   ≥ 80	< 70   ≥ 70
	DNd	32	32	32	32	32	32	32	32	32	32	32	32	32	32	32
	Hst   m	all	all	all	all	all	all	all	all	all	all	all	all	all	all	all

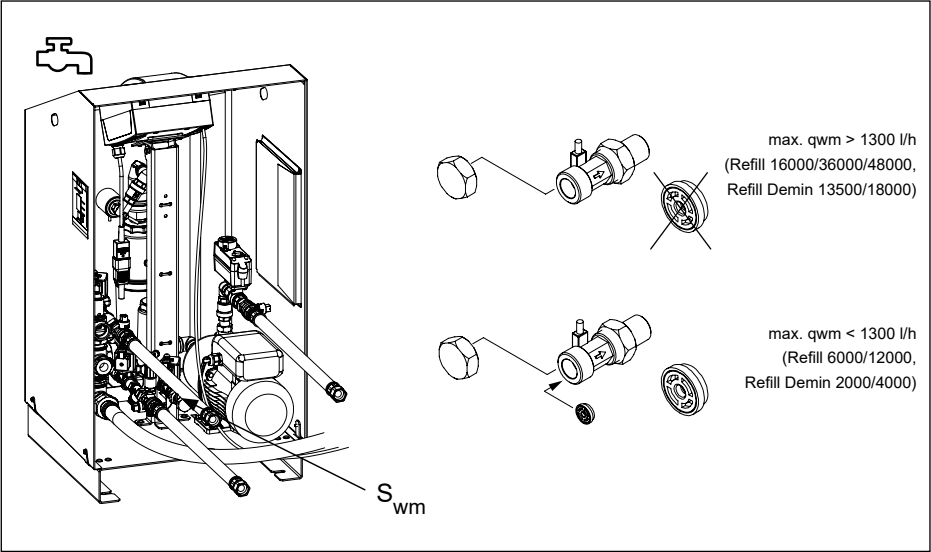
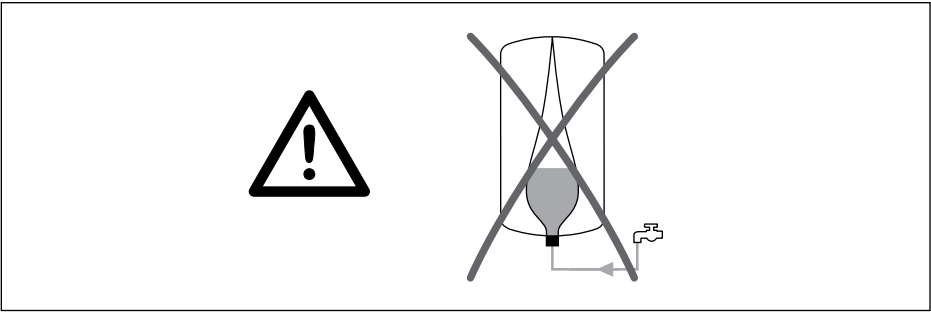

1 x 230V  
 T.1: 10A / 3 x 1,0 mm<sup>2</sup>  
 T.2: 16A / 3 x 1,5 mm<sup>2</sup>



#1-5

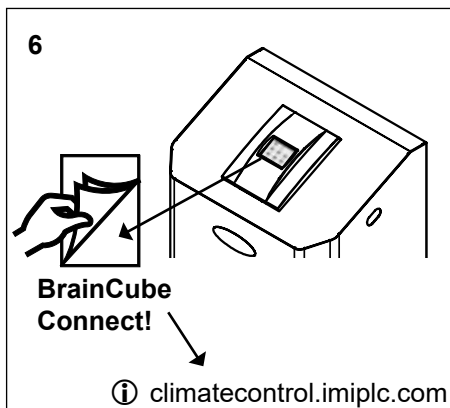
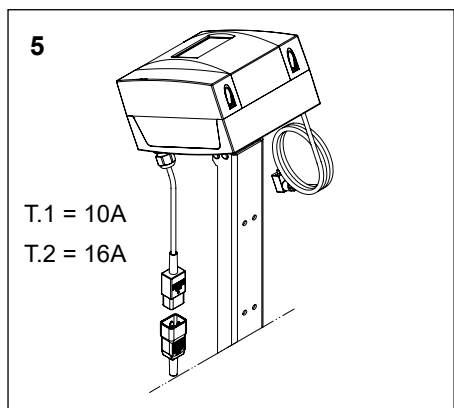
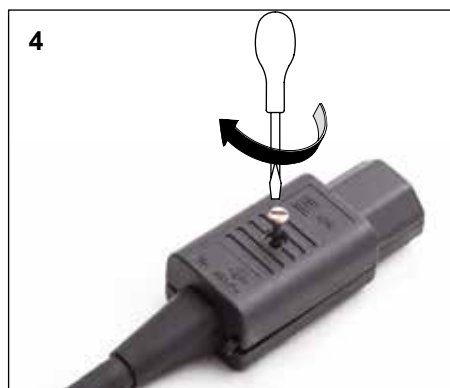
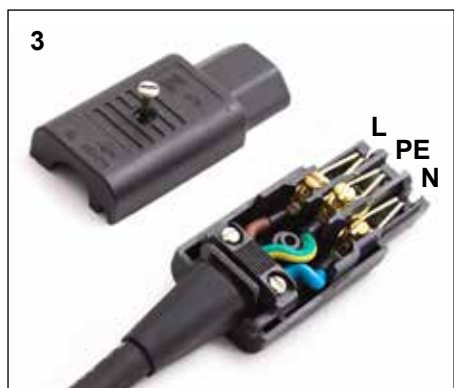
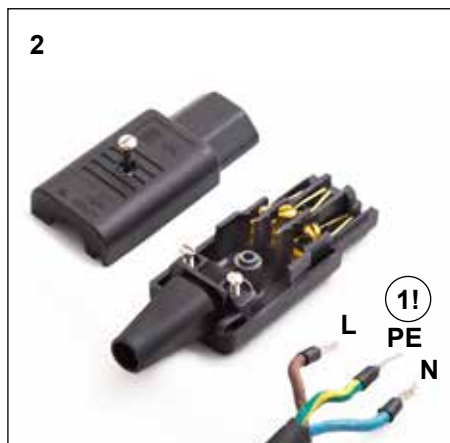
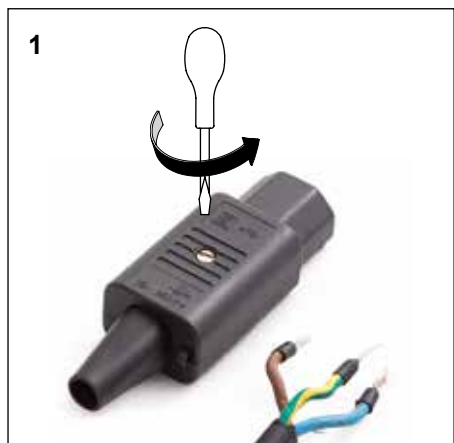

We reserve the right to introduce technical alterations without prior notice.



IMI Hydronic Engineering AG  
(Teil von Climate Control, einem Sektor von IMI plc)  
Mühlerainstrasse 26 • CH-4414 Füllinsdorf  
Tel. +41 (0)61 906 26 26

[climatecontrol.imiplc.com](http://climatecontrol.imiplc.com)