

Simply Vento V 2.1 S Vento Compact V 2.1 FE INSTALL

[illegible][illegible]

1

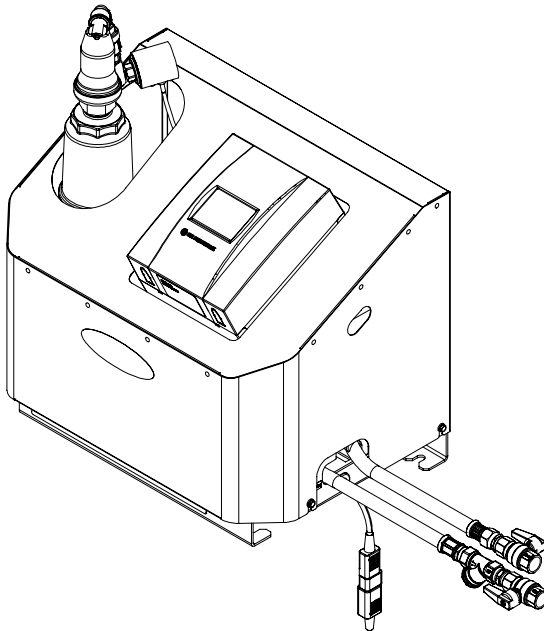
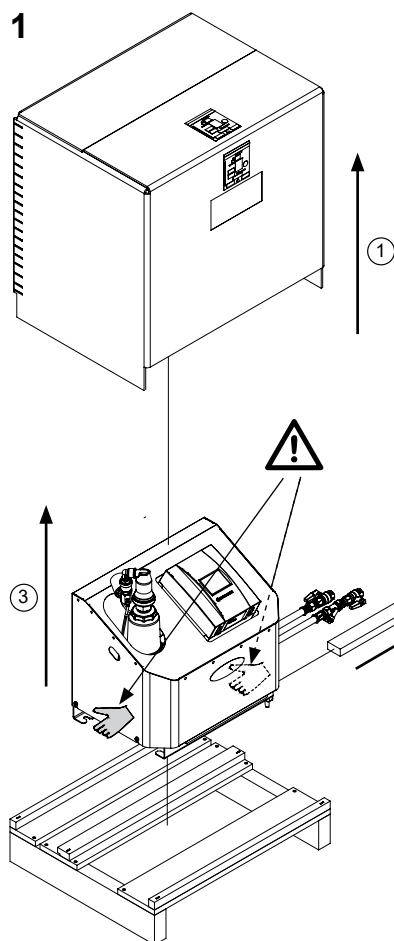

2

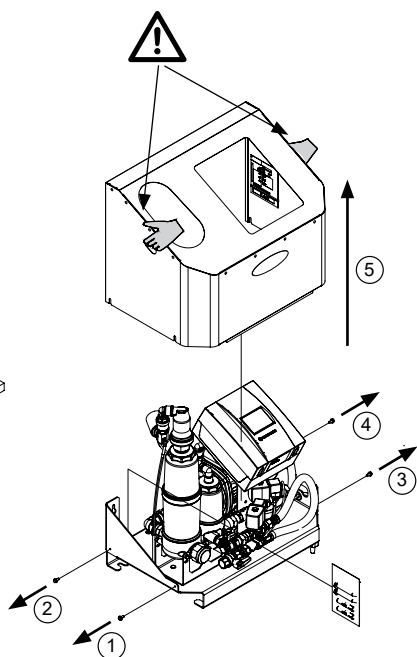

3

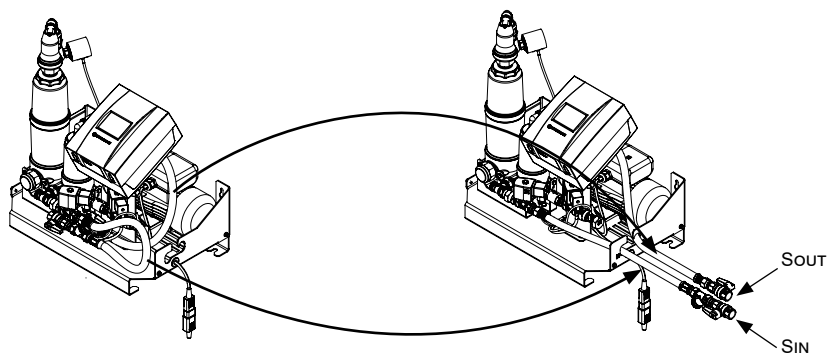

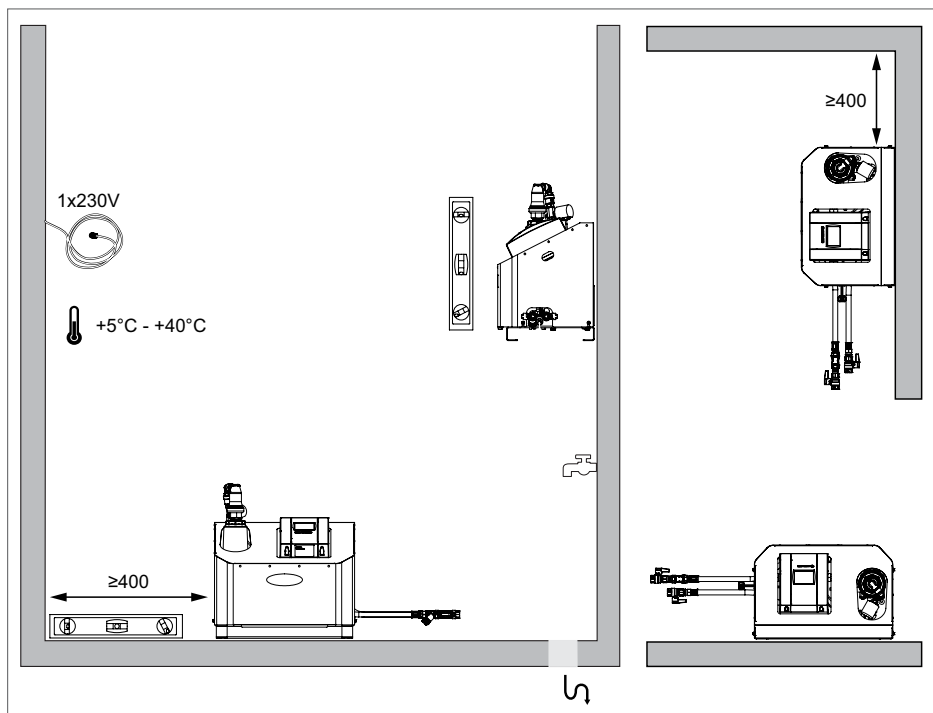

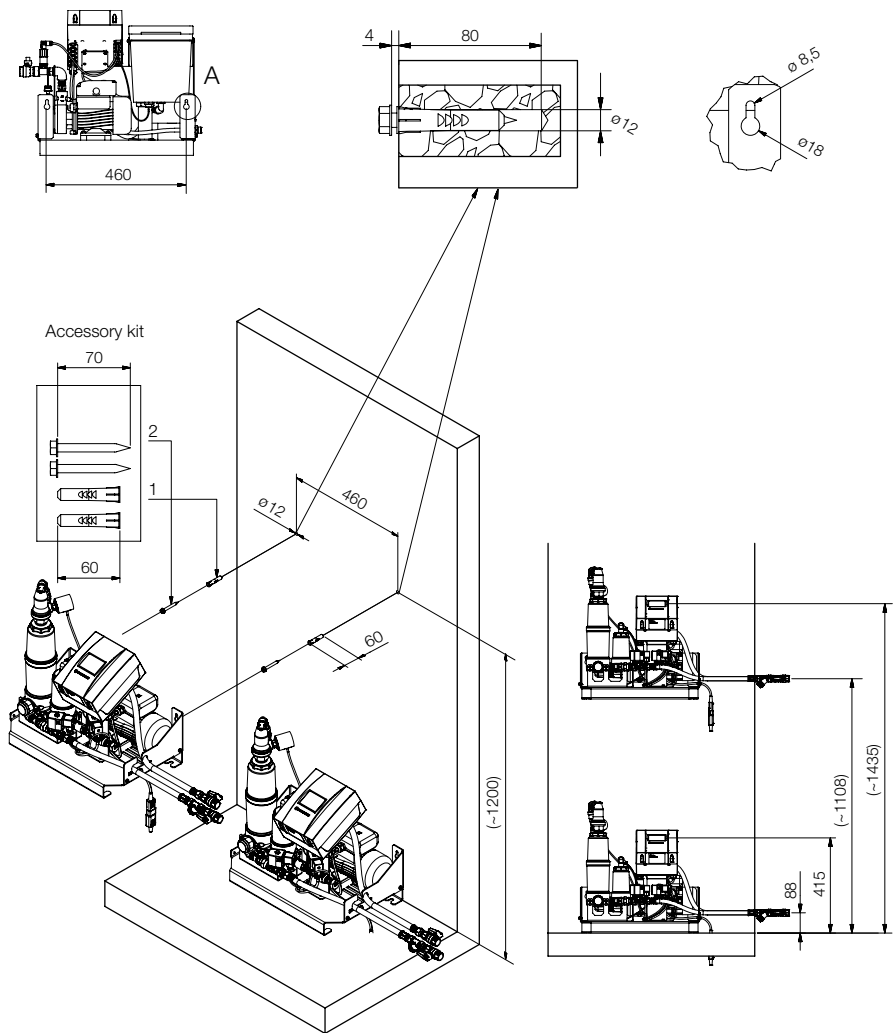
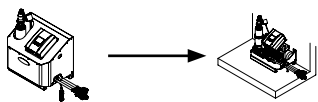

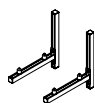

Option 30103230021



+

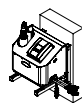
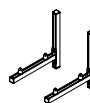

1

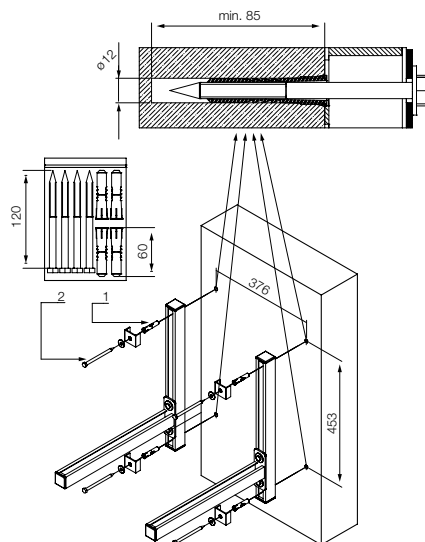

3

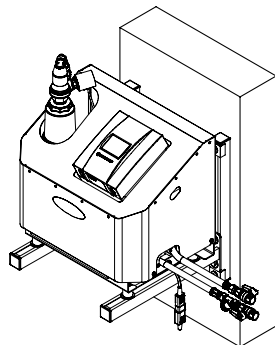

4

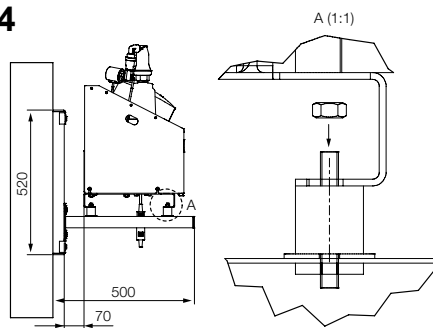

2

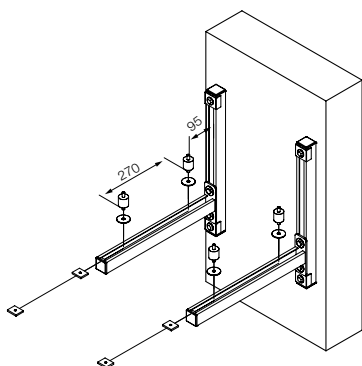

5

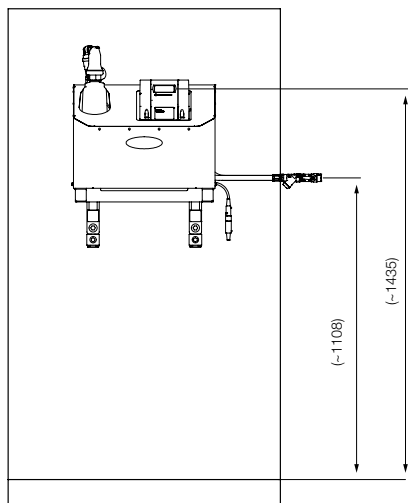

1

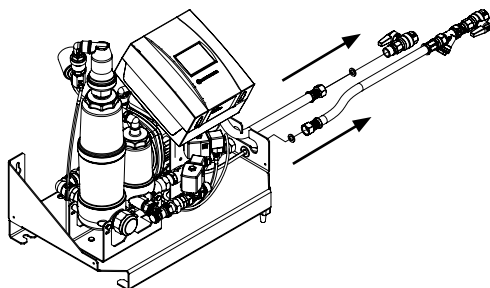

2

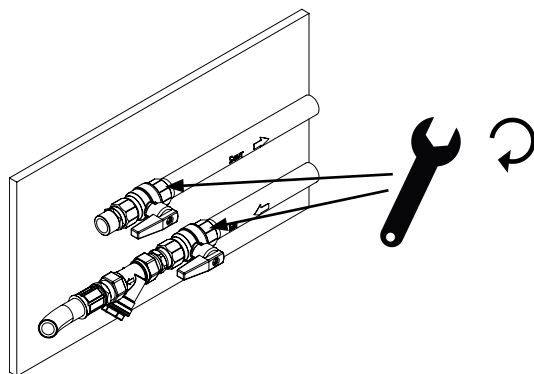

3

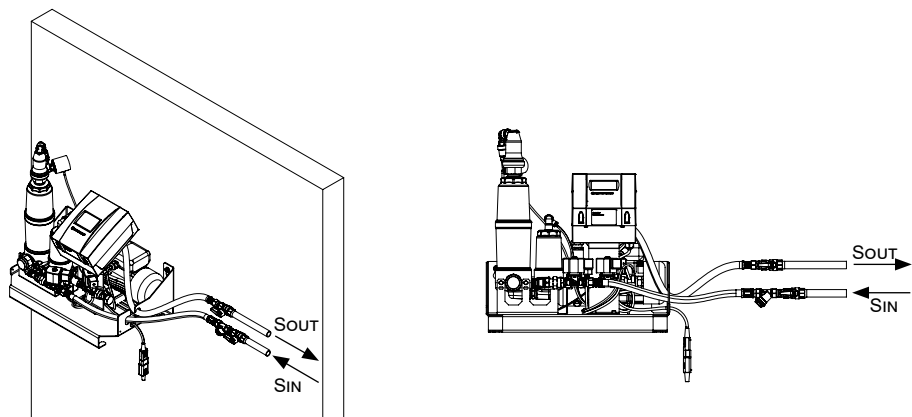

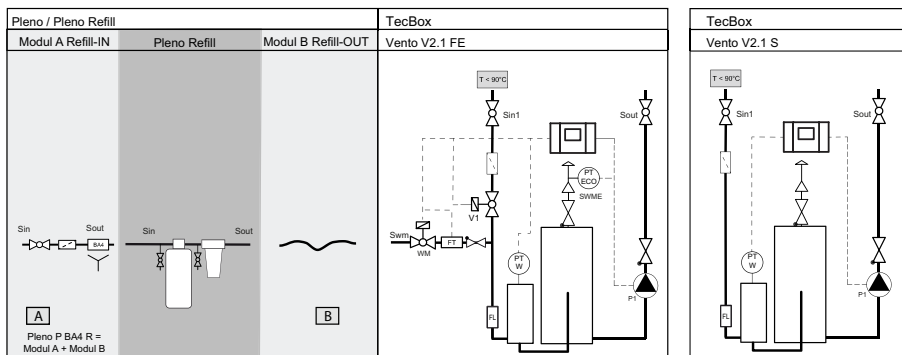

Optional

Vento V2.1 S

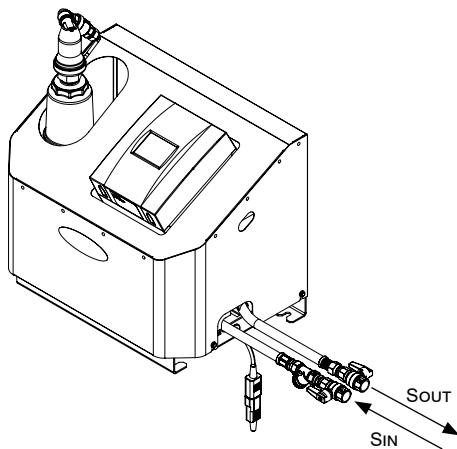

Vento V2.1 FE

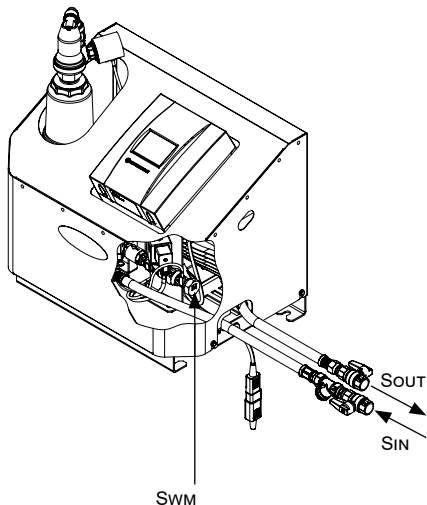

		V2.1 S	V2.1 FE
dpu min	bar	0,5	0,5
dpu max	bar	2,5	2,5

		Sin	Sout	Swm
Ts min	°C	0	0	0
Ts max	°C	90	90	65



$tr \leq 90^{\circ}\text{C}$

Vento V2.1 FE

**+
Pleno P BA4R**

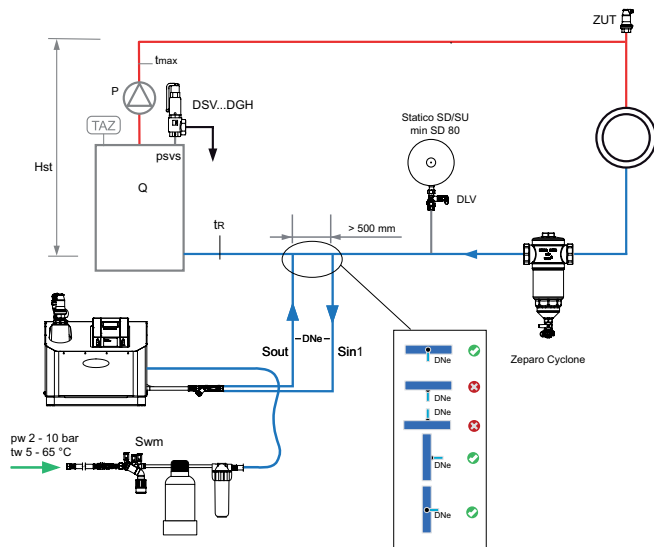

$tr \leq 90^{\circ}\text{C}$

Vento V2.1 S

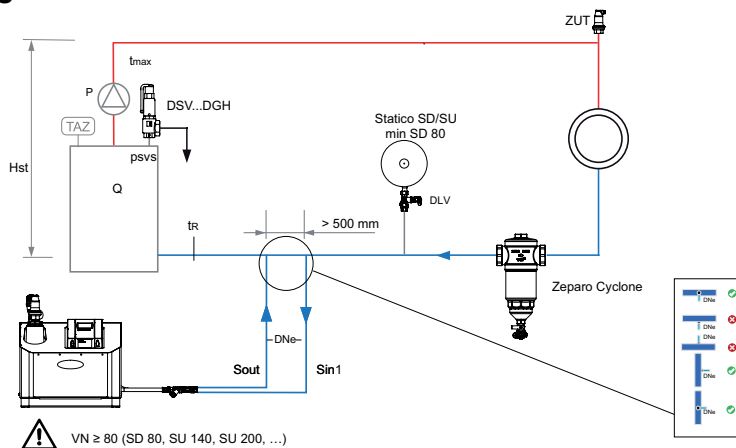

DNe

		V2.1 S	V2.1 FE
L max 10 m	DNe	25	25
L max 20 m	DNe	25	25
L max 30 m	DNe	32	32

230V/50 Hz
10A / 3 x 1,0 mm²



#1-5

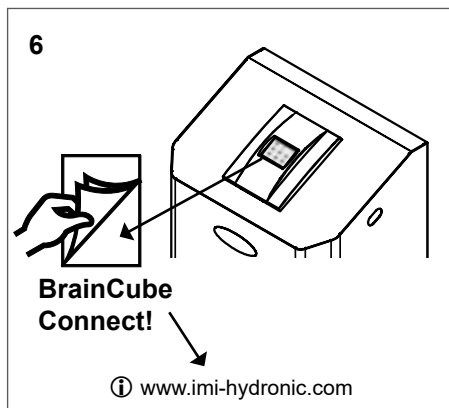
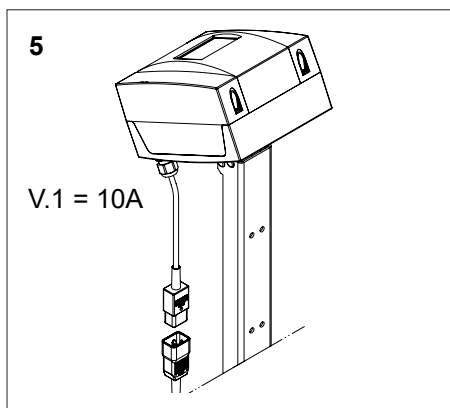
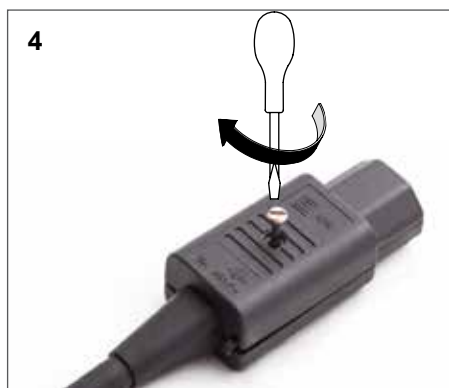
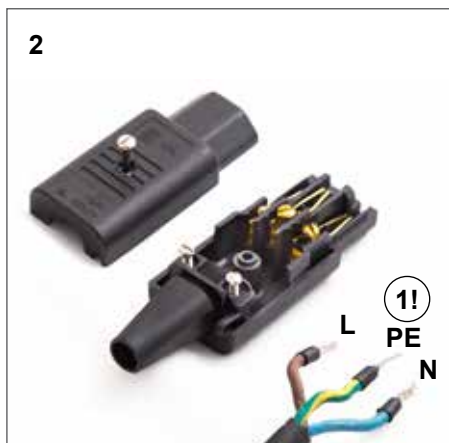
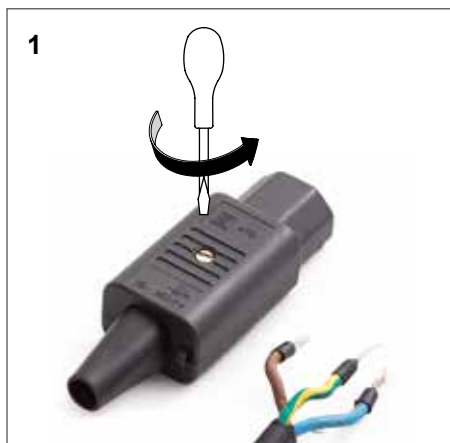

Vento V2.1 S / V2.1 FE

230V/50 Hz

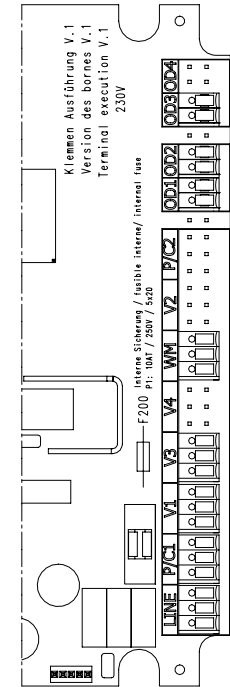
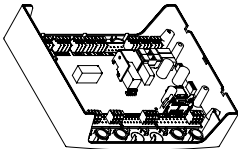

- V 2.1 S connect:
- P1 : Hauptpumpe / pompe principale / main pump
 - V1 : Überströmventil / Vanne de décharge / Spill valve
 - V3 : Nicht belegt / non utilisé / not used
 - WM : Nachspeiseseventil / Vanne d'appoint d'eau / Water make up valve

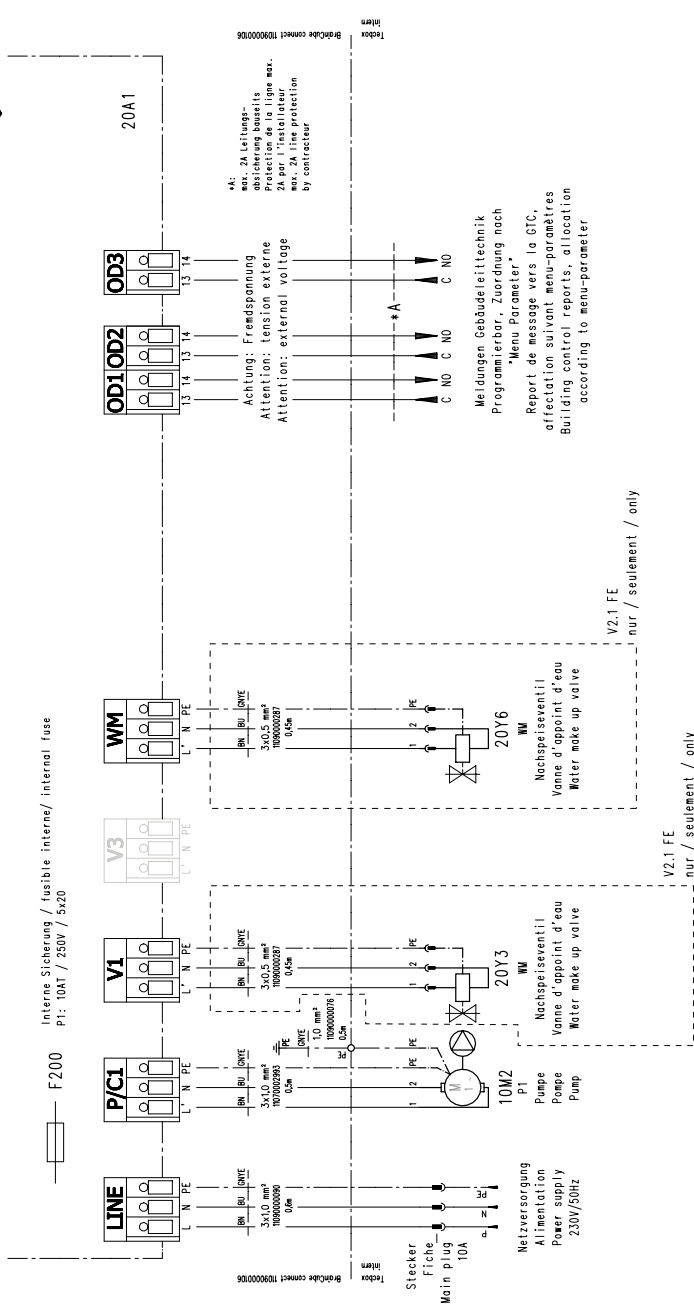

24V

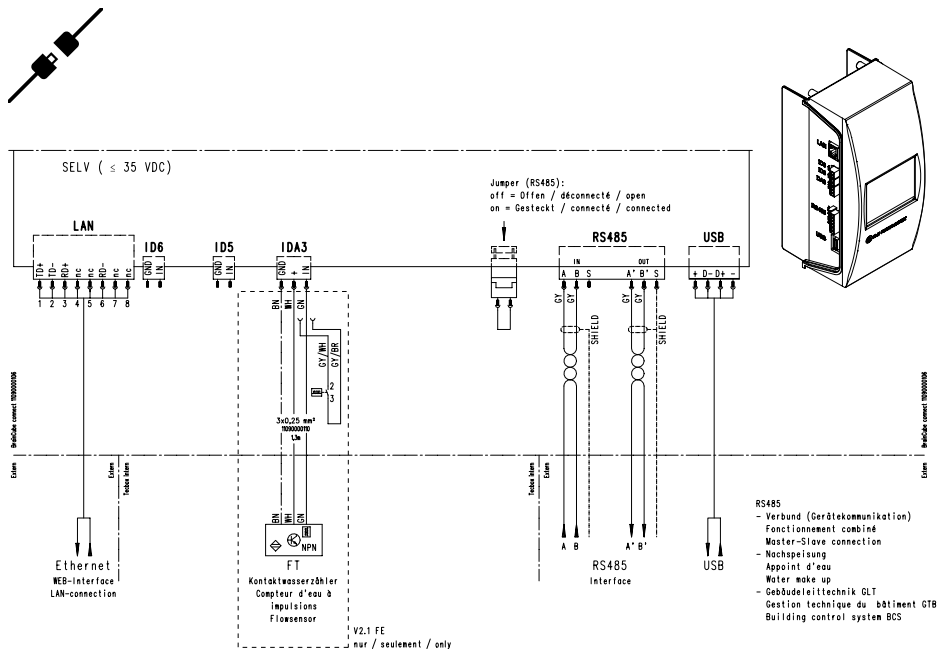

Vento

Compresso

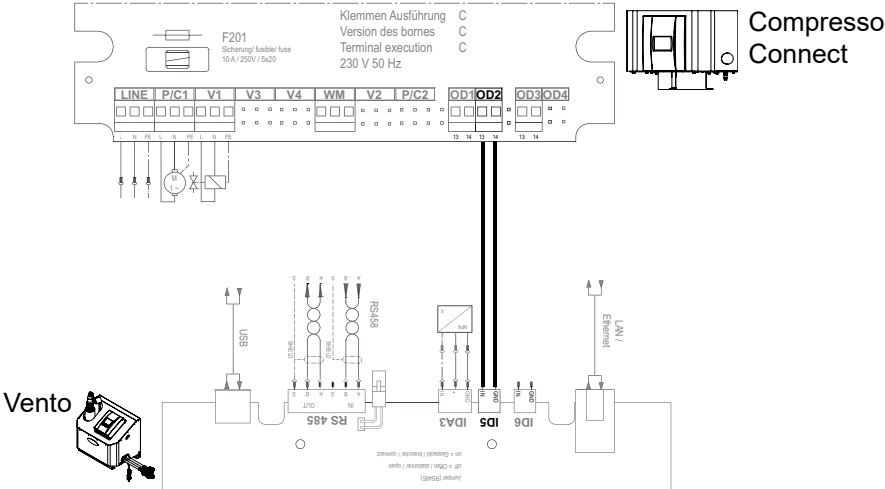
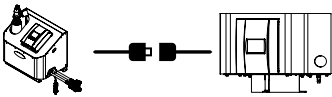
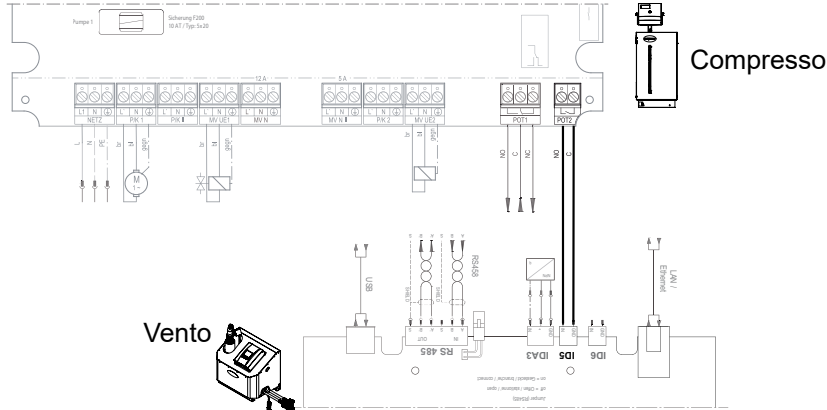
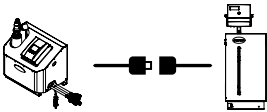

We reserve the right to introduce technical alterations without previous notice.



Hydronic Engineering

IMI Hydronic Engineering Switzerland AG

Mühlerainstrasse 26 • CH-4414 Füllinsdorf • Tel. +41 (0)61 906 26 26

www.imi-hydronic.com