

IMI TA

Trim

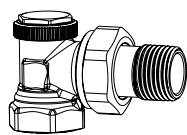

DN 10 50 009-110
DN 15 50 009-115
DN 20 50 009-120

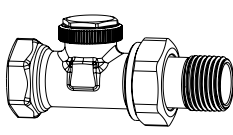

DN 10 50 005-110
DN 15 50 005-115
DN 20 50 005-120

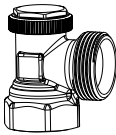

DN 10 50 009-610
DN 15 50 009-615
DN 20 50 009-620

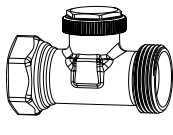

DN 10 50 005-610
DN 15 50 005-615
DN 20 50 005-620

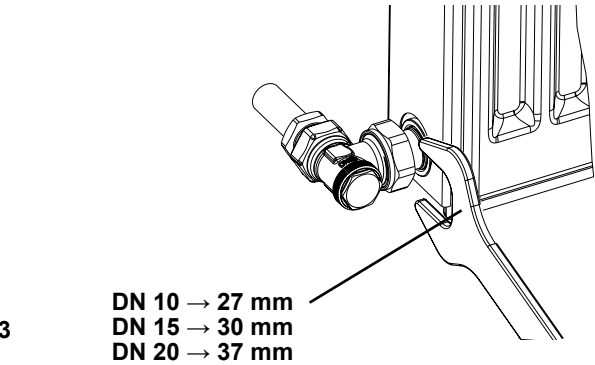
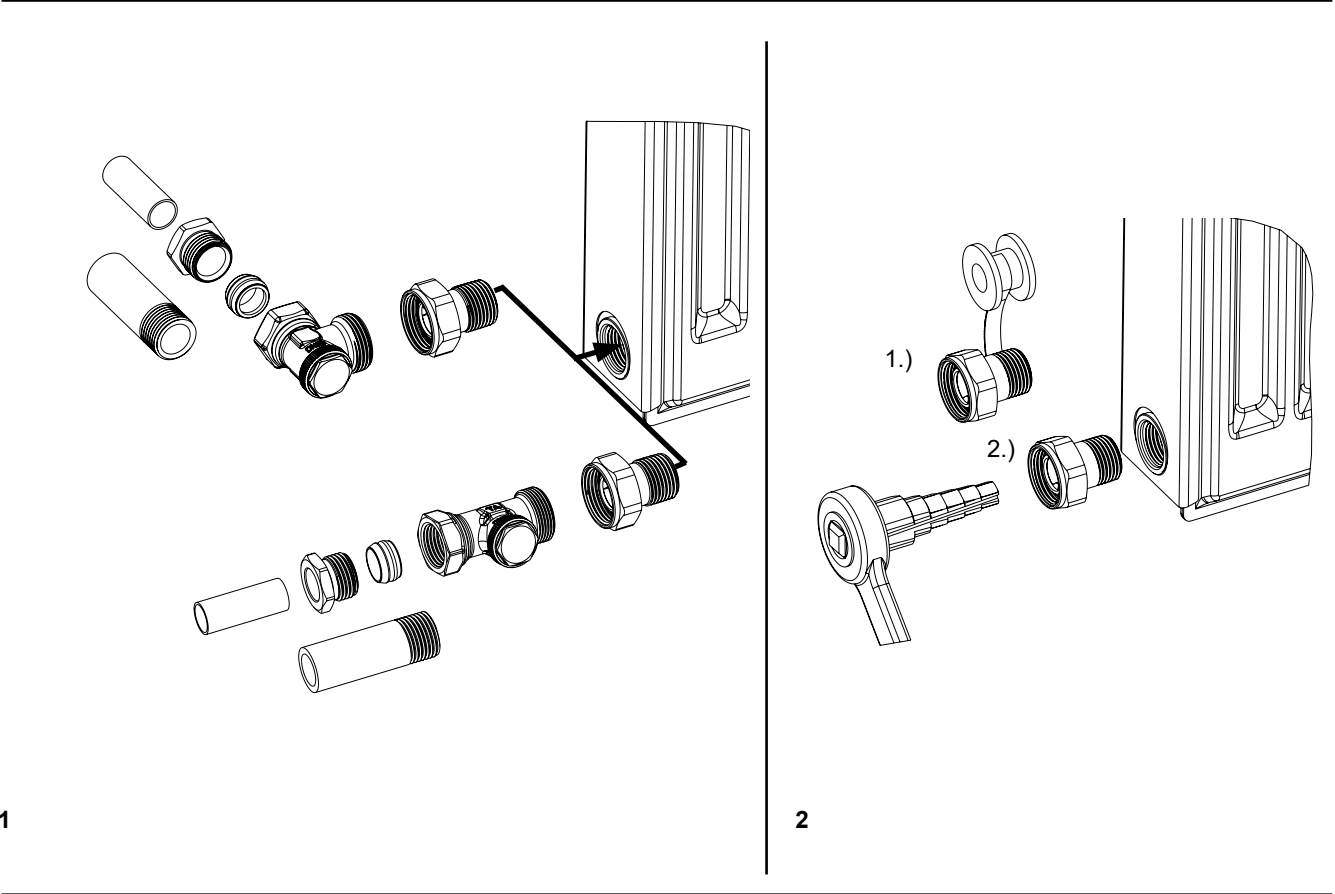

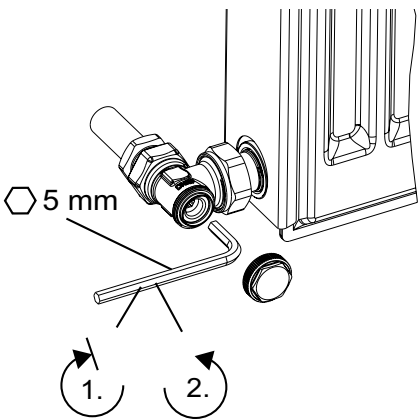
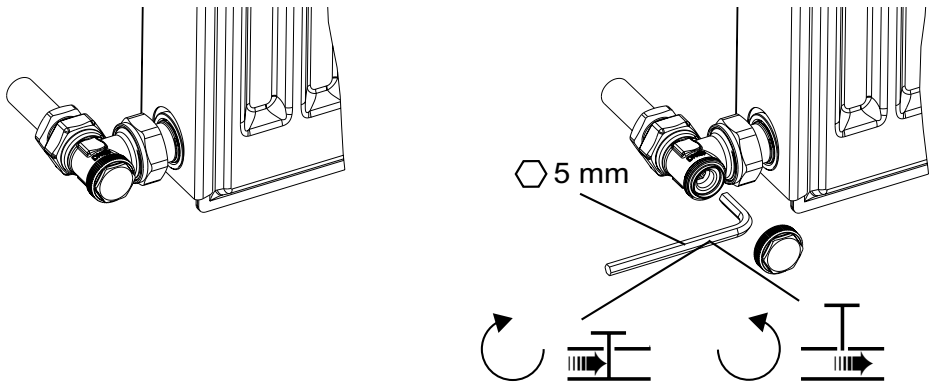

DN 10

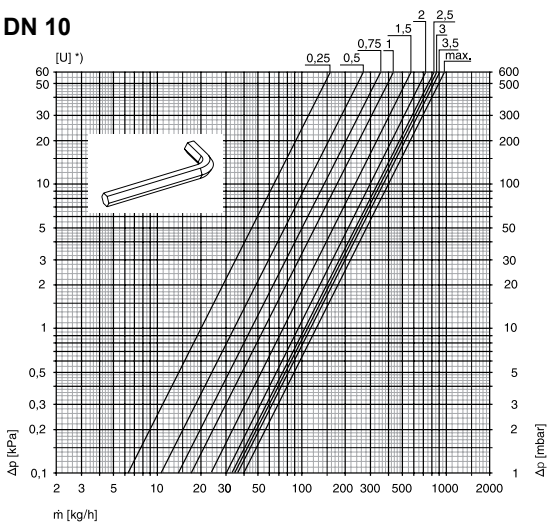

DN 20

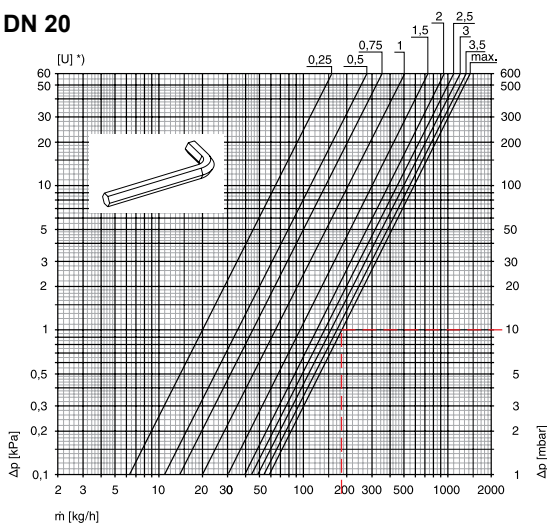

DN 15

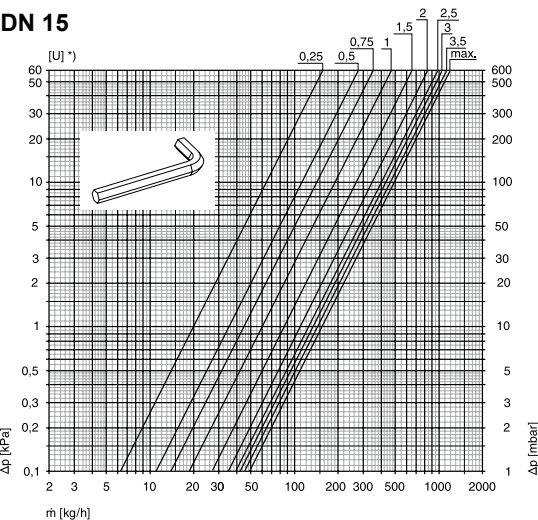

DN	Kv									Kvs
	<div>U *)<div></div></div>									
	0,25	0,5	0,75	1	1,5	2	2,5	3	3,5	
10 (3/8")	0,20	0,35	0,45	0,55	0,75	0,95	1,05	1,10	1,15	1,25
15 (1/2")	0,20	0,35	0,45	0,60	0,85	1,10	1,25	1,35	1,45	1,55
20 (3/4")	0,20	0,35	0,45	0,65	0,95	1,20	1,40	1,55	1,70	1,85

Kv/Kvs = m³/h at a pressure drop of 1 bar.

We reserve the right to introduce technical alterations without previous notice.