

IMI Heimeier

Regutec F

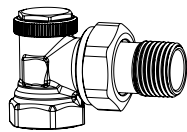

DN 10 0331-01.  
DN 15 0331-02.  
DN 20 0331-03.

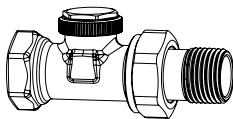

DN 10 0332-01.  
DN 15 0332-02.  
DN 20 0332-03.

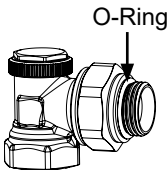

DN 15 0331-22.

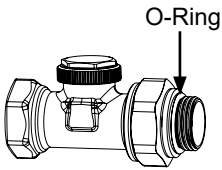

DN 15 0332-22.

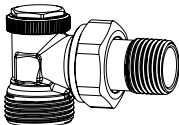

DN 15 0333-02.

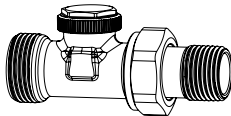

DN 15 0334-02.

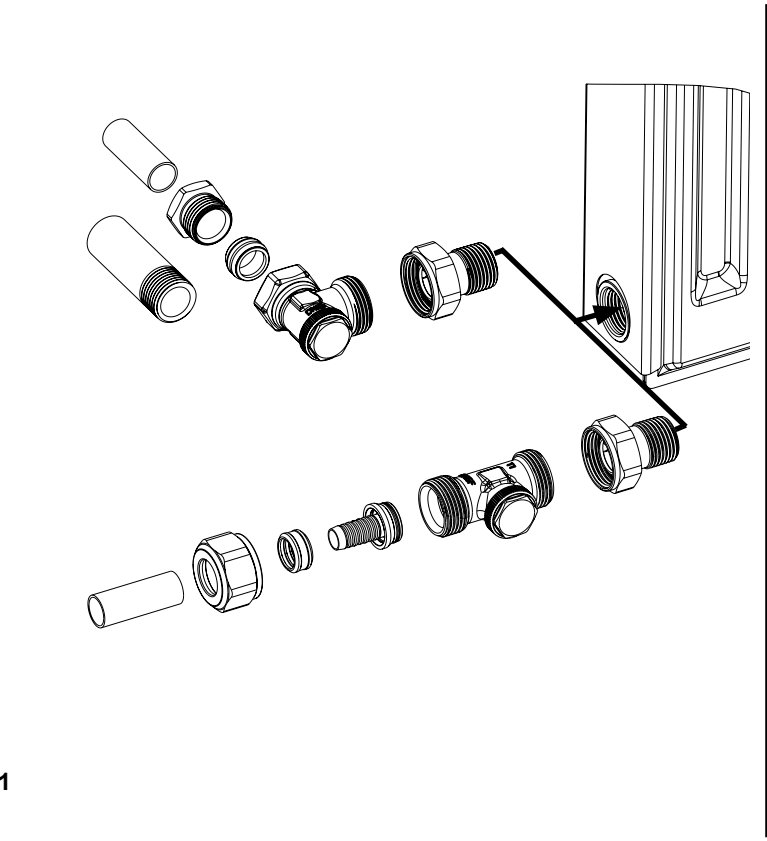

1

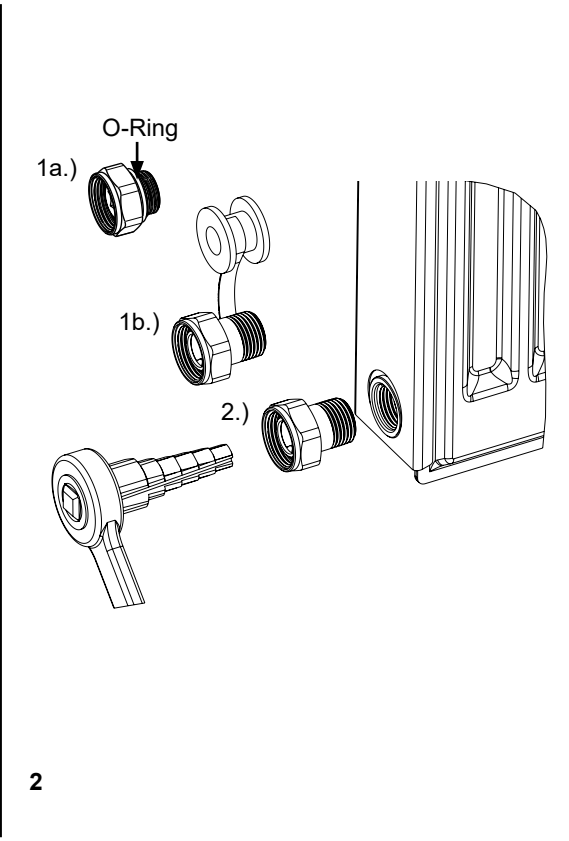

2

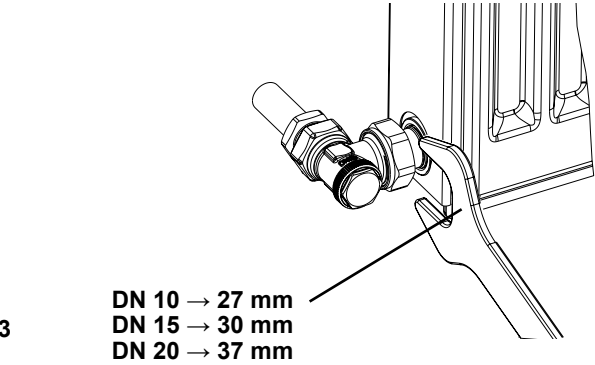

3

DN 10 → 27 mm  
DN 15 → 30 mm  
DN 20 → 37 mm

We reserve the right to introduce technical alterations without previous notice.

# IMI Heimeier

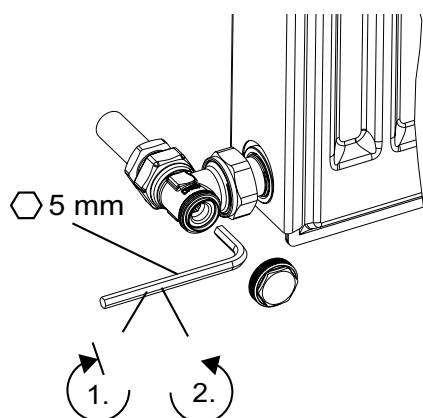
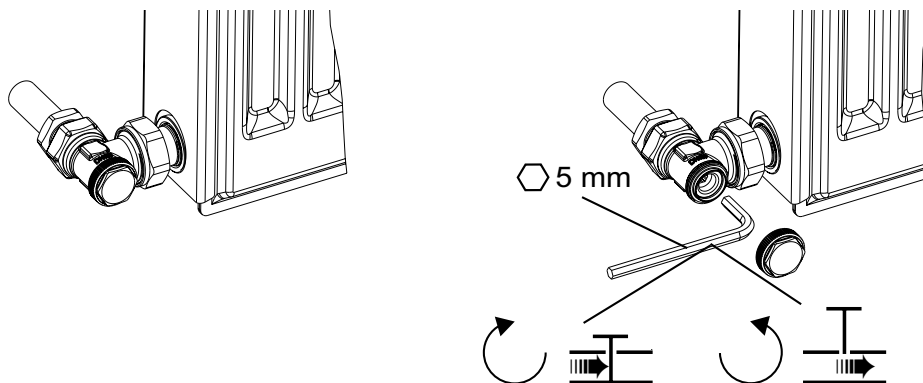

DN 10

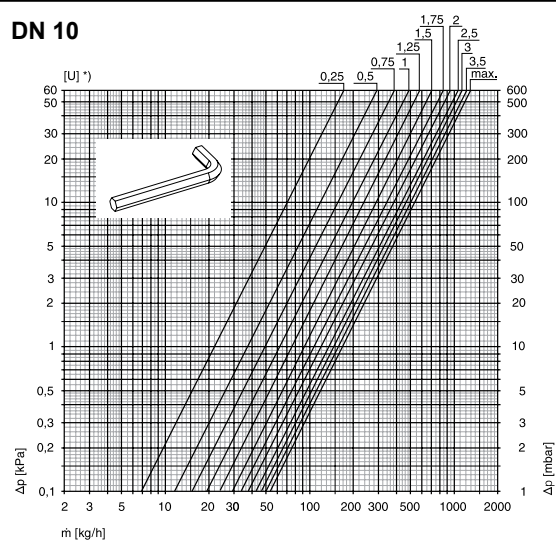

DN 15

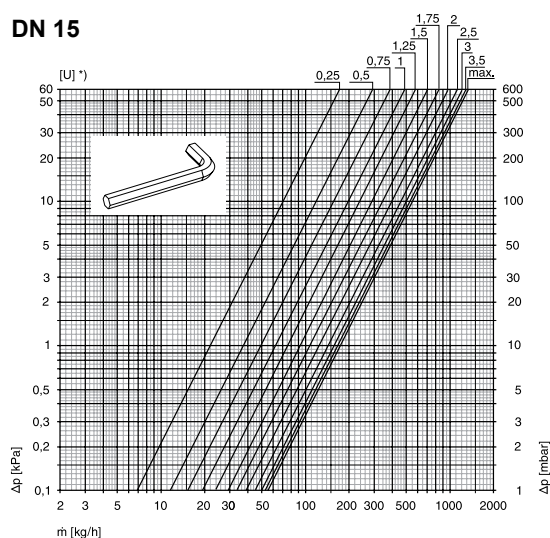

DN 20

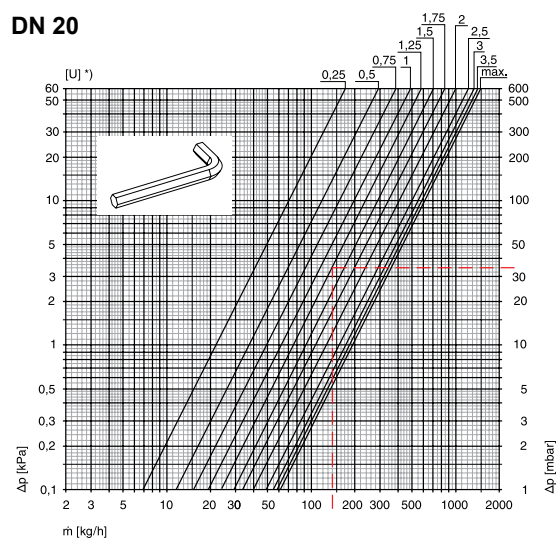

DN	<div> <b>Kv</b>  <b>U *)</b> </div>									<b>Kvs</b>
	0,25	0,5	1	1,5	2	2,5	3	3,5		
10 (3/8")	0,22	0,37	0,62	0,92	1,19	1,36	1,47	1,58		1,68
15 (1/2")	0,22	0,37	0,62	0,92	1,22	1,43	1,57	1,68		1,74
20 (3/4")	0,22	0,37	0,62	0,92	1,27	1,55	1,72	1,85		1,93

Kv/Kvs = m<sup>3</sup>/h at a pressure drop of 1 bar.