

IMI Heimeier Kit Hydrocâblé

Equerre / Angle / Eck

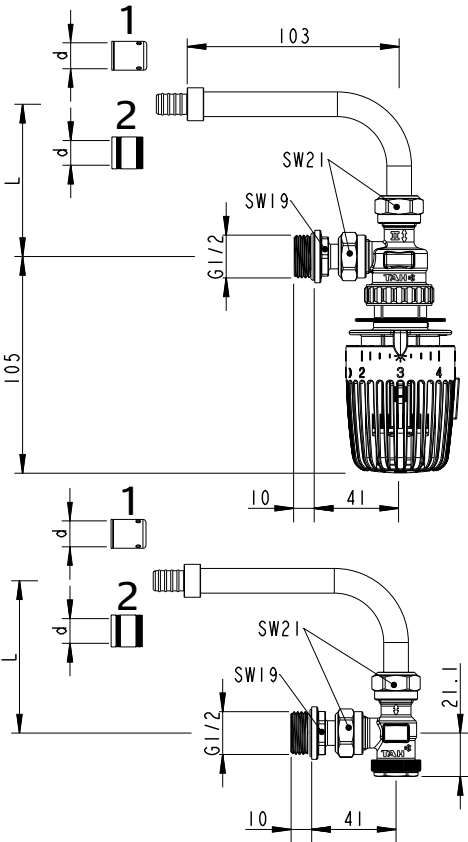

Equerre inversée / Axial / Axial

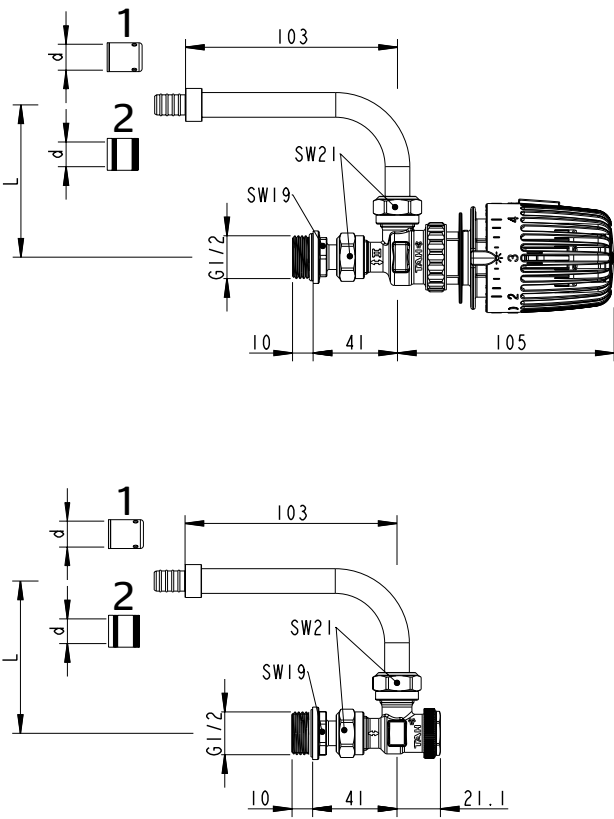

- ① Kit Hydrocâblé SERT avec raccords à sertir
- ① Kit Hydrocâblé SERT with press sleeve
- ① Kit Hydrocâblé SERT mit Presshülse

No d'article Article No. Artikel-Nr.	L	d Ø tube d Ø pipe d Ø Rohr
9690-49.000	75	12 x 1,1
9690-50.000	45	12 x 1,1

- ② Kit Hydrocâblé GLIS avec raccords à glissement
- ② Kit Hydrocâblé GLIS with sliding sleeve
- ② Kit Hydrocâblé GLIS mit Schiebehülse

No d'article Article No. Artikel-Nr.	L	d Ø tube d Ø pipe d Ø Rohr
9690-47.000	75	12 x 1,1
9690-48.000	45	12 x 1,1

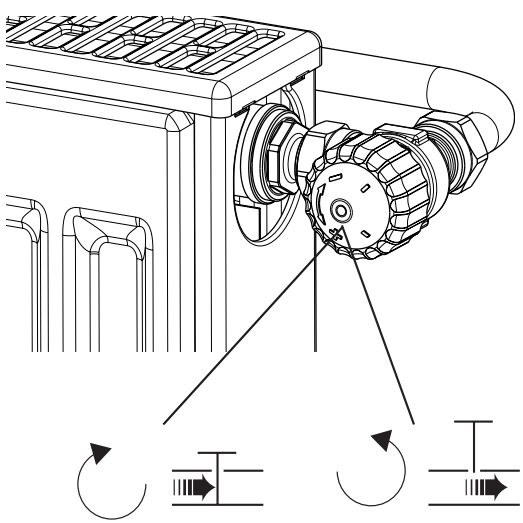
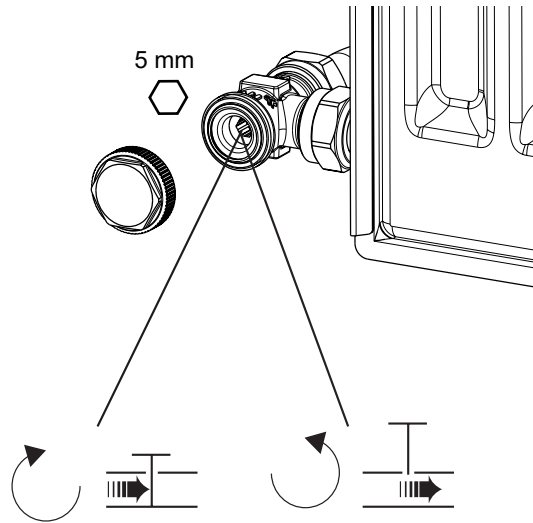

Equerre / Angle / Eck

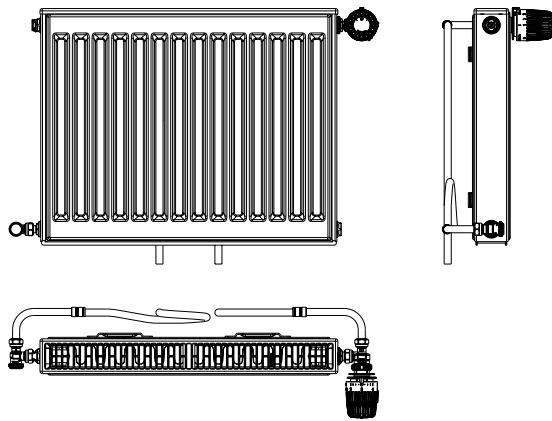

Equerre inversée / Axial / Axial

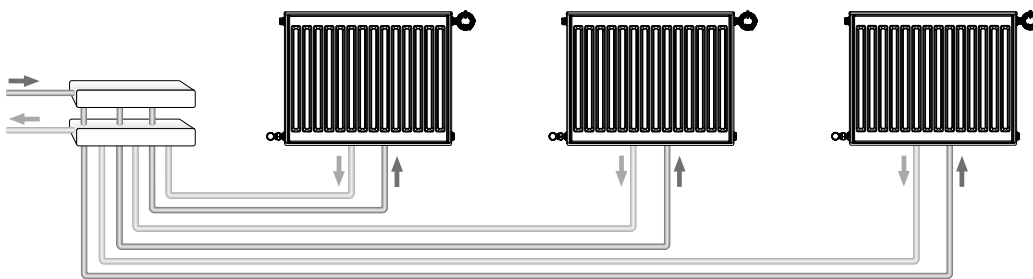
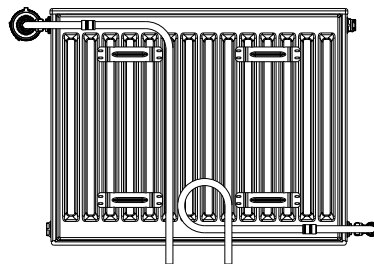

Diagramme, corp de robinet avec tête thermostatique
Diagram, valve body with thermostatic head
Diagramm, Ventilunterteil mit Thermostat-Kopf

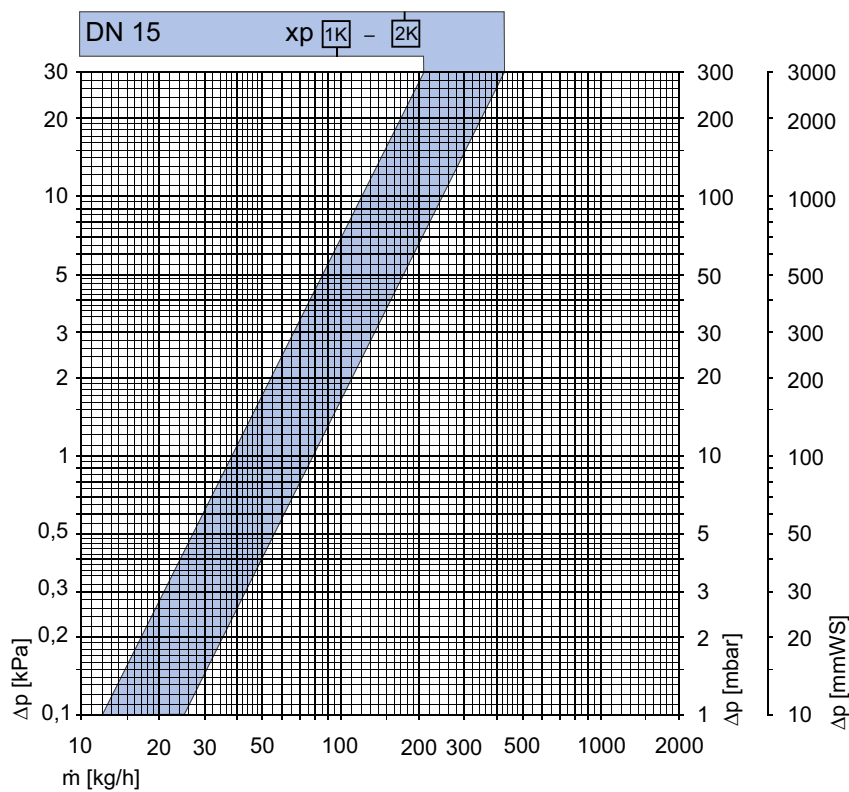

Kv	Ecart de réglage P-band Regeldifferenz		Kvs	Pression différentielle admiss. permettant encore de fermer le robinet Permitted differential pressure, during which the valve is kept closed Zulässiger Differenzdruck, bei dem das Ventil noch geschlossen wird	
	1,0	1,5	2,0	Th.-head	EMO T/TM EMOtec/NC TA-TRI TA-Slider 160
xp [K]			Angle	Δp [bar]	3,50
DN 15 (1/2")			2,00	1,00	

Kv/Kvs = débit en m³/h pour une perte de charge de 1 bar.
Kv/Kvs = m³/h at a pressure drop of 1 bar.
Kv/Kvs = m³/h bei einem Druckverlust von 1 bar.

We reserve the right to introduce technical alterations without previous notice.