

308 970-21
04.2020

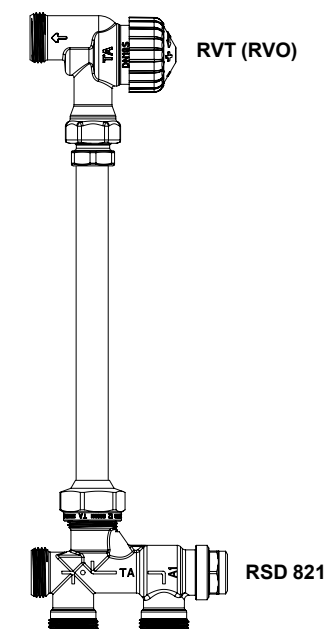

IMI TA

Flowrett/RSD 821 1-pipe



*We reserve the right to introduce technical alterations
without previous notice.*



climatecontrol.imiplc.com

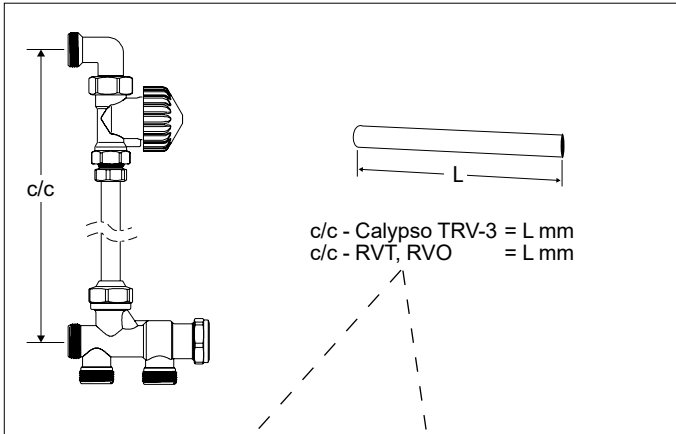
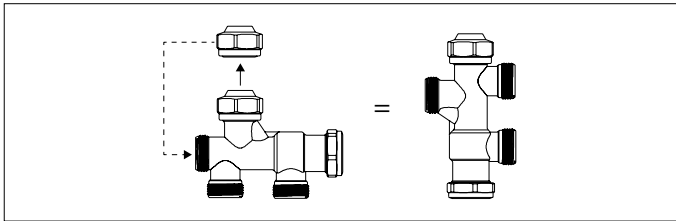
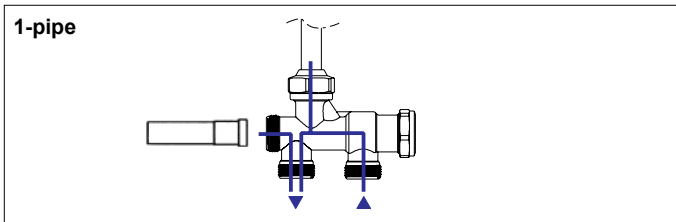

DN 10			
Calypso TRV-3	-80 mm	-43 mm	✓
RVT, RVO	—	-36 mm	—

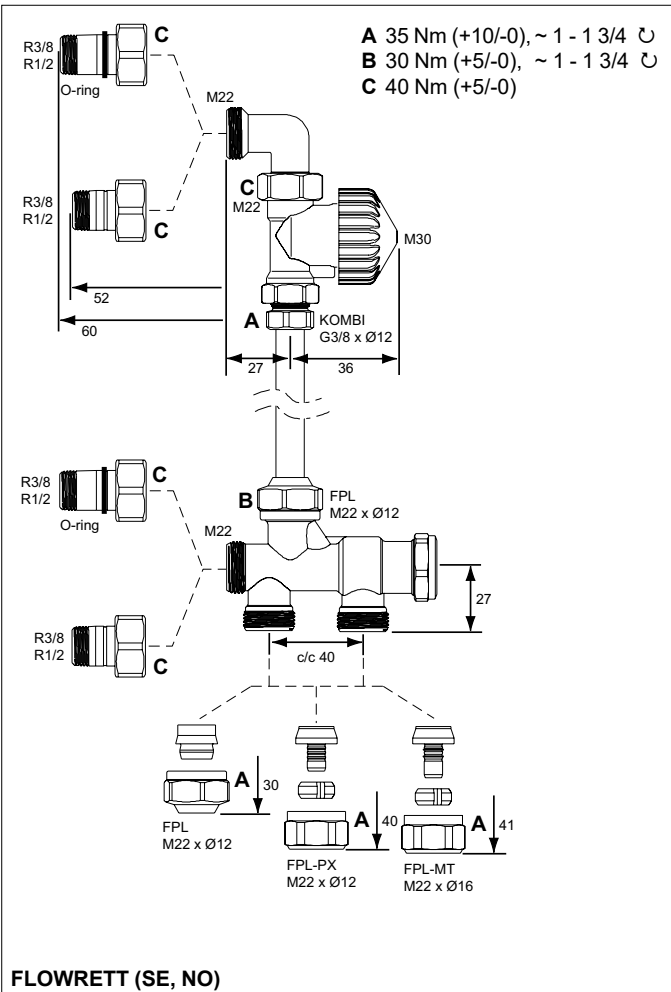

FLOWRETT (SE, NO)

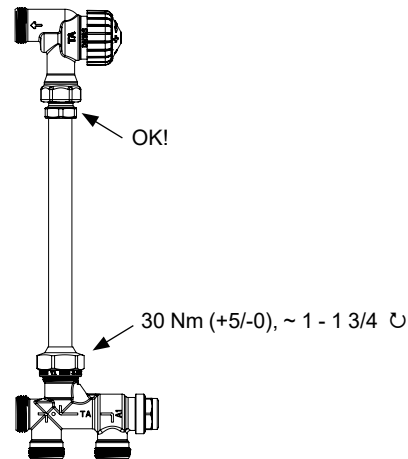

RSD 821

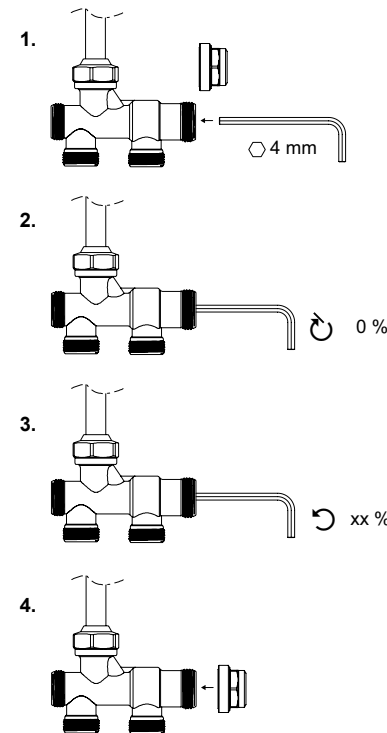

FLOWRETT (RSD 821) – RVT						
%	0	10	20	30	40	-
KvΔT2K	0,9	0,95	1,1	1,15	1,25	-
No. ⚙	**	2	2,75	3,5	*	-
FLOWRETT (RSD 821) – RVO						
%	0	10	20	30	40	50
Kv	0,90	1,0	1,1	1,2	1,45	1,5
No. ⚙	**	2	2,75	3,25	5,25	*

*) Fullt öppen, Helt åpen, Täysin auki, Fully open

**) Stängd, Stengt, Suljettu, Closed