

Climate
Control

IMI TA

TA 900 iSi



Ball valves

Ball valve – DN 10-50

TA 900 iSi

Soft-sealing for complete ease-of-use, the TA 900 iSi ball valve is suitable for use in heating, cooling and tap water systems. KOMBI connections enable smooth installation.

Key features

Soft-sealing

For optimum manoueverability.

Removable lid

For straightforward maintenance.

AMETAL®

Dezincification resistant alloy that guarantees a longer valve lifetime and lowers the risk of leakage.



Technical description

Applications:

Heating and cooling systems
Tapwater systems
Process systems where the media does not affect the incoming material.

Function:

Shut-off

Dimensions:

DN 10-50

Pressure class:

PN 16

Temperature:

58 940:

Max. working temperature: 120°C

Min. working temperature: -20°C

58 950:

Max. working temperature: 90°C

Min. working temperature: -20°C

Material:

Valve body: Die cast AMETAL®

Ball: Chrome plated AMETAL®, double nickel

Cover screws: Stainless steel (The valve has cover screws for DN 32-50, DN 10-25 has a threaded top section)

Seat elements and O-rings: 58 940:

EPDM rubber, 58 950: Nitrile rubber

Handle: Glass fibre re-inforced polyamid plastic

AMETAL® is the dezincification resistant alloy of IMI

Surface treatment:

Nickel plated

Marking:

TA, DR, DN, PN

Approval:

Approved for tapwater systems (max. 95°C) by RISE Certification, Sweden.

For domestic water and water with antifreeze

EPDM rubber

Max. working temperature: 120°C

Min. working temperature: -20°C

Note! Not suitable for LPG or medical gases.

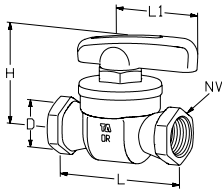

With red handle

DN	D	L	L1	H	NV	Kvs	EAN	Article No
10 ¹⁾	G3/8	59	45,5	48	22	6	7318793351708	58 940-110
15 ¹⁾	G1/2	74	45,5	52	27	12	7318793351807	58 940-115
20 ¹⁾	G3/4	80	59	63	32	30	7318793351906	58 940-120
25	Rp1	91	59	69	41	65	7318793352002	58 940-125
32	Rp1 1/4	110	79	87	50	90	7318793352101	58 940-132
40	Rp1 1/2	120	79	93	58	150	7318793352200	58 940-140
50	Rp2	141	79	99	70	220	7318793352309	58 940-150

1) Prepared for KOMBI. KOMBI compression couplings are ordered separately. For more information see KOMBI catalogue leaflet.

Kvs = m³/h at a pressure drop of 1 bar and fully open valve.

Universal

Nitrile rubber

Max. working temperature: 90°C

Min. working temperature: -20°C

Note! Not suitable for LPG or medical gases.

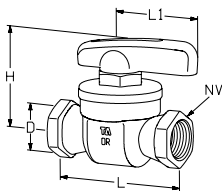

With blue handle

DN	D	L	L1	H	NV	Kvs	EAN	Article No
10 ¹⁾	G3/8	59	45,5	48	22	6	7318793352705	58 950-110
15 ¹⁾	G1/2	74	45,5	52	27	12	7318793352804	58 950-115
20 ¹⁾	G3/4	80	59	63	32	30	7318793352903	58 950-120
25	Rp1	91	59	69	41	65	7318793353009	58 950-125
32	Rp1 1/4	110	79	87	50	90	7318793353108	58 950-132
40	Rp1 1/2	120	79	93	58	150	7318793353207	58 950-140
50	Rp2	141	79	99	70	220	7318793353306	58 950-150

1) Prepared for KOMBI. KOMBI compression couplings are ordered separately. For more information see KOMBI catalogue leaflet.

Kvs = m³/h at a pressure drop of 1 bar and fully open valve.

Spare parts

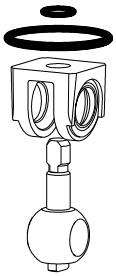

Spare parts kit for 58 950

Nitrile rubber (max. 90°C)

Note! Not suitable for LPG or medical gases.

For DN	EAN	Article No
10	7318793350008	58 900-010
15	7318793350107	58 900-015
20	7318793350206	58 900-020
25	7318793350305	58 900-025
32	7318793350404	58 900-032
40	7318793350503	58 900-040
50	7318793350602	58 900-050

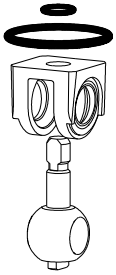

Spare parts kit for 58 940

EPDM rubber (max. 120°C)

Note! Not suitable for LPG or medical gases.

For DN	EAN	Article No
10	7318793350701	58 910-010
15	7318793350800	58 910-015
20	7318793350909	58 910-020
25	7318793351005	58 910-025
32	7318793351104	58 910-032
40	7318793351203	58 910-040
50	7318793351302	58 910-050