

# FPL



## **Metal pipe couplings**

Compression coupling for metallic pipes

# FPL

This is a supremely flexible compression coupling for metallic pipes, soft and hard copper pipes and soft steel pipes in heating, cooling and tap water systems. The same body fits up to seven sizes of all different pipes, ensuring quick and easy installation and saving money by reducing storage space.



## Key features

### > Comprehensive range

For optimum flexibility and faster installation, the FPL is available in a Dy range of 8-28 mm.

### > Complete or components

For ease-of-maintenance, the FPL is available as a complete coupling or as individual parts.

### > AMETAL® construction

Dezincification-resistant alloy that guarantees a longer coupling lifetime, and lowers the risk of leakage.

## Technical description

### Applications:

Heating and cooling systems.  
Tapwater systems.  
Process systems where the media does not affect the incoming material.  
Gas systems (natural gas, propane and butane)

### Function:

FPL compression coupling for soft and hard copper pipes and soft steel pipes.

**NOTE!** FPL is not approved for gas installations in combination with steel pipes.

A support bush must be used with soft copper and soft steel pipes.

### Dimensions:

Dy 8-28 mm.  
The large combination possibilities – one connection body size handles several pipe dimensions by only changing the thrust nut and cone – reduces the required storage space substantially.

### Pressure class:

PN 16

### Temperature:

Max. working temperature: 100°C.  
For temperatures over 100°C, please contact closest sales office.

### Material:

Parts which are subject to water contact: AMETAL®

AMETAL® is the dezincification resistant alloy of IMI Hydronic Engineering.

### Surface treatment:

Delivered as non-plated (yellow) or surface treated (chrome/nickel plated).  
See each product table.

### Approvals:

Approved by Gastec for gas installations with copper pipes:  
Certificate Q06/004 (Couplings approved for gas are marked in the product tables).  
Bodies are marked with:



## FPL for gas

FPL-bodies marked with “Q” (see Approvals) assembled with thrust nut in dim 10, 12, 15, 18, 22 and 28 mm are approved for gas installations with copper pipes and a maximum working pressure of 1 bar according to “Gastec QA Approval Requirements No. 35”  
 - Couplings approved for gas are marked in the product tables.

## Possible combinations for FPL



Body with thread (d)	can be adapted to fit pipe from
G3/8	8, 10, 12 mm
G1/2	8, 10, 12, 13, 14, 15, 16 mm
M22x1,5	12, 14, 15, 16 mm
M28x1,5	12, 15, 16, 18, 19, 22 mm
M34x1,5	28 mm

### Order example:

**Straight:** Specified couplings for D1 22 and D2 15 Article No 53 301-22x15

**Elbow:** Specified couplings for D1 22 and D2 15 Article No 53 304-22x15

**Tee:** Specified couplings for D1 12, D2 8 and D3 8 Article No 53 310-12x8x8

**NOTE:** The FPL-bodies are suitable for FPL, FPL-PX and FPL-MT couplings.

**Components in the FPL system are NOT compatible with components of different make.**

## Tightening

### No of turns

Dimension	Copper pipe/ Soft steel pipe	Chrome plated copper pipe	Stainless steel pipe
G3/8	1	1	-
G1/2	1	1	1,5
M22x1,5	1	1	-
M28x1,5	1	1,5	2
M34x1,5	1	1,5	1,5
Half coupling 53 319-xxx	1,5	1,5	-

A support bush must be used with soft copper and soft steel pipes.

## Stress corrosion

In certain cases stress corrosion can occur in association with the use of compression couplings, especially in the presence of ammonia, e.g. from use of certain cleaning fluids, in urinals etc. **To avoid stress corrosion given such circumstances we recommend** that the thrust nut be loosened again immediately after initial tightening, then tightened lightly again. This alleviates the high deformation stress arising from initial tightening.

**Components in the FPL system are NOT compatible with components of different make.**

## FPL – Straight

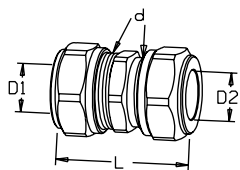

### TA 301 Straight

#### Chrome plated

D1xD2	d	L <sup>1</sup>	Gas approved	EAN	Article No
10	G3/8	43	X	7318793605108	53 301-210
12	G3/8	43	X	7318793605207	53 301-212
15	G1/2	52	X	7318793605306	53 301-515
12x10	G3/8	43	X	7318793605603	53 301-225
15x10	G1/2xG3/8	46	X	7318793605702	53 301-529
15x12	G1/2xG3/8	46	X	7318793605801	53 301-531

#### Non-plated (yellow)

D1xD2	d	L <sup>1</sup>	Gas approved	EAN	Article No
18	M28x1,5	56	X	7318793683007	53 301-618
22	M28x1,5	55	X	7318793683106	53 301-622
28	M34x1,5	60	X	7318793684905	53 301-928

When sizes 1 and 2 are the same, only 1 is given.

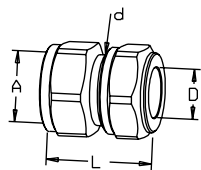

### TA 302 Straight

#### Female

#### Chrome plated

DxA	d	L <sup>1</sup>	EAN	Article No
10xG3/8	G3/8	32	7318793608000	53 302-210
12xG3/8	G3/8	32	7318793608208	53 302-212
15xG3/8	G1/2	36	7318793608406	53 302-215
10xG1/2	G3/8	34	7318793608109	53 302-510
12xG1/2	G3/8	34	7318793608505	53 302-512
15xG1/2	G1/2	38	7318793608307	53 302-515

#### Non-plated (yellow)

DxA	d	L <sup>1</sup>	EAN	Article No
18xG1/2	M28x1,5	40	7318793685902	53 302-318
22xG1/2	M28x1,5	40	7318793689306	53 302-322
18xG3/4	M28x1,5	42	7318793687401	53 302-618
22xG3/4	M28x1,5	42	7318793687500	53 302-622
28xG1	M34x1,5	50	7318793688408	53 302-928

1) Over all length L refers to unassembled coupling.

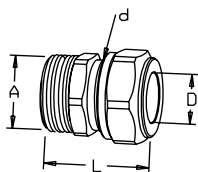

### TA 303 Straight

Male

#### Chrome plated

DxA	d	L <sup>1</sup>	Gas approved	EAN	Article No
8xR1/2	G3/8	34		7318793627803	53 303-508
12xR1/4	G3/8	33		7318793610805	53 303-207
10xR3/8	G3/8	37	X	7318793947901	53 333-210
12xR3/8	G3/8	37	X	7318793948007	53 333-212
15xR3/8	G1/2	39		7318793991904	53 333-215
10xR1/2	G3/8	39	X	7318793992000	53 333-510
12xR1/2	G3/8	39	X	7318793992109	53 333-512
15xR1/2	G1/2	47		7318793948106	53 333-515
16xR1/2 **	M22x1,5	40		7318793627704	53 303-416
22xR1/2	M28x1,5	45		7318793689900	53 303-522

#### Non-plated (yellow)

DxA	d	L <sup>1</sup>	Gas approved	EAN	Article No
18xR1/2	M28x1,5	45		7318793689207	53 303-318
22xR1/2	M28x1,5	45		7318793686008	53 303-322
15xR3/4	M28x1,5	49	X	7318793948403	53 333-615
18xR3/4	M28x1,5	49	X	7318793948502	53 333-618
22xR3/4	M28x1,5	49	X	7318793948601	53 333-622
28xR1	M34x1,5	55	X	7318793948809	53 333-928

\*\* ) Nickel plated

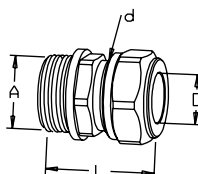

### TA 313 Straight with flange

Male

#### Chrome plated

DxA	d	L <sup>1</sup>	EAN	Article No
15xG1/2	G1/2	41	7318793609601	53 313-515

R = Male conical thread.

1) Over all length L refers to unassembled coupling.

## FPL – Elbow

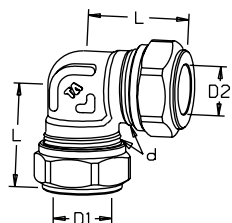
**TA 304 Elbow****Chrome plated**

D1xD2	d	L <sup>1</sup>	Gas approved	EAN	Article No
10	G3/8	28	X	7318793612106	53 304-210
12	G3/8	28	X	7318793612205	53 304-212
15	G1/2	33	X	7318793646606	53 304-515

**Non-plated (yellow)**

D1xD2	d	L <sup>1</sup>	Gas approved	EAN	Article No
18	M28x1,5	41	X	7318793692108	53 304-618
22	M28x1,5	41	X	7318793692207	53 304-622
28	M34x1,5	46	X	7318793693006	53 304-928

When sizes 1 and 2 are the same, only 1 is given.

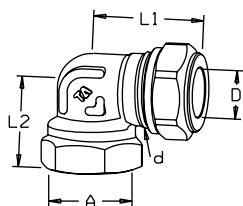
**TA 305 Elbow**

Female

**Chrome plated**

DxA	d	L1 <sup>1</sup>	L2 <sup>1</sup>	EAN	Article No
10xG3/8	G3/8	28	22	7318793613103	53 305-210
12xG3/8	G3/8	28	22	7318793613301	53 305-212
10xG1/2	G1/2	35	22	7318793613202	53 305-510
12xG1/2	G1/2	35	22	7318793613400	53 305-512
15xG1/2	G1/2	35	22	7318793613509	53 305-515

**Non-plated (yellow)**

DxA	d	L1 <sup>1</sup>	L2 <sup>1</sup>	EAN	Article No
18xG3/4	M28x1,5	43	30	7318793694003	53 305-618
22xG3/4	M28x1,5	43	30	7318793694102	53 305-622
28xG1	M34x1,5	49	33	7318793694706	53 305-928

1) Over all length L refers to unassembled coupling.

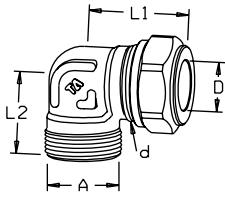

### TA 306 Elbow

Male

Chrome plated

DxA	d	L1'	L2'	Gas approved	EAN	Article No
10xR3/8	G3/8	28	24	X	7318793962201	53 336-210
12xR3/8	G3/8	28	24	X	7318793962300	53 336-212
15xG3/8 <sup>2</sup>	G1/2	36	23		7318793615800	53 306-215
10xR1/2	G1/2	33	29	X	7318793962409	53 336-510
12xR1/2	G1/2	33	29	X	7318793975607	53 336-512
15xR1/2	G1/2	34	29	X	7318793962508	53 336-515

Non-plated (yellow)

DxA	d	L1'	L2'	Gas approved	EAN	Article No
18xR3/4	M28x1,5	41	36	X	7318793962706	53 336-618
22xR3/4	M28x1,5	41	36	X	7318793962805	53 336-622
28xR1	M34x1,5	46	37	X	7318793963109	53 336-928

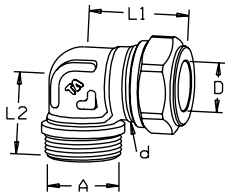

### TA 316 Elbow with flange

Male

Chrome plated

DxA	d	L1'	L2'	EAN	Article No
15xG1/2	G1/2	36	26	7318793614001	53 316-515

R = Male conical thread.

1) Over all length L refers to unassembled coupling.

2) Connection body with flange.

## FPL – Tee

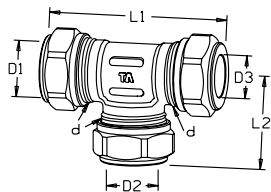

### TA 310 Tee

#### Chrome plated

D1xD2xD3	d	L1 <sup>1</sup>	L2 <sup>1</sup>	Gas approved	EAN	Article No
10	G3/8	56	28	X	7318793617804	53 310-210
12	G3/8	56	28	X	7318793617903	53 310-212
15	G1/2	66	33	X	7318793618405	53 310-515

#### Non-plated (yellow)

D1xD2xD3	d	L1 <sup>1</sup>	L2 <sup>1</sup>	Gas approved	EAN	Article No
18	M28x1,5	82	41	X	7318793697103	53 310-618
22	M28x1,5	82	41	X	7318793697202	53 310-622

When 1, 2 and 3 are the same, only 1 is given.

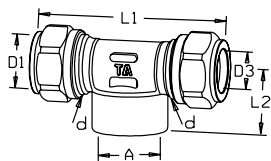

### TA 308 Tee

Female

#### Chrome plated

D1xAxD3	d	L1 <sup>1</sup>	L2 <sup>1</sup>	EAN	Article No
12xG1/2	G1/2	70	22	7318793616302	53 308-512
15xG1/2	G1/2	70	22	7318793616401	53 308-515

When sizes 1 and 3 are same, only 1 is given.

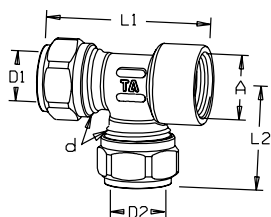

### TA 309 Tee

Female

#### Chrome plated

D1xD2xA	d	L1 <sup>1</sup>	L2 <sup>1</sup>	EAN	Article No
15x15xG1/2	G1/2	55	35	7318793616807	53 309-515

1) Over all length L refers to unassembled coupling.



## Elbow with wall plate

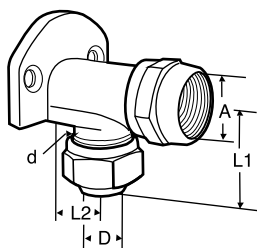

### TA 345 Elbow with wall plate

With swivelling nut

Female

Chrome plated

DxA	d	L1 <sup>1</sup>	L2 <sup>1</sup>	EAN	Article No
12xG1/2	G1/2	37	19	7318793619501	53 345-212
15xG1/2	G1/2	37	19	7318793619600	53 345-215

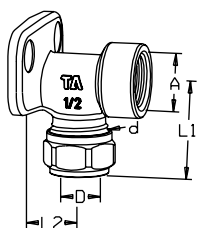

### TA 346 Elbow with wall plate

Female

Chrome plated

DxA	d	L1 <sup>1</sup>	L2 <sup>1</sup>	EAN	Article No
10xG1/2	G1/2	37	19	7318793619709	53 346-210
12xG1/2	G1/2	37	19	7318793619808	53 346-212
15xG1/2	G1/2	37	19	7318793619907	53 346-215

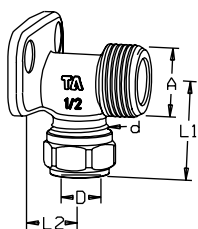

### TA 346 Elbow with wall plate

Male

Chrome plated

DxA	d	L1 <sup>1</sup>	L2 <sup>1</sup>	EAN	Article No
10xG3/4	G1/2	37	19	7318793629708	53 346-510
12xG3/4	G1/2	37	19	7318793629807	53 346-512
15xG3/4	G1/2	37	19	7318793629906	53 346-515

1) Over all length L refers to unassembled coupling.

## Distributors

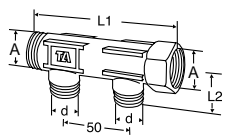

### TA 56 042, 2-way distributor

With swivelling nut

Non-plated (yellow)

d	A	L1 <sup>1</sup>	L2 <sup>1</sup>	EAN	Article No
G1/2	G3/4	100	50	7318793259202	56 042-001

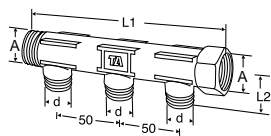

### TA 56 043, 3-way distributor

With swivelling nut

Non-plated (yellow)

d	A	L1 <sup>1</sup>	L2 <sup>1</sup>	EAN	Article No
G1/2	G3/4	150	50	7318793259400	56 043-001



### TA 56 000 Cap

Incl. flat gasket for the distributor

Non-plated (yellow)

A	EAN	Article No
G3/4	7318793255204	56 000-020

1) Over all length L refers to unassembled coupling.

## Half couplings, plugs and transition nipples

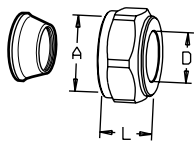

### TA 319 Half coupling

Chrome plated

Should not be used with PEX-pipes

DxA	L <sup>1</sup>	EAN	Article No
8xG1/2	16	7318793620002	53 319-208
10xG1/2	17	7318793620101	53 319-210
12xG1/2	17	7318793620200	53 319-212
15xG1/2	20	7318793620309	53 319-215
16xG1/2	25	7318793620408	53 319-216

Nickel plated

Should not be used with PEX-pipes

DxA	L <sup>1</sup>	EAN	Article No
15xG3/4	27	7318793705006	53 319-615
18xG3/4	27	7318793705105	53 319-618
22xG3/4	27	7318793705204	53 319-622

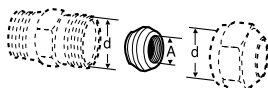

### TA 322 Plug

Non-plated (yellow)

Size	d	A	EAN	Article No
6 - 12	G3/8	G1/8	7318793629302	53 322-012
8 - 16 **	G1/2	-	7318793629401	53 322-015
10 - 22	M28x1,5	G3/8	7318793705501	53 322-022

\*\* ) Nickel plated

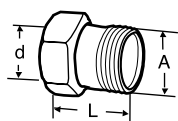

### TA 339 Transition nipple

Male, with swivelling nut

Nickel plated

dxA	L <sup>1</sup>	EAN	Article No
M28x1,5 x R1/2	35	7318793706508	53 339-715

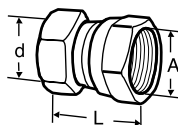

### TA 348 Transition nipple

Female, with swivelling nut

Nickel plated

dxA	L <sup>1</sup>	EAN	Article No
M28x1,5 x G3/4	32	7318793707208	53 348-420

R = Male conical thread.

1) Over all length L refers to unassembled coupling.

## Support bushes



### TA 320 Support bush – AMETAL®

#### Copper pipes

For pipe size	EAN	Article No
8x0,8	7318793762207	53 320-008
8x1,0	7318793762306	53 320-108
10x0,8	7318793762405	53 320-010
10x1,0	7318793762504	53 320-110
12x1,0	7318793762702	53 320-012
15x1,0	7318793763105	53 320-015
15x1,2	7318793763204	53 320-315
16x1,0	7318793763303	53 320-016
18x1,0	7318793763402	53 320-018
18x1,2	7318793763501	53 320-318
22x1,0	7318793763600	53 320-022
22x1,5	7318793763709	53 320-322

## G3/8

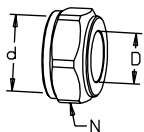

### TA 371 Thrust nut FPL

Chrome plated

D	d	N	EAN	Article No
8	G3/8	20	7318793638809	53 371-208
10	G3/8	20	7318793638908	53 371-210
12	G3/8	20	7318793639004	53 371-212

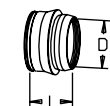

### TA 381 Cones FPL

Non-plated (yellow)

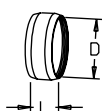

D	L	EAN	Article No
8	12	7318793640802	53 381-008
10	12	7318793640901	53 381-010
12***	7	7318793641007	53 381-012

\*\*\*) Double

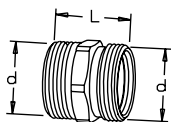

### TA 351 Coupling

Chrome plated

d	L	Gas approved	EAN	Article No
G3/8	24	X	7318793634603	53 351-212
G3/8xG1/2	25	X	7318793634702	53 351-501

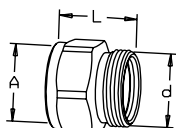

### TA 356 Straight

Female

Chrome plated

Axd	L	EAN	Article No
G3/8xG3/8	22	7318793636300	53 356-210
G1/2xG3/8	24	7318793636409	53 356-215

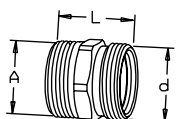

### TA 358 Straight

Male

Chrome plated

Axd	L	Gas approved	EAN	Article No
R1/4xG3/8	23		7318793637000	53 358-208
R3/8xG3/8	28	X	7318793948908	53 338-210
R1/2xG3/8	29	X	7318793637208	53 358-215

R = Male conical thread.

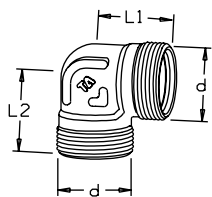

**TA 361 Elbow**

Chrome plated

d	L1	L2	Gas approved	EAN	Article No
G3/8	18	18	X	7318793637802	53 361-212

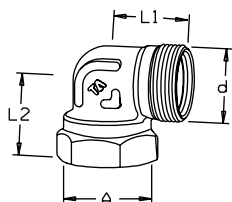

**TA 363 Elbow**

Female

Chrome plated

Axd	L1	L2	EAN	Article No
G3/8xG3/8	18	23	7318793638304	53 363-210

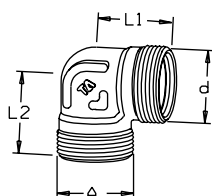

**TA 354 Elbow**

Male

Chrome plated

Axd	L1	L2	Gas approved	EAN	Article No
R3/8xG3/8	18	24	X	7318793970503	53 334-210

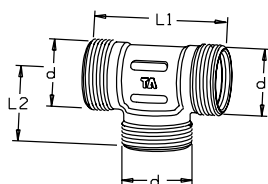

**TA 352 Tee**

Chrome plated

d	L1	L2	Gas approved	EAN	Article No
G3/8	36	18	X	7318793635006	53 352-212

R = Male conical thread.

## G1/2

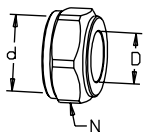

### TA 379 Thrust nut FPL

Chrome plated

D	d	N	EAN	Article No
8	G1/2	25	7318793640000	53 379-208
10	G1/2	25	7318793640109	53 379-210
12	G1/2	25	7318793640208	53 379-212
13	G1/2	25	7318793640307	53 379-213
14	G1/2	25	7318793640406	53 379-214
15	G1/2	25	7318793640505	53 379-215
16	G1/2	25	7318793640604	53 379-216

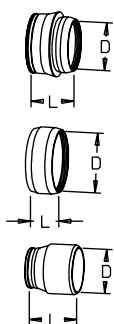

### TA 389 Cone FPL

Non-plated (yellow)

D	L	EAN	Article No
8	14	7318793641908	53 389-008
10	14	7318793642004	53 389-010
12	14	7318793642103	53 389-012
13	14	7318793642202	53 389-013
14	14	7318793642301	53 389-014
15 ***	8	7318793642400	53 389-015
16	18	7318793642509	53 389-016

\*\*\*) Double

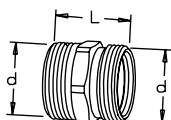

### TA 351 Coupling

Chrome plated

d	L	Gas approved	EAN	Article No
G1/2	29	X	7318793634801	53 351-515
G3/8xG1/2	25	X	7318793634702	53 351-501

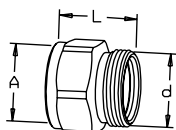

### TA 356 Straight

Female

Chrome plated

Axd	L	EAN	Article No
G3/8xG1/2	25	7318793636706	53 356-510
G1/2xG1/2	27	7318793636904	53 356-515

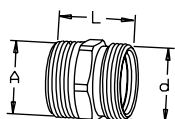
**TA 358 Straight**

Male

**Chrome plated**

Axd	L	Gas approved	EAN	Article No
R3/8xG1/2	28	X	7318793637604	53 358-510
R1/2xG1/2	36	X	7318793949004	53 338-515

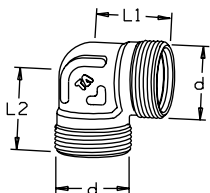
**TA 361 Elbow**
**Chrome plated**

d	L1	L2	Gas approved	EAN	Article No
G1/2	22	22	X	7318793637901	53 361-515

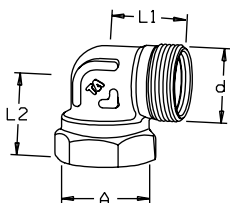
**TA 363 Elbow**

Female

**Chrome plated**

Axd	L1	L2	EAN	Article No
G1/2xG1/2	22	24	7318793638403	53 363-515

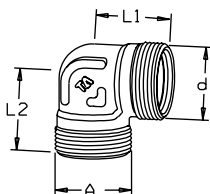

**TA 354 Elbow**

Male

**Chrome plated**

Axd	L1	L2	Gas approved	EAN	Article No
G3/8xG1/2 <sup>2</sup>	25	23		7318793635907	53 354-510
R1/2xG1/2	22	29	X	7318793970404	53 334-515

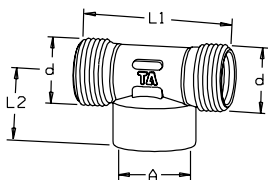
2) Connection body with flange.

**TA 362 Tee**

Female

**Chrome plated**

dxA	L1	L2	EAN	Article No
G1/2xG1/2	48	22	7318793638106	53 362-515

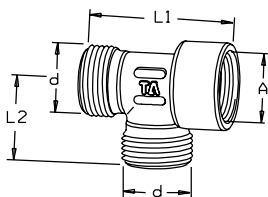
**TA 362 Tee**

Female

**Chrome plated**

dxdxA	L1	L2	EAN	Article No
G1/2xG1/2xG1/2	44	24	7318793638007	53 362-501

R = Male conical thread.



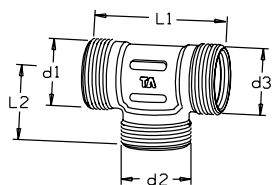

### TA 352 Tee

Chrome plated

d1xd2xd3	L1	L2	Gas approved	EAN	Article No
G1/2	44	22	X	7318793635501	53 352-515

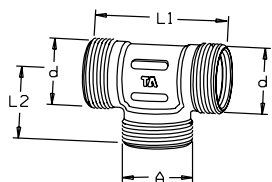

### TA 352 Tee

Male

Chrome plated

dxA	L1	L2	EAN	Article No
G1/2xG1/2xG1/2 <sup>2</sup>	50	26	7318793635402	53 352-504

2) Connection body with flange.

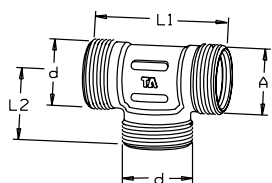

### TA 352 Tee

Male

Chrome plated

dxdxA	L1	L2	EAN	Article No
G1/2xG1/2xG1/2 <sup>2</sup>	51	25	7318793635303	53 352-503

2) Connection body with flange.

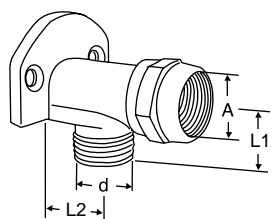

### TA 367 Elbow with wall plate

Female

Chrome plated

Axd	L1	L2	EAN	Article No
G1/2xG1/2	23	19	7318793638502	53 367-515

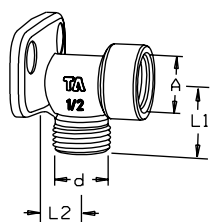

### TA 368 Elbow with wall plate

Female

Chrome plated

Axd	L1	L2	EAN	Article No
G1/2xG1/2	26	19	7318793638601	53 368-515

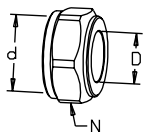
**M22x1.5**

**TA 372 Thrust nut FPL**
**Nickel plated**

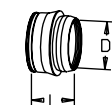
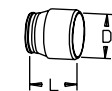
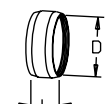
D	d	N	EAN	Article No
12	M22x1,5	25	7318793639301	53 372-112
14	M22x1,5	25	7318793639400	53 372-114
15	M22x1,5	25	7318793639509	53 372-115
16	M22x1,5	25	7318793639608	53 372-116

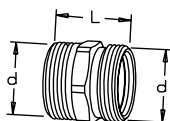

**TA 382 Cones FPL**
**Non-plated (yellow)**

D	L	EAN	Article No
12	14	7318793641304	53 382-012
14	14	7318793641403	53 382-014
15	15	7318793641502	53 382-015
16***	9	7318793641601	53 382-016

\*\*\*) Double

**TA 351 Coupling**
**Nickel plated**

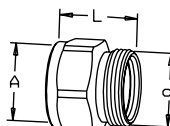
d	L	EAN	Article No
M22x1,5	25	7318793630100	53 351-416

**TA 356 Straight**

Female

**Non-plated (yellow)**

d	L	EAN	Article No
G1/2xM22x1,5	26	7318793630506	53 356-415

**Nickel plated**

A x d	L	EAN	Article No
G3/8 x M22x1,5	21	7318793636508	53 356-411
G1/2 x M22x1,5	26	7318793636607	53 356-416

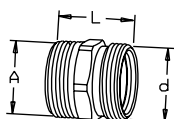

### TA 358 Straight

Male

Non-plated (yellow)

A x d	L	EAN	Article No
R1/2 x M22x1,5	30	7318793630704	53 358-415

Nickel plated

A x d	L	EAN	Article No
R3/8 x M22x1,5	28	7318793637406	53 358-411
R1/2 x M22x1,5	30	7318793637505	53 358-416

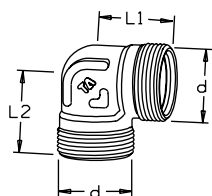

### TA 361 Elbow

Nickel plated

d	L1	L2	EAN	Article No
M22x1,5	22	22	7318793630902	53 361-416

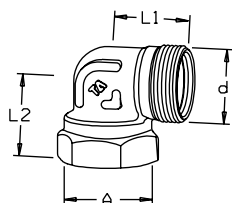

### TA 363 Elbow

Female

Nickel plated

A x d	L1	L2	EAN	Article No
G1/2 x M22x1,5	22	24	7318793638205	53 363-416

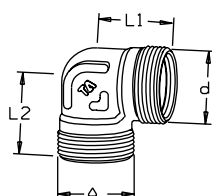

### TA 354 Elbow

Male

Nickel plated

A x d	L1	L2	EAN	Article No
R1/2 x M22x1,5	22	24	7318793635600	53 354-416

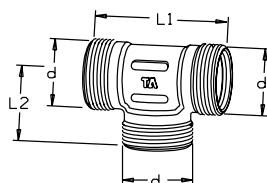

### TA 352 Tee

Nickel plated

d	L1	L2	EAN	Article No
M22x1,5	43	22	7318793634900	53 352-416

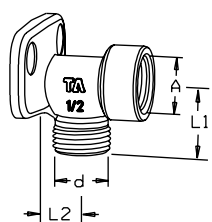

### TA 368 Elbow with wall plate

Female

Chrome plated

A x d	L1	L2	EAN	Article No
G1/2 x M22x1,5	27	19	7318793632005	53 368-417

R = Male conical thread.

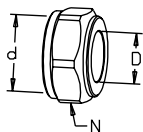
**M28x1.5**

**TA 373 Thrust nut FPL**

Non-plated (yellow)

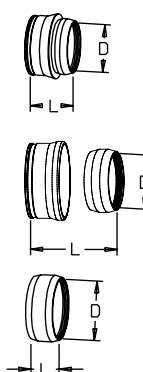
D	d	N	EAN	Article No
12	M28x1,5	32	7318793723505	53 373-012
15	M28x1,5	32	7318793723604	53 373-015
16	M28x1,5	32	7318793723703	53 373-016
18	M28x1,5	32	7318793723802	53 373-018
19	M28x1,5	32	7318793723901	53 373-019
22	M28x1,5	32	7318793724007	53 373-022



**TA 383 Cones FPL**

Non-plated (yellow)

D	L	EAN	Article No
12	14	7318793726803	53 383-012
15	15	7318793726902	53 383-015
16	16	7318793727008	53 383-016
18****	16	7318794025301	53 383-318
19	16	7318793727206	53 383-019
22***	10	7318793727305	53 383-022

\*\*\*) Double

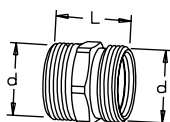
\*\*\*\*) 2 cones

**TA 351 Coupling**

Non-plated (yellow)

d	L	Gas approved	EAN	Article No
M28x1,5	28	X	7318793712707	53 351-622

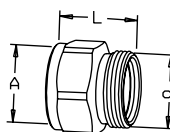
**TA 356 Straight**

Female

Non-plated (yellow)

A x d	L	EAN	Article No
G1/2 x M28x1,5	27	7318793719409	53 356-615
G3/4 x M28x1,5	29	7318793719508	53 356-620

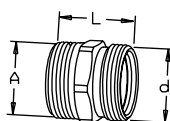

**TA 358 Straight**

Male

Non-plated (yellow)

A x d	L	EAN	Article No
R1/2 x M28x1,5	31	7318793720405	53 358-615
R3/4 x M28x1,5	32	7318793720504	53 358-620

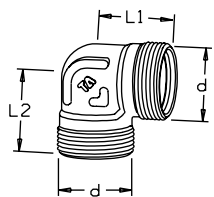
R = Male conical thread.



### TA 361 Elbow

Non-plated (yellow)

d	L1	L2	Gas approved	EAN	Article No
M28x1,5	28	28	X	7318793721600	53 361-622

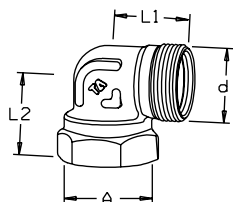

### TA 363 Elbow

Female

Non-plated (yellow)

A x d	L1	L2	EAN	Article No
G3/4 x M28x1,5	30	30	7318793722300	53 363-620

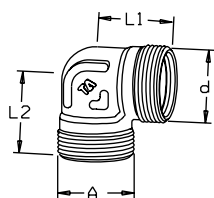

### TA 354 Elbow

Male

Non-plated (yellow)

A x d	L1	L2	Gas approved	EAN	Article No
R3/4 x M28x1,5	28	36	X	7318793970602	53 334-620

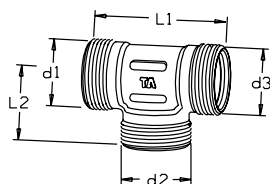

### TA 352 Tee

Non-plated (yellow)

d1 x d2 x d3	L1	L2	Gas approved	EAN	Article No
M28x1,5	55	28	X	7318793717603	53 352-622

R = Male conical thread.

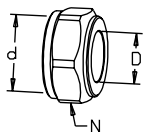
**M34x1.5**

**TA 374 Thrust nut FPL**

Non-plated (yellow)

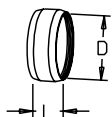
D	d	N	EAN	Article No
28	M34x1,5	38	7318793725608	53 374-028

**TA 384 Cone FPL**

Non-plated (yellow)

D	L	EAN	Article No
28***	13	7318793727909	53 384-028

\*\*\* ) Double

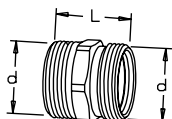
**TA 351 Coupling**

Non-plated (yellow)

d	L	Gas approved	EAN	Article No
M34x1,5	29	X	7318793712806	53 351-928

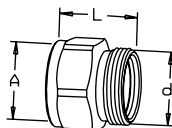
**TA 356 Straight**

Female

Non-plated (yellow)

A x d	L	EAN	Article No
G3/4 x M34x1,5	32	7318793720108	53 356-920

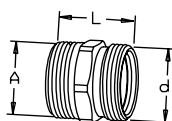
**TA 358 Straight**

Male

Non-plated (yellow)

A x d	L	EAN	Article No
R3/4 x M34x1,5	33	7318793721006	53 358-920
R1 x M34x1,5	36	7318793721105	53 358-925

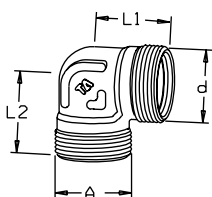
**TA 354 Elbow**

Male

Non-plated (yellow)

A x d	L1	L2	EAN	Article No
G3/4 x M34x1,5 <sup>4</sup>	31	32	7318793719300	53 354-920

4) Short thread

R = Male conical thread.

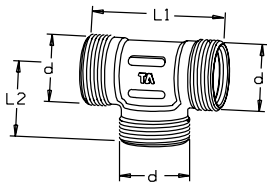
**TA 352 Tee**
**Non-plated (yellow)**

<b>d</b>	<b>L1</b>	<b>L2</b>	<b>Gas approved</b>	<b>EAN</b>	<b>Article No</b>
M34x1,5	61	31	X	7318793717801	53 352-928

R = Male conical thread.

