

FPL-PX



Plastic pipe couplings

Compression coupling for PEX-pipes

FPL-PX

High-performing and flexible compression coupling for PEX pipes in heating, cooling and tap water systems. Available in a comprehensive Dy range of 12-50 mm – enabling faster installation – as well as a wide range of sizes.

Key features

> Comprehensive range

For optimum flexibility and faster installation, the FPL-PX is available in a Dy range of 12-50 mm.

> AMETAL® construction

Dezincification-resistant alloy that guarantees a longer coupling lifetime, and lowers the risk of leakage.

> Cut cone

For straightforward installation.



Technical description

Applications:

Heating and cooling systems.
Tapwater systems.
Process systems where the media does not affect the incoming material.

Function:

FPL-PX compression coupling for PEX pipes (SS-EN ISO 15875).

Dimensions:

Dy 12-50 mm

Pressure class:

PN 6/PN 10 or the pipe pressure.

Temperature:

Max. working temperature: 95°C or the pipe temperature.

Material:

Parts which are subject to water contact:
AMETAL®
Support bush: Brass CW724R
Allen screws and lockring: Stainless steel
O-rings (40-50 mm): EPDM rubber

AMETAL® is the dezincification resistant alloy of IMI Hydronic Engineering.

Surface treatment:

Delivered as non-plated (yellow) or surface treated (chrome/nickel plated).
See each product table.

Possible combinations for FPL-PX

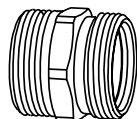

Body with thread (d)	can be adapted to fit pipe from
G1/2	12, 15 mm
G3/4	12 mm
M22x1,5	12, 15, 16 mm
M28x1,5	15, 16, 18, 20, 22 mm
M34x1,5	22, 25, 28 mm
M42x2,0	32, 40 mm

Wall thickness for the pipe - see each product tabel for connetion set FPL-PX.

NOTE: The FPL-bodies are suitable for FPL, FPL-PX and FPL-MT couplings.

Components in the FPL-PX system are NOT compatible with components of different make.

G1/2

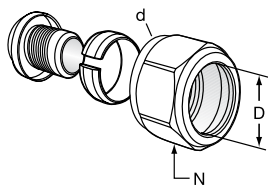

Connection set FPL-PX

Chrome plated

d	L'	For PEX-pipe D	N	EAN	Article No
G1/2	13	12x1,7	24	7318793966605	53 644-212
G1/2	13	12x2,0	24	7318792949906	53 644-312
G1/2	16	15x2,5	24	7318792950100	53 644-315

1) Over all length.

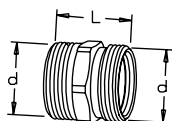

TA 351 Coupling

Chrome plated

d	L	EAN	Article No
G1/2	29	7318793634801	53 351-515
G3/8xG1/2	25	7318793634702	53 351-501

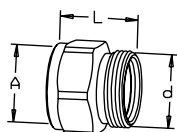

TA 356 Straight

Female

Chrome plated

Axd	L	EAN	Article No
G3/8xG1/2	25	7318793636706	53 356-510
G1/2xG1/2	27	7318793636904	53 356-515

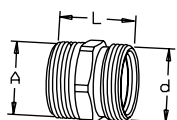

TA 358 Straight

Male

Chrome plated

Axd	L	EAN	Article No
R3/8xG1/2	28	7318793637604	53 358-510
R1/2xG1/2	36	7318793949004	53 338-515

2) Connection body with flange.

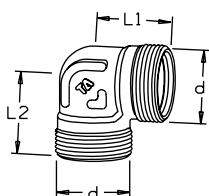

TA 361 Elbow

Chrome plated

d	L1	L2	EAN	Article No
G1/2	22	22	7318793637901	53 361-515

R = Male conical thread.

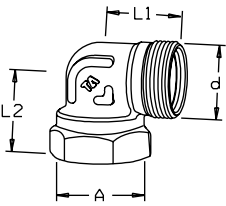

TA 363 Elbow
Female

Chrome plated

Axd	L1	L2	EAN	Article No
G1/2xG1/2	22	24	7318793638403	53 363-515

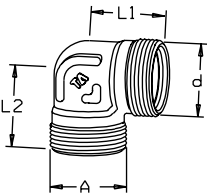

TA 354 Elbow
Male

Chrome plated

Axd	L1	L2	EAN	Article No
G3/8xG1/2 ²	25	23	7318793635907	53 354-510
R1/2xG1/2	22	29	7318793970404	53 334-515

2) Connection body with flange.

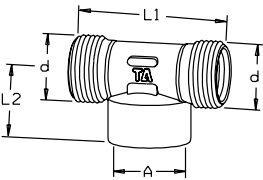

TA 362 Tee
Female

Chrome plated

dxA	L1	L2	EAN	Article No
G1/2xG1/2	48	22	7318793638106	53 362-515

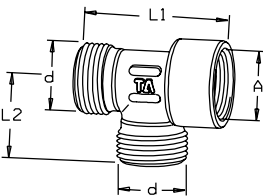

TA 362 Tee
Female

Chrome plated

dx dxA	L1	L2	EAN	Article No
G1/2xG1/2xG1/2	44	24	7318793638007	53 362-501

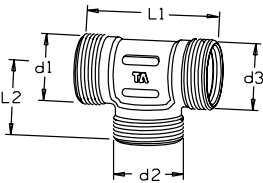

TA 352 Tee

Chrome plated

d1xd2xd3	L1	L2	EAN	Article No
G1/2	44	22	7318793635501	53 352-515

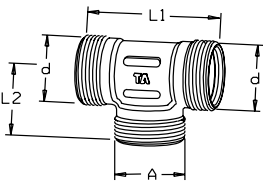

TA 352 Tee
Male

Chrome plated

dxA	L1	L2	EAN	Article No
G1/2xG1/2xG1/2 ²	50	26	7318793635402	53 352-504

2) Connection body with flange.

R = Male conical thread.

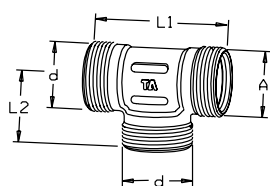

TA 352 Tee

Male

Chrome plated

dxdxA	L1	L2	EAN	Article No
G1/2xG1/2xG1/2 ²	51	25	7318793635303	53 352-503

2) Connection body with flange.

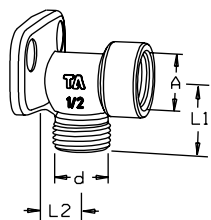

TA 368 Elbow with wall plate

Female

Chrome plated

Axd	L1	L2	EAN	Article No
G1/2xG1/2	26	19	7318793638601	53 368-515

G3/4

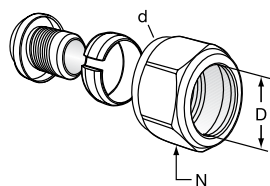

Connection set FPL-PX

Non-plated (yellow)

d	L ¹	For PEX-pipe D	N	EAN	Article No
G3/4	12	12X1,7	30	7318793966506	53 641-812

1) Over all length.

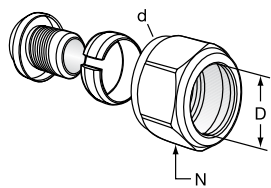
M22x1.5**Connection set FPL-PX****Nickel plated**

d	L'	For PEX-pipe D	N	EAN	Article No
M22x1,5	13	12x2,0	25	7318792948206	53 643-412
M22x1,5	16	15x2,5	25	7318792948404	53 643-415
M22x1,5	14	16x2,0	25	7318792947506	53 643-116
M22x1,5	14	16x2,2	25	7318792948503	53 643-416

1) Over all length.

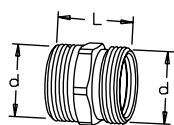
**TA 351 Coupling****Nickel plated**

d	L	EAN	Article No
M22x1,5	25	7318793630100	53 351-416

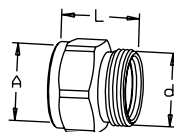
**TA 356 Straight**

Female

Nickel plated

A x d	L	EAN	Article No
G1/2 x M22x1,5	26	7318793636607	53 356-416

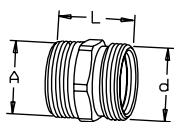

TA 358 Straight

Male

Nickel plated

A x d	L	EAN	Article No
R1/2 x M22x1,5	30	7318793637505	53 358-416

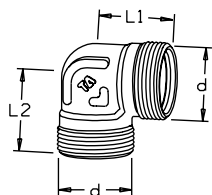

TA 361 Elbow

Nickel plated

d	L1	L2	EAN	Article No
M22x1,5	22	22	7318793630902	53 361-416

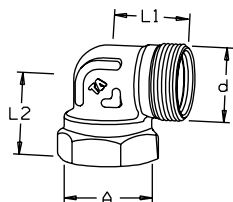

TA 363 Elbow

Female

Nickel plated

A x d	L1	L2	EAN	Article No
G1/2 x M22x1,5	22	24	7318793638205	53 363-416

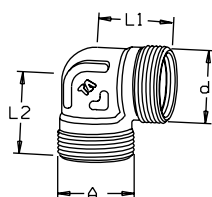

TA 354 Elbow

Male

Nickel plated

A x d	L1	L2	EAN	Article No
R1/2 x M22x1,5	22	24	7318793635600	53 354-416

R = Male conical thread.

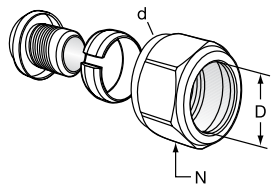
M28x1.5**Connection set FPL-PX****Non-plated (yellow)**

d	L'	For PEX-pipe D	N	EAN	Article No
M28x1,5	13	15x2,5	32	7318792950407	53 644-615
M28x1,5	13	18x2,5	32	7318792950506	53 644-618
M28x1,5	15	20x2,0	32	7318792950605	53 644-620
M28x1,5	16	20x2,3	32	7318792947308	53 642-620
M28x1,5	16	22x3,0	32	7318792950704	53 644-622

1) Over all length.

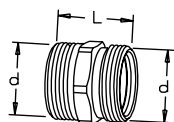
**TA 351 Coupling****Non-plated (yellow)**

d	L	EAN	Article No
M28x1,5	28	7318793712707	53 351-622

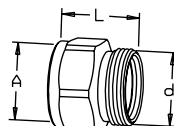
**TA 356 Straight**

Female

Non-plated (yellow)

A x d	L	EAN	Article No
G1/2 x M28x1,5	27	7318793719409	53 356-615
G3/4 x M28x1,5	29	7318793719508	53 356-620

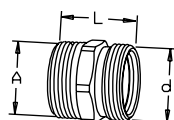
**TA 358 Straight**

Male

Non-plated (yellow)

A x d	L	EAN	Article No
R1/2 x M28x1,5	31	7318793720405	53 358-615
R3/4 x M28x1,5	32	7318793720504	53 358-620

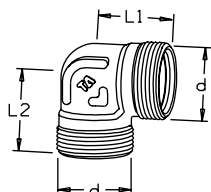
**TA 361 Elbow****Non-plated (yellow)**

d	L1	L2	EAN	Article No
M28x1,5	28	28	7318793721600	53 361-622

R = Male conical thread.

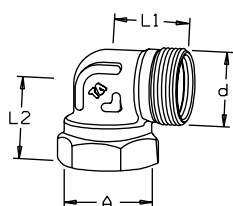

TA 363 Elbow

Female

Non-plated (yellow)

A x d	L1	L2	EAN	Article No
G3/4 x M28x1,5	30	30	7318793722300	53 363-620

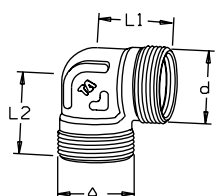

TA 354 Elbow

Male

Non-plated (yellow)

A x d	L1	L2	EAN	Article No
R3/4 x M28x1,5	28	36	7318793970602	53 334-620

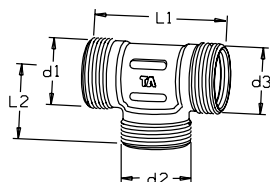

TA 352 Tee

Non-plated (yellow)

d1 x d2 x d3	L1	L2	EAN	Article No
M28x1,5	55	28	7318793717603	53 352-622

R = Male conical thread.

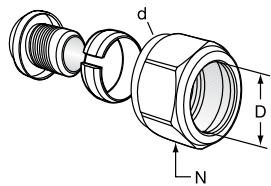
M34x1.5**Connection set FPL-PX****Non-plated (yellow)**

d	L'	For PEX-pipe D	N	EAN	Article No
M34x1,5	13	22x3,0	38	7318792951206	53 644-922
M34x1,5	16	25x2,3	38	7318792950803	53 644-625
M34x1,5	16	25x3,5	38	7318792951305	53 644-925
M34x1,5	20	28x4,0	38	7318792951404	53 644-928

1) Over all length.

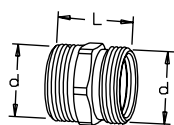
**TA 351 Coupling****Non-plated (yellow)**

d	L	EAN	Article No
M34x1,5	29	7318793712806	53 351-928

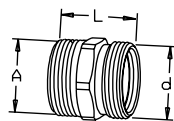
**TA 358 Straight**

Male

Non-plated (yellow)

A x d	L	EAN	Article No
R3/4 x M34x1,5	33	7318793721006	53 358-920
R1 x M34x1,5	36	7318793721105	53 358-925

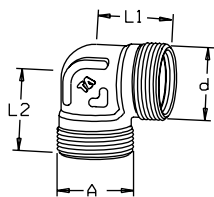
**TA 354 Elbow**

Male

Non-plated (yellow)

A x d	L1	L2	EAN	Article No
G3/4 x M34x1,5 ⁴	31	32	7318793719300	53 354-920

4) Short thread

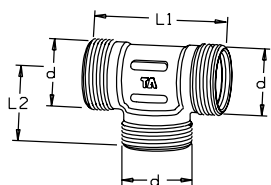
**TA 352 Tee****Non-plated (yellow)**

d	L1	L2	EAN	Article No
M34x1,5	61	31	7318793717801	53 352-928

R = Male conical thread.

M42x2.0

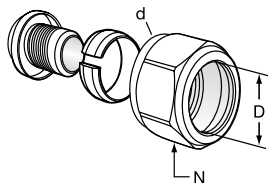

Connection set FPL-PX

Non-plated (yellow)

d	L ¹	For PEX-pipe D	N	EAN	Article No
M42x2,0	17	32x2,9/3,0	47	7318792949807	53 643-932
M42x2,0	17	32x4,4	47	7318792951503	53 644-932

1) Over all length.

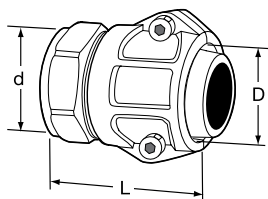

Connection coupling FPL-PX

With swivelling nut

Non-plated (yellow)

d	L ¹	For PEX-pipe D	EAN	Article No
M42x2,0	65	40x3,7	7318792913600	53 500-040
M42x2,0	65	40x5,5	7318792913907	53 500-340

1) Over all length.

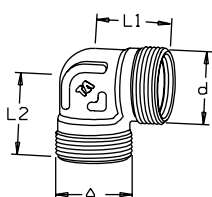

TA 354 Elbow

Male

Non-plated (yellow)

A x d	L1	L2	EAN	Article No
R1 1/4 x M42x2,0	44	44	7318793733702	53 354-032

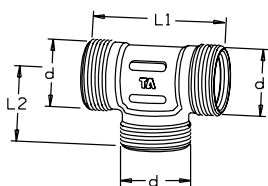

TA 352 Tee

Non-plated (yellow)

d	L1	L2	EAN	Article No
M42x2,0	88	44	7318793732804	53 352-035

R = Male conical thread.

M50x2.0

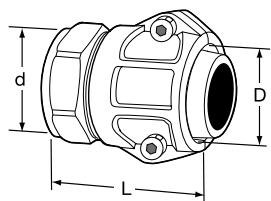

Connection coupling FPL-PX

With swivelling nut

Non-plated (yellow)

d	L ¹	For PEX-pipe D	EAN	Article No
M50x2,0	67	50x4,6	7318792913709	53 500-050

1) Over all length.

Distributors

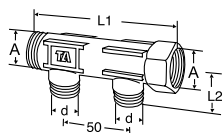

TA 56 042, 2-way distributor

With swivelling nut

Non-plated (yellow)

d	A	L1 ¹	L2 ¹	EAN	Article No
G1/2	G3/4	100	50	7318793259202	56 042-001

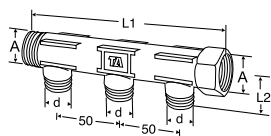

TA 56 043, 3-way distributor

With swivelling nut

Non-plated (yellow)

d	A	L1 ¹	L2 ¹	EAN	Article No
G1/2	G3/4	150	50	7318793259400	56 043-001



TA 56 000 Cap

Incl. flat gasket for the distributor

Non-plated (yellow)

A	EAN	Article No
G3/4	7318793255204	56 000-020

1) Over all length L refers to unassembled coupling.

Transition nipples

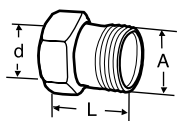

TA 339 Transition nipple

Male, with swivelling nut

Nickel plated

dxA	L ¹	EAN	Article No
M28x1,5 x R1/2	35	7318793706508	53 339-715

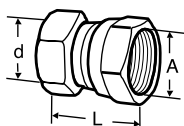

TA 348 Transition nipple

Female, with swivelling nut

Nickel plated

dxA	L ¹	EAN	Article No
M28x1,5 x G3/4	32	7318793707208	53 348-420

R = Male conical thread.

1) Over all length L refers to unassembled coupling.

