

TA 900 iSi



Ball valves

DN 10-50

TA 900 iSi

Soft-sealing for complete ease-of-use, the TA 900 iSi ball valve is suitable for use in heating, cooling and tap water systems. KOMBI connections enable smooth installation.

Key features

- > **Soft-sealing**
For optimum manoeuvrability.
- > **Removable lid**
For straightforward maintenance.
- > **AMETAL®**
Dezincification resistant alloy that guarantees a longer valve lifetime, and lowers the risk of leakage.



Technical description

Applications:

Heating and cooling systems
Tapwater systems
Process systems where the media does not affect the incoming material.

Function:

Shut-off

Dimensions:

DN 10-50

Pressure class:

PN 16

Temperature:

58 940:

Max. working temperature: 120°C

Min. working temperature: -20°C

58 950:

Max. working temperature: 90°C

Min. working temperature: -20°C

Material:

Valve body: Die cast AMETAL®
Ball: Chrome plated AM'ETAL®, double nickel

Handle: Glass fibre re-inforced polyamid plastic

Rating plate: Acetal plastic

Cover screws: Stainless steel (The valve has cover screws for DN 32-50, DN 10-25 has a threaded top section)

Seat elements and O-rings: 58 940:

EPDM rubber, 58 950: Nitrile rubber

Handle reduction unit: Nickel-plated die-cast zinc alloy

Control handle: Glass fibre re-inforced plastic

AMETAL® is the dezincification resistant alloy of IMI Hydronic Engineering.

Surface treatment:

Nickel plated

Marking:

TA, DR, DN, PN

Approvals:

Approved for tapwater systems (max. 95°C) by RISE Certification, Sweden.

For domestic water and water with antifreeze

EPDM rubber

Max. working temperature: 120°C

Min. working temperature: -20°C

Note! Not suitable for LPG or medical gases.

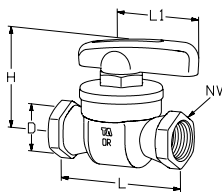

With red handle

DN	D	L	L1	H	NV	Kvs	EAN	Article No
10	G3/8	59	45,5	48	22	6	7318793351708	58 940-110
15	G1/2	74	45,5	52	27	12	7318793351807	58 940-115
20	G3/4	80	59	63	32	30	7318793351906	58 940-120
25	Rp1	91	59	69	41	65	7318793352002	58 940-125
32	Rp1 1/4	110	79	87	50	90	7318793352101	58 940-132
40	Rp1 1/2	120	79	93	58	150	7318793352200	58 940-140
50	Rp2	141	79	99	70	220	7318793352309	58 940-150

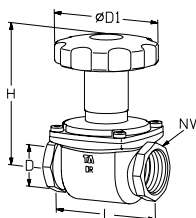

Fitted with red handle reduction unit

DN	D	D1	L	H	NV	Kvs	EAN	Article No
32	Rp1 1/4	110	110	130	50	90	7318793352408	58 940-732
40	Rp1 1/2	110	120	135	58	150	7318793352507	58 940-740
50	Rp2	110	141	142	70	220	7318793352606	58 940-750

1) Prepared for KOMBI. KOMBI compression couplings are ordered separately. For more information see KOMBI catalogue leaflet.

Kvs = m³/h at a pressure drop of 1 bar and fully open valve.

Universal

Nitrile rubber

Max. working temperature: 90°C

Min. working temperature: -20°C

Note! Not suitable for LPG or medical gases.

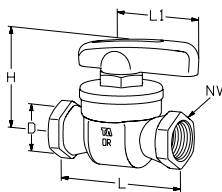

With blue handle

DN	D	L	L1	H	NV	Kvs	EAN	Article No
10	G3/8	59	45,5	48	22	6	7318793352705	58 950-110
15	G1/2	74	45,5	52	27	12	7318793352804	58 950-115
20	G3/4	80	59	63	32	30	7318793352903	58 950-120
25	Rp1	91	59	69	41	65	7318793353009	58 950-125
32	Rp1 1/4	110	79	87	50	90	7318793353108	58 950-132
40	Rp1 1/2	120	79	93	58	150	7318793353207	58 950-140
50	Rp2	141	79	99	70	220	7318793353306	58 950-150

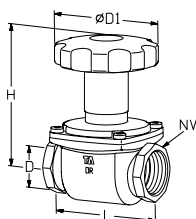

Fitted with blue handle reduction unit

DN	D	D1	L	H	NV	Kvs	EAN	Article No
32	Rp1 1/4	110	110	130	50	90	7318793353405	58 950-732
40	Rp1 1/2	110	120	135	58	150	7318793353504	58 950-740
50	Rp2	110	141	142	70	220	7318793353603	58 950-750

1) Prepared for KOMBI. KOMBI compression couplings are ordered separately. For more information see KOMBI catalogue leaflet.

Kvs = m³/h at a pressure drop of 1 bar and fully open valve.

Spare parts TA 900 iSi

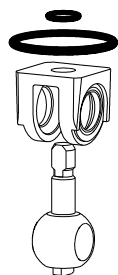
**Spare parts kit for 58 950**

Nitrile rubber (max. 90°C)

Note! Not suitable for LPG or medical gases.

For DN	EAN	Article No
10	7318793350008	58 900-010
15	7318793350107	58 900-015
20	7318793350206	58 900-020
25	7318793350305	58 900-025
32	7318793350404	58 900-032
40	7318793350503	58 900-040
50	7318793350602	58 900-050

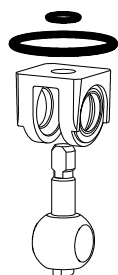
**Spare parts kit for 58 940**

EPDM rubber (max. 120°C)

Note! Not suitable for LPG or medical gases.

For DN	EAN	Article No
10	7318793350701	58 910-010
15	7318793350800	58 910-015
20	7318793350909	58 910-020
25	7318793351005	58 910-025
32	7318793351104	58 910-032
40	7318793351203	58 910-040
50	7318793351302	58 910-050

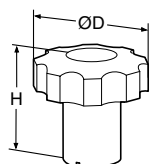
**Handle reduction unit**

For DN	ØD	H	Colour	EAN	Article No
32-50	110	80	Blue	7318793353702	58 980-032
32-50	110	80	Red	7318793353801	58 981-032

The products, texts, photographs, graphics and diagrams in this document may be subject to alteration by IMI Hydronic Engineering without prior notice or reasons being given. For the most up to date information about our products and specifications, please visit www.imi-hydronic.com.