

FPL-PX



Plastic pipe couplings
Compression coupling for
PEX-pipes



Engineering
GREAT Solutions

FPL-PX

High-performing and flexible compression coupling for PEX pipes in heating, cooling and tap water systems. Available in a comprehensive Dy range of 12-63 mm – enabling faster installation – as well as a wide range of sizes.



Key features

- > **Comprehensive range**
For optimum flexibility and faster installation, the FPL-PX is available in a Dy range of 12-63 mm.
- > **AMETAL® construction**
Dezincification-resistant alloy that guarantees a longer coupling lifetime, and lowers the risk of leakage.
- > **Cut cone**
For straightforward installation.

Technical description

Applications:

Heating and cooling systems.
Tapwater systems.
Process systems where the media does not affect the incoming material.

Function:

FPL-PX compression coupling for PEX pipes.

Dimensions:

Dy 12-63 mm

Pressure class:

PN 6/PN 10 or the pipe pressure.

Temperature:

Max. working temperature: 95°C or the pipe pressure.

Material:

Parts which are subject to water contact: AMETAL®
Allen screws and lockring: Stainless steel
O-rings (40-63 mm): EPDM rubber

AMETAL® is the dezincification resistant alloy of IMI Hydronic Engineering.

Surface treatment:

Delivered as non-plated (yellow) or surface treated (chrome/nickle plated).
See each product table.

Possible combinations for FPL-PX

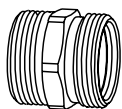

Body with thread (d)	can be adapted to fit pipe from
G1/2	12, 14, 15 mm
G3/4	12, 15, 16, 17, 18, 20, 22 mm
M22x1,5	12, 14, 15, 16, 17, 18, 20 mm
M28x1,5	15, 16, 18, 20, 22 mm
M34x1,5	16, 18, 20, 22, 25, 28 mm
M42x2,0	22, 25, 28, 32, 40 mm
M50x2,0	50 mm
M65x2,0	63 mm

Wall thickness for the pipe - see each product tabel for connetion set FPL-PX.

NOTE: The FPL-bodies are suitable for FPL, FPL-PX and FPL-MT couplings.

Components in the FPL-PX system are NOT compatible with components of different make.

G1/2

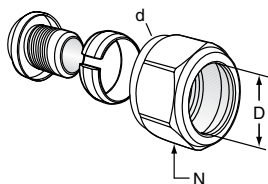

Connection set FPL-PX Chrome plated

d	L'	For PEX-pipe D	N	EAN	Article No
G1/2	13	12x1,7	24	7318793966605	53 644-212
G1/2	13	12x2,0	24	7318792949906	53 644-312
G1/2	16	15x2,5	24	7318792950100	53 644-315

1) Over all length.

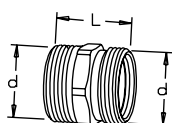

TA 351 Coupling Chrome plated

d	L	EAN	Article No
G1/2	29	7318793634801	53 351-515
G3/8xG1/2	25	7318793634702	53 351-501

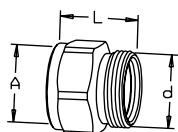

TA 356 Straight Female Chrome plated

Axd	L	EAN	Article No
G3/8xG1/2	25	7318793636706	53 356-510
G1/2xG1/2	27	7318793636904	53 356-515

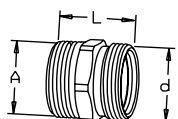

TA 358 Straight Male Chrome plated

Axd	L	EAN	Article No
R3/8xG1/2	28	7318793637604	53 358-510
R1/2xG1/2	36	7318793949004	53 338-515
G1/2xG1/2 ²	32	7318793637307	53 358-501

2) Connection body with flange.

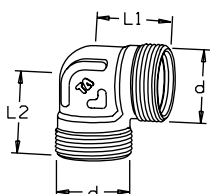

TA 361 Elbow Chrome plated

d	L1	L2	EAN	Article No
G1/2	22	22	7318793637901	53 361-515

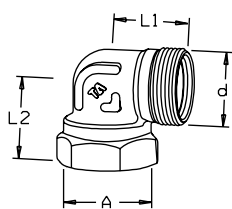
TA 363 Elbow

Female

Chrome plated

Axd	L1	L2	EAN	Article No
G1/2xG1/2	22	24	7318793638403	53 363-515

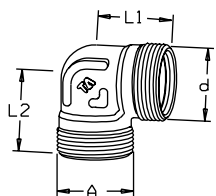

TA 354 Elbow

Male

Chrome plated

Axd	L1	L2	EAN	Article No
G3/8xG1/2 ²	25	23	7318793635907	53 354-510
R1/2xG1/2	22	29	7318793970404	53 334-515
G1/2xG1/2 ²	25	26	7318793636003	53 354-501

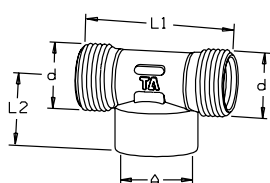
2) Connection body with flange.

TA 362 Tee

Female

Chrome plated

dxA	L1	L2	EAN	Article No
G1/2xG1/2	48	22	7318793638106	53 362-515

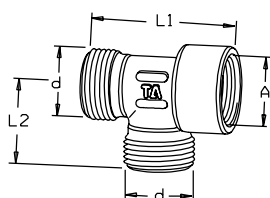
TA 362 Tee

Female

Chrome plated

dxdxA	L1	L2	EAN	Article No
G1/2xG1/2xG1/2	44	24	7318793638007	53 362-501

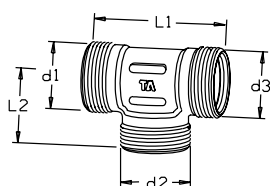
TA 352 Tee
Chrome plated

d1xd2xd3	L1	L2	EAN	Article No
G1/2xG3/8xG3/8	48	23	7318793635204	53 352-502
G1/2xG3/8xG1/2	50	23	7318793635105	53 352-501
G1/2	44	22	7318793635501	53 352-515

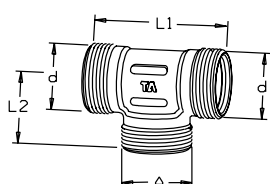
TA 352 Tee

Male

Chrome plated

dxA	L1	L2	EAN	Article No
G1/2xG1/2xG1/2 ²	50	26	7318793635402	53 352-504

2) Connection body with flange.

R = Male conical thread.

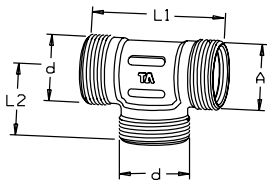

TA 352 Tee
Male
Chrome plated

dxdxA	L1	L2	EAN	Article No
G1/2xG1/2xG1/2 ²	51	25	7318793635303	53 352-503

2) Connection body with flange.

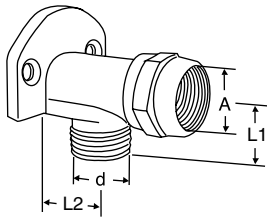

TA 367 Elbow with wall plate
Female
Chrome plated

Axd	L1	L2	EAN	Article No
G1/2xG1/2	23	19	7318793638502	53 367-515

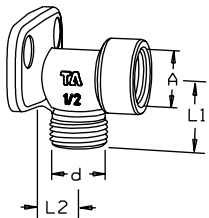

TA 368 Elbow with wall plate
Female
Chrome plated

Axd	L1	L2	EAN	Article No
G1/2xG1/2	26	19	7318793638601	53 368-515

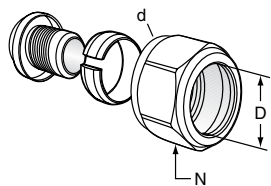
G3/4

Connection set FPL-PX
Non-plated (yellow)

d	L ¹	For PEX-pipe D	N	EAN	Article No
G3/4	12	12x1,7	30	7318793966506	53 641-812
G3/4	12	12x2,0	30	7318792945304	53 641-312
G3/4	14	15x2,5	30	7318793647009	53 641-415
G3/4	14	16x2,0	30	7318792945601	53 641-316
G3/4	18	17x2,0	30	7318792945700	53 641-317
G3/4	16	18x2,5	30	7318793713407	53 641-618
G3/4	16	20x2,3	30	7318792945908	53 641-320
G3/4	16	20x2,0	30	7318792946004	53 641-420
G3/4	16	22x3,0	30	7318793647108	53 641-422

Nickel plated

d	L ¹	For PEX-pipe D	N	EAN	Article No
G3/4	14	16x2,2	30	7318792946301	53 641-616

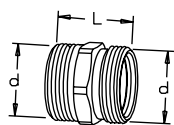
1) Over all length.

TA 351 Coupling
Non-plated (yellow)

d	L	EAN	Article No
G3/4	31	7318793712608	53 351-618

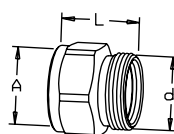
TA 356 Straight

Female

Non-plated (yellow)

Axd	L	EAN	Article No
G1/2xG3/4	27	7318793734907	53 356-318

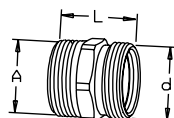

TA 358 Straight

Male

Non-plated (yellow)

Axd	L	EAN	Article No
R1/2xG3/4	34	7318793736109	53 358-318
G3/4xG3/4	31	7318793712608	53 351-618

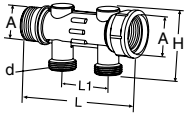
R = Male conical thread.



2-way distributor
Non-plated (yellow)

A	d	L	L1	H	EAN	Article No
G1	G3/4	123	50	62	7318793584106	50 222-100

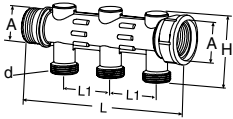

3-way distributor
Non-plated (yellow)

A	d	L	L1	H	EAN	Article No
G1	G3/4	173	50	62	7318793584205	50 223-100

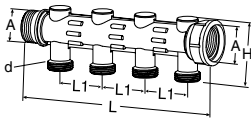

4-way distributor
Non-plated (yellow)

A	d	L	L1	H	EAN	Article No
G1	G3/4	223	50	62	7318793584304	50 224-100

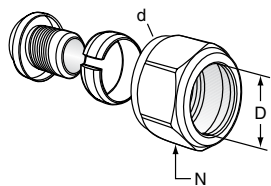
M22x1.5**Connection set FPL-PX****Non-plated (yellow)**

d	L ¹	For PEX-pipe D	N	EAN	Article No
M22x1,5	13	12x1,1	25	7318792946806	53 642-012
M22x1,5	13	12x1,7	25	7318793966704	53 643-212
M22x1,5	13	12x2,0	25	7318792947605	53 643-312
M22x1,5	14	14x2,0	25	7318792947704	53 643-314
M22x1,5	16	15x2,5	25	7318792947803	53 643-315
M22x1,5	14	16x1,5	25	7318792946905	53 642-016
M22x1,5	14	16x2,0	25	7318792947407	53 643-016
M22x1,5	14	16x2,2	25	7318792947902	53 643-316
M22x1,5	18	17x2,0	30	7318792948008	53 643-317
M22x1,5	23	18x2,5	30	7318793654601	53 643-018

Nickel plated

d	L ¹	For PEX-pipe D	N	EAN	Article No
M22x1,5	13	12x1,1	25	7318792947001	53 642-112
M22x1,5	13	12x1,7	25	7318793994509	53 643-112
M22x1,5	13	12x2,0	25	7318792948206	53 643-412
M22x1,5	14	14x2,0	25	7318792948305	53 643-414
M22x1,5	16	15x2,5	25	7318792948404	53 643-415
M22x1,5	14	16x1,5	25	7318792947100	53 642-116
M22x1,5	14	16x2,0	25	7318792947506	53 643-116
M22x1,5	14	16x2,2	25	7318792948503	53 643-416
M22x1,5	18	17x2,0	25	7318792948602	53 643-417
M22x1,5	23	18x2,5	25	7318792948701	53 643-418
M22x1,5	16	20x2,0	30	7318792948800	53 643-420
M22x1,5	16	20x2,3	30	7318792949005	53 643-520
M22x1,5	16	20x2,8	30	7318792949401	53 643-820

1) Over all length.

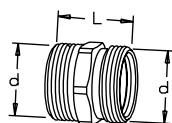
**TA 351 Coupling****Non-plated (yellow)**

d	L	EAN	Article No
M22x1,5	25	7318793630001	53 351-316

Nickel plated

d	L	EAN	Article No
M22x1,5	25	7318793630100	53 351-416

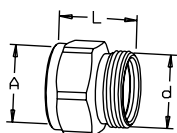

TA 356 Straight

Female

Non-plated (yellow)

d	L	EAN	Article No
G1/2xM22x1,5	26	7318793630506	53 356-415

Nickel plated

A x d	L	EAN	Article No
G3/8 x M22x1,5	21	7318793636508	53 356-411
G1/2 x M22x1,5	26	7318793636607	53 356-416

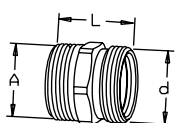

TA 358 Straight

Male

Non-plated (yellow)

A x d	L	EAN	Article No
R1/2 x M22x1,5	30	7318793630704	53 358-415

Nickel plated

A x d	L	EAN	Article No
R3/8 x M22x1,5	28	7318793637406	53 358-411
R1/2 x M22x1,5	30	7318793637505	53 358-416

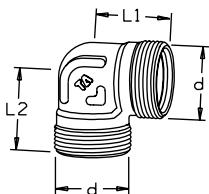

TA 361 Elbow

Non-plated (yellow)

d	L1	L2	EAN	Article No
M22x1,5	22	22	7318793630803	53 361-316

Nickel plated

d	L1	L2	EAN	Article No
M22x1,5	22	22	7318793630902	53 361-416

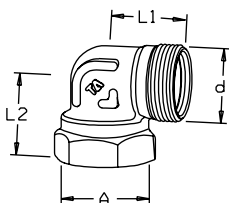

TA 363 Elbow

Female

Non-plated (yellow)

A x d	L1	L2	EAN	Article No
G1/2 x M22x1,5	22	24	7318793631503	53 363-415

Nickel plated

A x d	L1	L2	EAN	Article No
G1/2 x M22x1,5	22	24	7318793638205	53 363-416

R = Male conical thread.

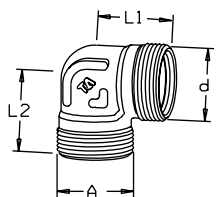

TA 354 Elbow

Male

Non-plated (yellow)

A x d	L1	L2	EAN	Article No
R1/2 x M22x1,5	22	24	7318793630308	53 354-415

Nickel plated

A x d	L1	L2	EAN	Article No
R1/2 x M22x1,5	22	24	7318793635600	53 354-416

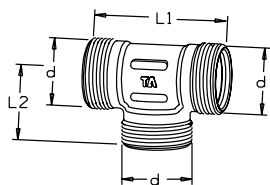

TA 352 Tee

Non-plated (yellow)

d	L1	L2	EAN	Article No
M22x1,5	43	22	7318793630209	53 352-316

Nickel plated

d	L1	L2	EAN	Article No
M22x1,5	43	22	7318793634900	53 352-416

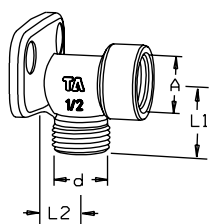

TA 368 Elbow with wall plate

Female

Chrome plated

A x d	L1	L2	EAN	Article No
G1/2 x M22x1,5	27	19	7318793632005	53 368-417

R = Male conical thread.

M28x1.5

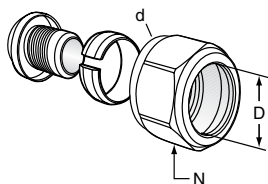

Connection set FPL-PX

Non-plated (yellow)

d	L ¹⁾	For PEX-pipe D	N	EAN	Article No
M28x1,5	13	15x2,5	32	7318792950407	53 644-615
M28x1,5	13	16x2,2	32	7318792949104	53 643-616
M28x1,5	13	18x2,5	32	7318792950506	53 644-618
M28x1,5	15	20x2,0	32	7318792950605	53 644-620
M28x1,5	16	20x2,3	32	7318792947308	53 642-620
M28x1,5	16	20x2,8	32	7318792949203	53 643-620
M28x1,5	16	22x3,0	32	7318792950704	53 644-622

1) Over all length.

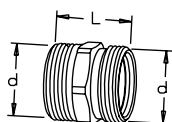

TA 351 Coupling

Non-plated (yellow)

d	L	EAN	Article No
M28x1,5	28	7318793712707	53 351-622

Chrome plated

d	L	EAN	Article No
M28x1,5	28	7318793717405	53 351-822

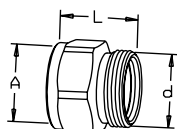

TA 356 Straight

Female

Non-plated (yellow)

A x d	L	EAN	Article No
G3/8 x M28x1,5	24	7318793734808	53 356-610
G1/2 x M28x1,5	27	7318793719409	53 356-615
G3/4 x M28x1,5	29	7318793719508	53 356-620

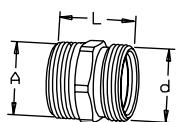

TA 358 Straight

Male

Non-plated (yellow)

A x d	L	EAN	Article No
R1/2 x M28x1,5	31	7318793720405	53 358-615
R3/4 x M28x1,5	32	7318793720504	53 358-620

Chrome plated

A x d	L	EAN	Article No
R1/2 x M28x1,5 *	31	7318793720603	53 358-715
R3/4 x M28x1,5	32	7318793720900	53 358-820

*) Nickel plated
R = Male conical thread.

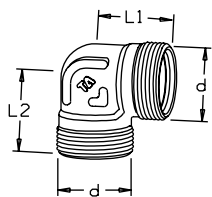

TA 361 Elbow
Non-plated (yellow)

d	L1	L2	EAN	Article No
M28x1,5	28	28	7318793721600	53 361-622

Chrome plated

d	L1	L2	EAN	Article No
M28x1,5	28	28	7318793722003	53 361-822

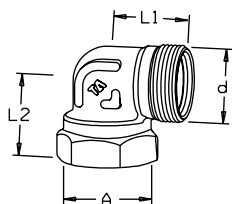

TA 363 Elbow
Female
Non-plated (yellow)

A x d	L1	L2	EAN	Article No
G1/2 x M28x1,5	30	30	7318793722409	53 363-615
G3/4 x M28x1,5	30	30	7318793722300	53 363-620

Chrome plated

A x d	L1	L2	EAN	Article No
G3/4 x M28x1,5	30	30	7318793722805	53 363-820

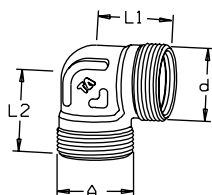

TA 354 Elbow
Male
Non-plated (yellow)

A x d	L1	L2	EAN	Article No
R1/2 x M28x1,5	30	30	7318793718709	53 354-615
R3/4 x M28x1,5	28	36	7318793970602	53 334-620

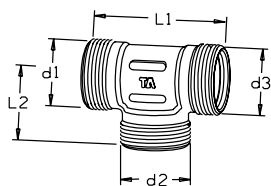

TA 352 Tee
Non-plated (yellow)

d1 x d2 x d3	L1	L2	EAN	Article No
M28x1,5	55	28	7318793717603	53 352-622
M28x1,5 x G1/2 x M28x1,5	60	30	7318793718402	53 352-601
M28x1,5 x G1/2 x G1/2	60	30	7318793718501	53 352-602

Chrome plated

d1 x d2 x d3	L1	L2	EAN	Article No
M28x1,5	55	28	7318793718105	53 352-822

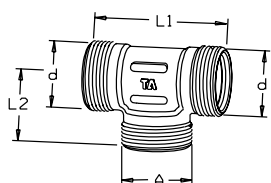

TA 352 Tee
Male
Non-plated (yellow)

d x A	L1	L2	EAN	Article No
M28x1,5 x R1/2	60	30	7318793718303	53 352-615

R = Male conical thread.

M34x1.5

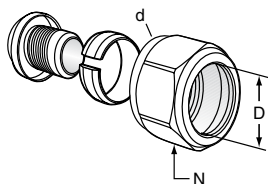

Connection set FPL-PX

Non-plated (yellow)

d	L ¹	For PEX-pipe D	N	EAN	Article No
M34x1,5	12	16x2,2	38	7318792950902	53 644-916
M34x1,5	14	18x2,5	38	7318792951008	53 644-918
M34x1,5	14	20x2,8	38	7318792951107	53 644-920
M34x1,5	13	22x3,0	38	7318792951206	53 644-922
M34x1,5	16	25x2,3	38	7318792950803	53 644-625
M34x1,5	16	25x3,5	38	7318792951305	53 644-925
M34x1,5	20	28x4,0	38	7318792951404	53 644-928

1) Over all length.

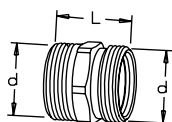

TA 351 Coupling

Non-plated (yellow)

d	L	EAN	Article No
M34x1,5	29	7318793712806	53 351-928

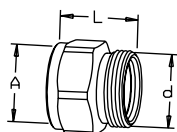

TA 356 Straight

Female

Non-plated (yellow)

A x d	L	EAN	Article No
G3/4 x M34x1,5	32	7318793720108	53 356-920
G1 x M34x1,5	34	7318793720306	53 356-925

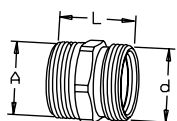

TA 358 Straight

Male

Non-plated (yellow)

A x d	L	EAN	Article No
R3/4 x M34x1,5	33	7318793721006	53 358-920
R1 x M34x1,5	36	7318793721105	53 358-925

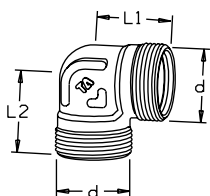

TA 361 Elbow

Non-plated (yellow)

d	L1	L2	EAN	Article No
M34x1,5	31	31	7318793721709	53 361-928

R = Male conical thread.

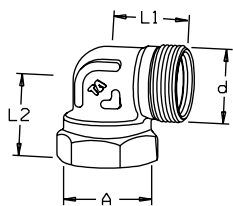

TA 363 Elbow
Female
Non-plated (yellow)

A x d	L1	L2	EAN	Article No
G1 x M34x1,5	33	33	7318793722508	53 363-925

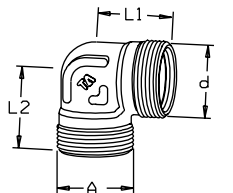

TA 354 Elbow
Male
Non-plated (yellow)

A x d	L1	L2	EAN	Article No
G3/4 x M34x1,5 ⁴	31	32	7318793719300	53 354-920
R1 x M34x1,5	31	33	7318793970800	53 334-925

4) Short thread

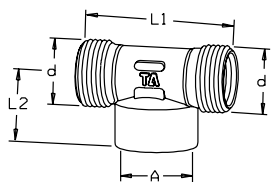

TA 362 Tee
Female
Non-plated (yellow)

A x d	L1	L2	EAN	Article No
M34x1,5 x G3/4	70	35	7318793722201	53 362-920

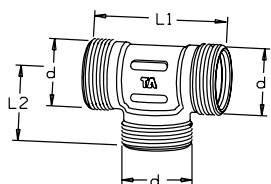

TA 352 Tee
Non-plated (yellow)

d	L1	L2	EAN	Article No
M34x1,5	61	31	7318793717801	53 352-928

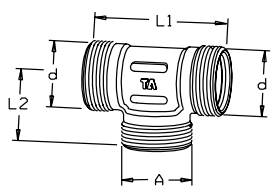

TA 352 Tee
Male
Non-plated (yellow)

d x A	L1	L2	EAN	Article No
M34x1,5 x G3/4 ⁴	70	35	7318793736703	53 352-920

4) Short thread

R = Male conical thread.

M42x2.0

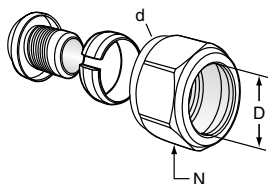

Connection set FPL-PX

Non-plated (yellow)

d	L ¹	For PEX-pipe D	N	EAN	Article No
M42x2,0	14	22x3,0	47	7318792949500	53 643-922
M42x2,0	16	25x2,3	47	7318792949302	53 643-625
M42x2,0	16	25x3,5	47	7318792949609	53 643-925
M42x2,0	14	28x4,0	47	7318792949708	53 643-928
M42x2,0	17	32x2,9/3,0	47	7318792949807	53 643-932
M42x2,0	17	32x4,4	47	7318792951503	53 644-932

1) Over all length.

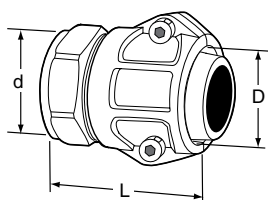

Connection coupling FPL-PX

With swivelling nut

Non-plated (yellow)

d	L ¹	For PEX-pipe D	EAN	Article No
M42x2,0	65	40x3,7	7318792913600	53 500-040
M42x2,0	65	40x5,5	7318792913907	53 500-340

1) Over all length.

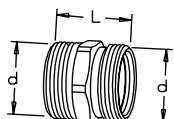

TA 351 Coupling

Non-plated (yellow)

d	L	EAN	Article No
M42x2,0	36	7318793712905	53 351-035

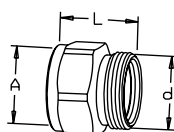

TA 356 Straight

Female

Non-plated (yellow)

A x d	L	EAN	Article No
G1 x M42x2,0	38	7318793734402	53 356-025
G1 1/4 x M42x2,0	39	7318793734501	53 356-032

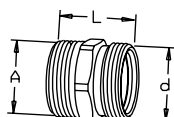

TA 358 Straight

Male

Non-plated (yellow)

A x d	L	EAN	Article No
R3/4 x M42x2,0	38	7318793735508	53 358-020
R1 x M42x2,0	40	7318793735607	53 358-025
R1 1/4 x M42x2,0	42	7318793735706	53 358-032

R = Male conical thread.

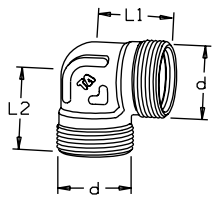

TA 361 Elbow
Non-plated (yellow)

d	L1	L2	EAN	Article No
M42x2,0	44	44	7318793736307	53 361-035

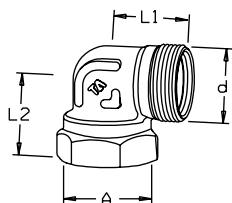

TA 363 Elbow
Female
Non-plated (yellow)

A x d	L1	L2	EAN	Article No
G1 1/4 x M42x2,0	44	44	7318793737007	53 363-032

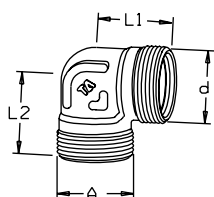

TA 354 Elbow
Male
Non-plated (yellow)

A x d	L1	L2	EAN	Article No
R1 1/4 x M42x2,0	44	44	7318793733702	53 354-032

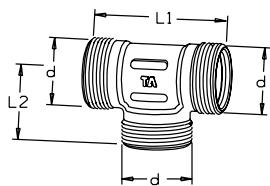

TA 352 Tee
Non-plated (yellow)

d	L1	L2	EAN	Article No
M42x2,0	88	44	7318793732804	53 352-035

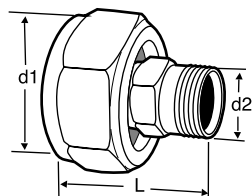

Reducer
With swivelling nut
Non-plated (yellow)

d1	d2	L	EAN	Article No
M42x2,0	M28x1,5	53	7318792921605	53 566-005

R = Male conical thread.

M50x2.0

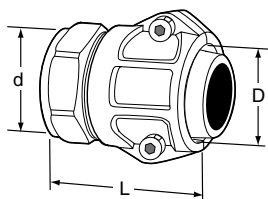

Connection coupling FPL-PX

With swivelling nut

Non-plated (yellow)

d	L ¹	For PEX-pipe D	EAN	Article No
M50x2,0	67	50x4,6	7318792913709	53 500-050
M50x2,0	67	50x6,9	7318792914003	53 500-350

1) Over all length.

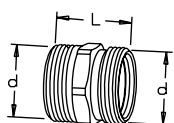

TA 351 Coupling

Non-plated (yellow)

d	L	EAN	Article No
M50x2,0	40	7318793713001	53 351-042

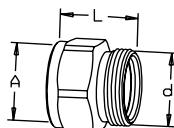

TA 356 Straight

Female

Non-plated (yellow)

A x d	L	EAN	Article No
G1 1/2 x M50x2,0	41	7318793734600	53 356-040

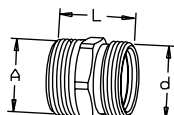

TA 358 Straight

Male

Non-plated (yellow)

A x d	L	EAN	Article No
R1 1/4 x M50x2,0	45	7318793735805	53 358-132
R1 1/2 x M50x2,0	45	7318793735904	53 358-040

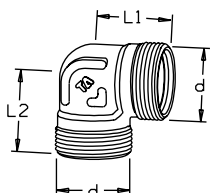

TA 361 Elbow

Non-plated (yellow)

d	L1	L2	EAN	Article No
M50x2,0	50	50	7318793736406	53 361-042

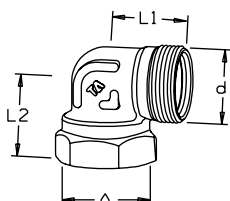

TA 363 Elbow

Female

Non-plated (yellow)

A x d	L1	L2	EAN	Article No
G1 1/2 x M50x2,0	50	50	7318793737106	53 363-040

R = Male conical thread.

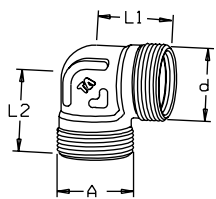

TA 354 Elbow

Male

Non-plated (yellow)

A x d	L1	L2	EAN	Article No
R1 1/2 x M50x2,0	50	50	7318793733603	53 354-040

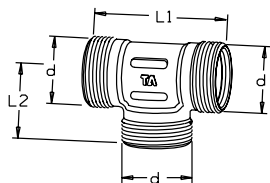

TA 352 Tee

Non-plated (yellow)

d	L1	L2	EAN	Article No
M50x2,0	100	50	7318793732903	53 352-042

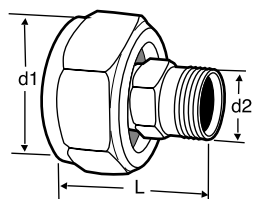

Reducer

With swivelling nut

Non-plated (yellow)

d1	d2	L	EAN	Article No
M50x2,0	M42x2,0	36	7318792921407	53 566-003

R = Male conical thread.

M65x2.0

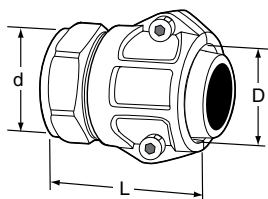

Connection coupling FPL-PX

With swivelling nut

Non-plated (yellow)

d	L ¹	For PEX-pipe D	EAN	Article No
M65x2,0	67	63x5,8	7318792913808	53 500-063
M65x2,0	67	63x8,7	7318792914102	53 500-363

1) Over all length.

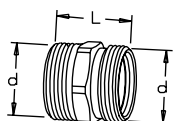

TA 351 Coupling

Non-plated (yellow)

d	L	EAN	Article No
M65x2,0	48	7318793713100	53 351-054

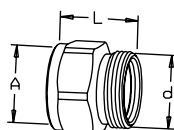

TA 356 Straight

Female

Non-plated (yellow)

A x d	L	EAN	Article No
G2 x M65x2,0	49	7318793734709	53 356-050

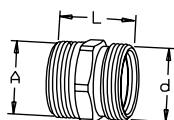

TA 358 Straight

Male

Non-plated (yellow)

A x d	L	EAN	Article No
R2 x M65x2,0	53	7318793736000	53 358-050

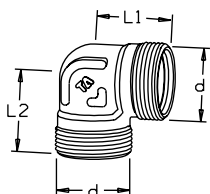

TA 361 Elbow

Non-plated (yellow)

d	L1	L2	EAN	Article No
M65x2,0	62	62	7318793736604	53 361-054

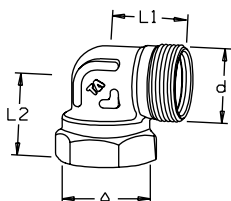

TA 363 Elbow

Female

Non-plated (yellow)

A x d	L1	L2	EAN	Article No
G2 x M65x2,0	62	62	7318793737205	53 363-050

R = Male conical thread.

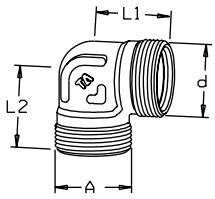

TA 354 Elbow

Male

Non-plated (yellow)

A x d	L1	L2	EAN	Article No
R2 x M65x2,0	62	62	7318793733801	53 354-050

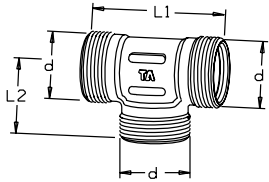

TA 352 Tee

Non-plated (yellow)

d	L1	L2	EAN	Article No
M65x2,0	124	62	7318793733009	53 352-054

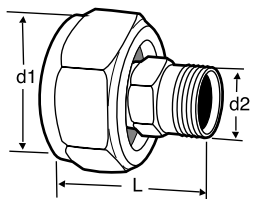

Reducer

With swivelling nut

Non-plated (yellow)

d1	d2	L	EAN	Article No
M65x2,0	M50x2,0	37	7318792921506	53 566-004

R = Male conical thread.

Distributors

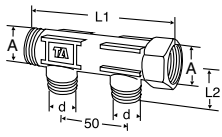

TA 56 042, 2-way distributor

With swivelling nut

Non-plated (yellow)

d	A	L1 ¹⁾	L2 ¹⁾	EAN	Article No
G1/2	G3/4	100	50	7318793259202	56 042-001

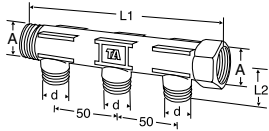

TA 56 043, 3-way distributor

With swivelling nut

Non-plated (yellow)

d	A	L1 ¹⁾	L2 ¹⁾	EAN	Article No
G1/2	G3/4	150	50	7318793259400	56 043-001

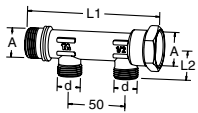

TA 56 032, 2-way distributor

Non-plated (yellow)

d	A	L1 ¹⁾	L2 ¹⁾	EAN	Article No
G1/2	G3/4	117	27	7318793677303	56 032-001

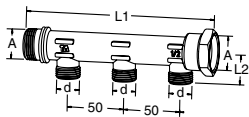

TA 56 033, 3-way distributor

Non-plated (yellow)

d	A	L1 ¹⁾	L2 ¹⁾	EAN	Article No
G1/2	G3/4	167	27	7318793677808	56 033-001

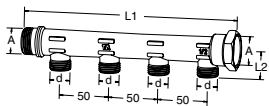

TA 56 034, 4-way distributor

Non-plated (yellow)

d	A	L1 ¹⁾	L2 ¹⁾	EAN	Article No
G1/2	G3/4	217	27	7318793678300	56 034-001

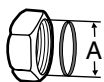

TA 56 000 Cap

Incl. flat gasket for the distributor

Non-plated (yellow)

A	EAN	Article No
G3/4	7318793255204	56 000-020

1) Over all length L refers to unassembled coupling.

Transition nipples

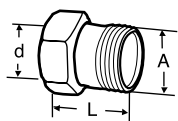

TA 339 Transition nipple

Male, with swivelling nut

Non-plated (yellow)

dxA	L ¹	EAN	Article No
M28x1,5 x R1/2 **	35	7318793706508	53 339-715
M28x1,5 x R3/4	37	7318793706409	53 339-620

**) Nickel plated

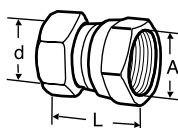

TA 348 Transition nipple

Female, with swivelling nut

Non-plated (yellow)

dxA	L ¹	EAN	Article No
M34x1,5 x G3/4	30	7318793707307	53 348-620
M34x1,5 x G1	42	7318793707406	53 348-625
M42x2,0 x G1	35	7318793707505	53 348-925
M42x2,0 x G1 1/4	49	7318793707604	53 348-932

Nickel plated

dxA	L ¹	EAN	Article No
M28x1,5 x G1/2	30	7318793707109	53 348-415
M28x1,5 x G3/4	32	7318793707208	53 348-420

R = Male conical thread.

1) Over all length L refers to unassembled coupling.

