

TA-R25

High performance proportional actuator



TA

Pressurisation & Water Quality › Balancing & Control › Thermostatic Control

ENGINEERING ADVANTAGE

Electromotor actuator which, when used together with pressure independent control valves KTM 512 DN 15-50, provides superb control. High IP class for reliable operation.

➤ **Manual operation**

Gears can be de-coupled in order to position the valve manually.

➤ **Manual setting**

Manual operation by using 6 mm Allen key.

➤ **Simple click-on connection**

For easy installation on the valve.



➤ Technical description

Applications:

TA-R25-24: For modulating, 3-point or on/off control.

TA-R25-F24: For fast control of tap hot water circuits or like wise.

TA-R25-230: For 3-point or on/off control.

Supply voltage:

TA-R25-24/-F24: 24V AC/DC $\pm 20\%$

TA-R25-230: 230V AC $\pm 15\%$

Frequency 50-60 Hz

Power consumption:

TA-R25-24/-F24: 5 W

TA-R25-230: 2 W

Control voltage:

TA-R25-24/-F24: DC 0-10 V, 3-point or 2-point (on/off).

TA-R25-230: 3-point or 2-point (on/off).

Control speed:

TA-R25-24: 8 or 16 s/mm

TA-R25-F24: 2,5 or 4 s/mm

TA-R25-230: 16 s/mm

Adjusting force:

TA-R25-24: 500 N

TA-R25-F24: 125 N

TA-R25-230: 500 N

Temperature:

Max. ambient temperature: 55°C

Min. ambient temperature: -10°C

Enclosure class:

IP 54 (EN 60529)

Cable:

TA-R25-24/-F24: Connection cable 5 x 0,5 mm².

TA-R25-230: Connection cable 3 x 0,5 mm².

Cable length: 1,2 m.

Stroke:

10 mm

Connection to valve:

Plastic bracket with brass nut for connection to the valve and automatic spindle connection. For connection to KTH or KTM 512 an adapter is needed.

Colour:

Black body and red cover.

Marking:

TA, Article No, Product name and Technical specification.

Operating function

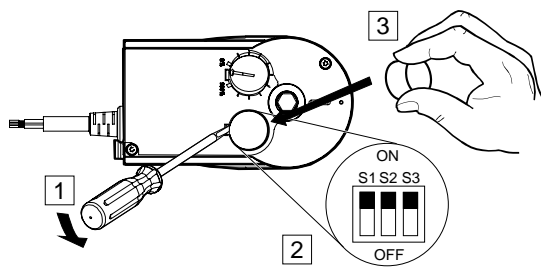

TA-R25-24 10 mm, 500 N

	S1	S2	S3
160 s	-	on	-
80 s	-	off	-
	-	-	on = lin.
	-	-	off = EQM
	on	on	on

TA-R25-F24 10 mm, 125 N

	S1	S2	S3
40 s	on	-	-
24 s	off	-	-
	-	on	on
Inv = %	-	off	on
	-	off	off
X ²	-	on	off
	on	on	on

TA-R25-24/-F24

Depending on how it is connected (see wiring diagrams), the actuators can be used as a modulating 0-10 V, as a 2-point (open/close) or as a 3-point drive (open/stop/close).

The running time can be matched to requirements using switch S2. The characteristic (equal-percentage or linear) can be selected via switch S3.

For manual adjustment disengage the gears (press sliding switch next to the power cable). Insert an Allen key into the hole on the actuator cover. Turn clockwise to close the valve and vice versa. A full stroke (10 mm) can be attained with 2 turns.

The motor will stop independent of the control signal.

TA-R25-230

Depending on how it is connected (see wiring diagrams), the actuators can be used as a 2-point (open/close) or as a 3-point drive (open/stop/close). The speed and the characteristic of the actuator can not be adjusted.

For manual adjustment disengage the gears (press sliding switch next to the power cable). Insert an Allen key into the hole on the actuator cover. Turn clockwise to close the valve and vice versa. A full stroke (10 mm) can be attained with 2 turns.

The motor will stop independent of the control signal.

Installation

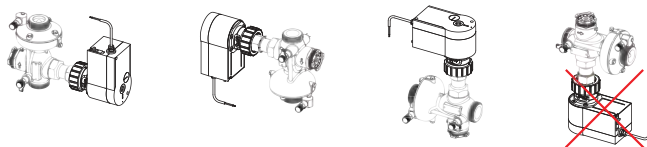

Wiring diagram:

24 V, 0-10 V

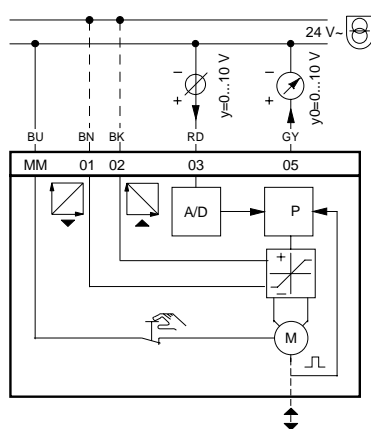

Variant 1 (3pt)

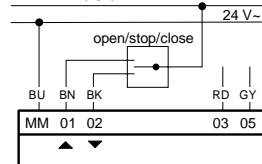

Variant 2 (2pt = on-off)

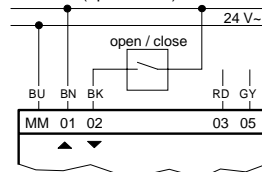

230 V

2-Pt.

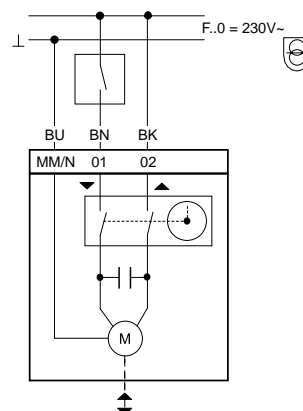

3-Pt.

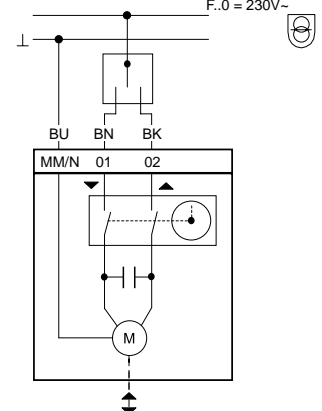

- RD = Red
- BN = Brown
- BK = Black
- BU = Blue
- GY = Grey

Articles

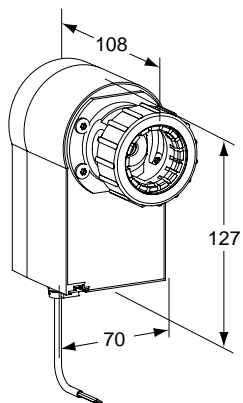

Article No	Cable length	Kg
TA-R25-24, 24 V AC/DC		
44 756-975	1,2 m	0,7
TA-R25-F24, 24 V AC/DC		
44 756-977	1,2 m	0,7
TA-R25-230, 230 V AC		
44 756-976	1,2 m	0,7

Adapter

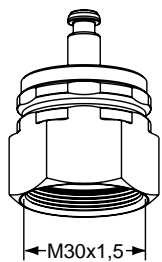

Adapter TA-R25 – KTH/KTM 512
(DN 15-50)

Article No	EAN
52 757-031	

The products, texts, photographs, graphics and diagrams in this document may be subject to alteration by TA Hydraulics without prior notice or reasons being given.

For the most up to date information about our products and specifications, please visit www.tahydraulics.com.

6-10-28 TA-R25 03.2011

**Stellantrieb
Servomoteur
Actuator
Servomotore
Servomotor
Ställdon
Servomotor**

**Montagevorschrift
Instructions de montage
Fitting instructions
Istruzioni di montaggio
Instrucciones de montaje
Monteringsanvisning
Montagevoorschrift**



Installationsanweisung für die Fachkraft/ Monteur
Conseils d'installation pour le spécialiste/ monteur
Guidelines for the technician/ fitter
Informazioni per il personale specializzato di montaggio
Instrucciones para el especialista del ramo/ montador
Installationsinstruktion für installatör/ montör
Installatietip voor de vakman/ monteur

Für den Einsatz in üblicher Umgebung
Pour usage dans un environnement normal
For use in normal environments
Per impiego in ambiente usuale
Para el uso en ambiente normal
För användning i normal miljö
Voor toepassing in normale omgeving

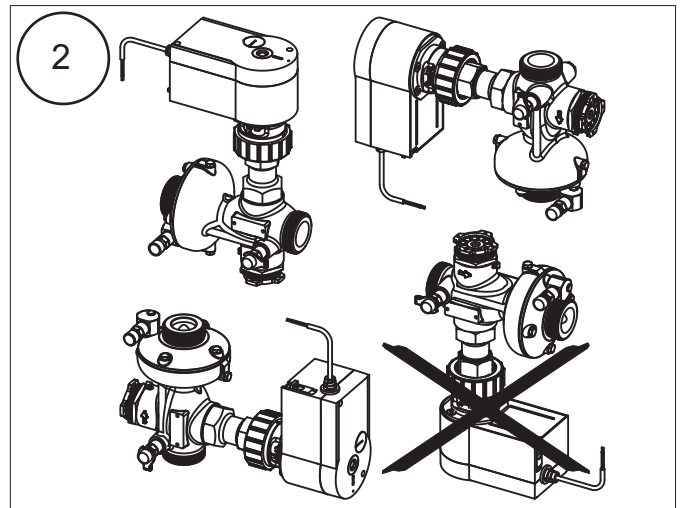
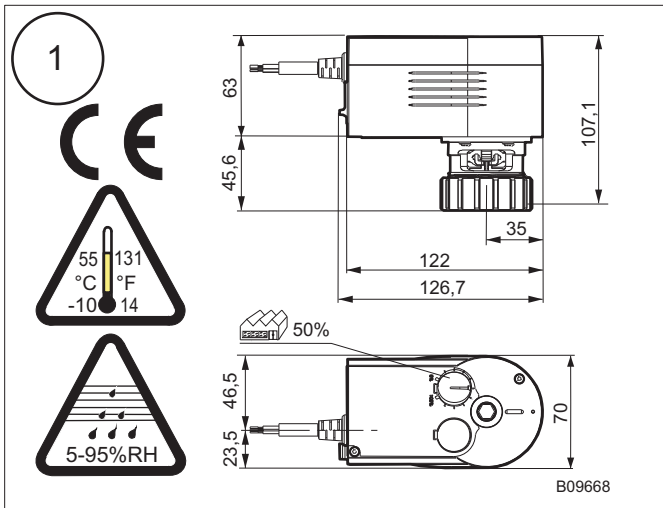

Installationsanweisung für die Elektrofachkraft
Notice d'installation pour l'électricien
Guidelines for the electrician
Informazioni per l'installatore elettrico
Instrucciones de instalación para el electricista
Installationsinstruktion för behörig elektriker
Instalatie aanwijzing voor de elektromonteur

Einsatz bei defektem Kabel verboten
Usage interdit avec câble défectueux
Do not use if the cable is defective
Impiego vietato nel caso di cavo danneggiato
Está prohibido el uso con un cable defectuoso
Förbjuden att använda vid skadad kabel
Gebruik bij defecte kabel verboden

Verschmutzungsgrad II, Überspannungskategorie III, nach EN 60730
Degré de pollution II, catégorie surtension III, selon EN 60730
Pollution degree II, over voltage category III, as per EN 60730
Grado di insudiciamento II, categoria di sovratensione III, a norme EN 60730
Grado de suciedad II, Categoría de altatensión III, según EN 60730
Grad av nedsmutsningsgrad II, Överspanningskategori III, enligt EN 60730
Vervuilinggraad II, Overspanningscategorie III, volgens EN 60730

8...10Nm

Darf nicht isoliert werden
Ne pas isoler
Do not insulate
Non deve venire isolato
No debe ser aislado
Får ej isoleras
Mag niet worden geïsoleerd

4 startup

2 man $\odot 6 / < 5 \text{ Nm}$

1 man click

4 click

5 click

1 auto

3 auto / man

2 auto / man

5

$\odot 6 / < 5 \text{ Nm}$

1 click

2 click

3 click

6a

TA-R25-230

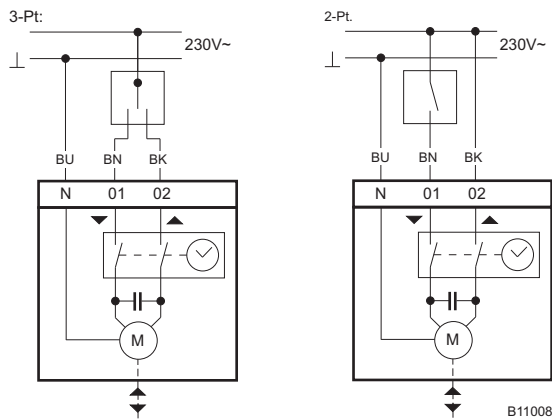

B11008

6b

TA-R25-24

Software A EN60730	Type 1AB EN60730	IP54 EN60529
---------------------------------	-------------------------------	-----------------

BU	BN	BK	RD	GY
blau	braun	schwarz	rot	grau
bleu	brun	noir	rouge	gris
blue	brown	black	red	grey
azzurro	marrón	nero	rosso	grigio
azul	brun	negro	rojo	gris
blå	bruin	svart	röd	grå
blauw	bruin	zwart	rood	grijs

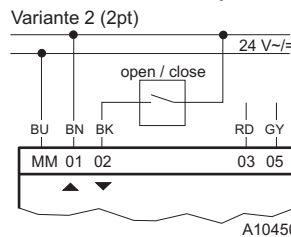
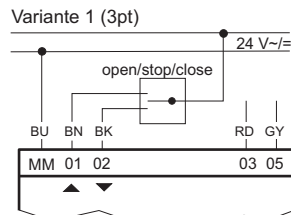
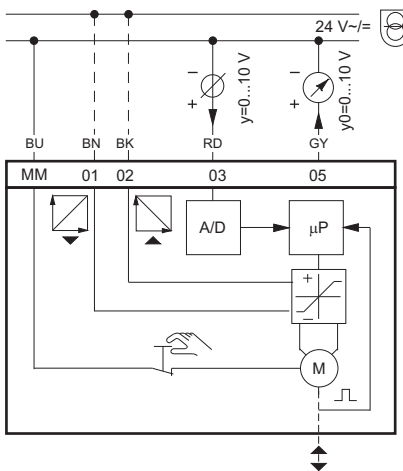

A10450

6c

TA-R25-24

Schalterkodierung Codage de commutation Switch coding Codifica di intervento Codificación de conmutación Kodomkopplare Schakelcodering	Laufzeit für 10 mm Hub Temps de marche pour une course de 10 mm Running time for 10 mm of stroke Codifica di intervento Tempo di marcia per corsa 10 mm Tiempo de funcionamiento para carrera de 10 mm Gångtid pr. 10 mm slaglängd Looptijd voor 10 mm slag																								
<table border="0"> <tr> <td>1</td><td>2</td><td>3</td><td></td></tr> <tr> <td>█</td><td>█</td><td></td><td>On</td></tr> <tr> <td></td><td></td><td></td><td>Off</td></tr> </table> <table border="0"> <tr> <td>1</td><td>2</td><td>3</td><td></td></tr> <tr> <td>█</td><td></td><td></td><td>On</td></tr> <tr> <td></td><td>█</td><td></td><td>Off</td></tr> </table>	1	2	3		█	█		On				Off	1	2	3		█			On		█		Off	80 s ± 6
1	2	3																							
█	█		On																						
			Off																						
1	2	3																							
█			On																						
	█		Off																						
<table border="0"> <tr> <td>1</td><td>2</td><td>3</td><td></td></tr> <tr> <td>█</td><td>█</td><td></td><td>On</td></tr> <tr> <td></td><td></td><td></td><td>Off</td></tr> </table> <table border="0"> <tr> <td>1</td><td>2</td><td>3</td><td></td></tr> <tr> <td>█</td><td></td><td></td><td>On</td></tr> <tr> <td></td><td>█</td><td></td><td>Off</td></tr> </table>	1	2	3		█	█		On				Off	1	2	3		█			On		█		Off	160 s ± 12
1	2	3																							
█	█		On																						
			Off																						
1	2	3																							
█			On																						
	█		Off																						

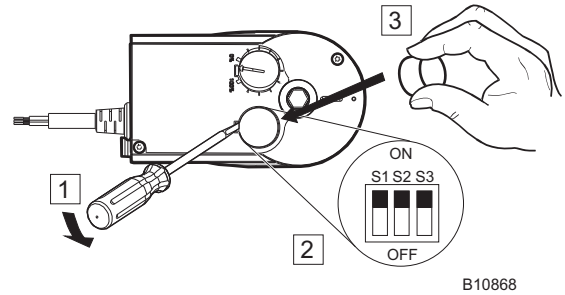

<table border="0"> <tr> <td>1</td><td>2</td><td>3</td><td></td></tr> <tr> <td></td><td></td><td>█</td><td>On</td></tr> <tr> <td></td><td></td><td></td><td>Off</td></tr> </table>	1	2	3				█	On				Off			
1	2	3													
		█	On												
			Off												
<table border="0"> <tr> <td>1</td><td>2</td><td>3</td><td></td></tr> <tr> <td></td><td></td><td>█</td><td>On</td></tr> <tr> <td></td><td></td><td></td><td>Off</td></tr> </table>	1	2	3				█	On				Off			
1	2	3													
		█	On												
			Off												

dismounting

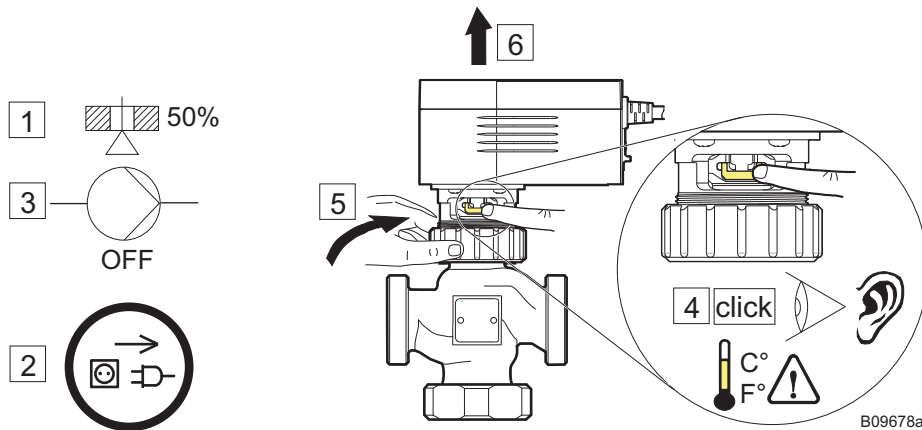

Dokument aufbewahren/Ce document est à conserver/Retain this document/Conservare il documento/Guardar el documento/
 Spara dokumentationen/Document bewaren